

PRODUCT CATALOGUE 2022



BelAire[®]
DESIGNER FENCING

...make it your own!

- SOLID PANEL FENCING 
- COMMERCIAL ACOUSTIC WALLS 
- FRAMELESS GLASS FENCING & BALUSTRADES 
- ALUMINIUM FENCING & SCREEN SYSTEMS 
- GATES 

Who we are

BelAire is a brand of Storetech Industries.
Storetech Industries is a family owned business
that has been operating since 1974.

Core Values

Internal

Passion - Attention To Detail
Trust - Team Players

External

Greater Customer Experience - Trust
Loyalty - Effort - Excellence

Our Mission

To make sure New Zealanders can be confident that their outdoor equipment and personal environment is secure and protected by offering New Zealand's widest range of simple, modular fencing solutions while adhering to our core values.



Ben Carney - Owner/Director



Peter Carney - Owner/Director

BelAire[®]
DESIGNER FENCING

CONTENTS

Solid Panel Fencing

- Introduction
- Classic Solid Panel Fencing
- Signature Solid Panel Fencing
- Estate Solid Panel Fencing
- Solid Panels
- Slat Infill Panels
- Louvre Infill Panels
- Tubular Infill Panels
- Glass Infill Panels



Commercial Acoustic Barriers

- Introduction
- Acoustic Field Test Report
- Acoustic Barrier Posts & Panels
- Barriers up to 3.0m high
- Barriers 3.1m – 5.1m high



Frameless Glass Fencing and Balustrade

- Introduction
- Frameless Glass Pool Fencing Panels
- Frameless Glass Balustrade Panels
- Frameless Glass Gate & Hinge Panels
- Friction Spigot Range
- Gate Hardware: Latches & Hinges
- Clamps & Handrails



Aluminium Fencing and Screen Systems

- Introduction
- Slat Fencing
- Louvre Fencing



Gates

- Introduction
- Slat Gates
- Eco Slat Gate Kits
- Louvre Gates
- Solid Panel Gates
- Tubular Gates
- Sliding Gates
- Hinged Gates





SOLID PANEL FENCING



BelAire[®]
DESIGNER FENCING

...make it your own!



SOLID ACOUSTIC PANEL FENCING

In today's world, noise reduction is one of the leading concerns across New Zealand home owners. The BelAire range of acoustic fences and noise barriers have been specifically engineered to meet the acoustic demands of our modern world.

We handle a variety of noise reduction concerns; from general neighbourhood noise, to road noise, to high-performance noise absorption enclosures for pool pumps and HVAC units. On average, our acoustic fences and road noise barriers typically achieve a 20-30dB reduction (depending on noise source and noise type), which equates to a quartering of loudness.

Understanding 'loudness', or the human perception of sound, can be tricky; but you can test just how much different this makes with the simple help of a video and its volume controls. First, watch the video at 100% volume. Then, reduce the volume to 25%; this is the potential noise reduction that our acoustic fences offer.

Put the controls back into your hands; turn down the volume of loud neighbours and traffic noise today.

ACOUSTIC FENCING

BelAire solid wall systems are acoustically tested and rated, keeping all unwanted surrounding noises at bay and providing peace and quiet for your home.

ECO FRIENDLY

Our innovative products are made of recyclable materials, with our manufacturing processes reducing emitted and embodied CO2 by up to 80%.

NZ MADE

All BelAire Walls products are NZ designed and manufactured to strict international quality standards.

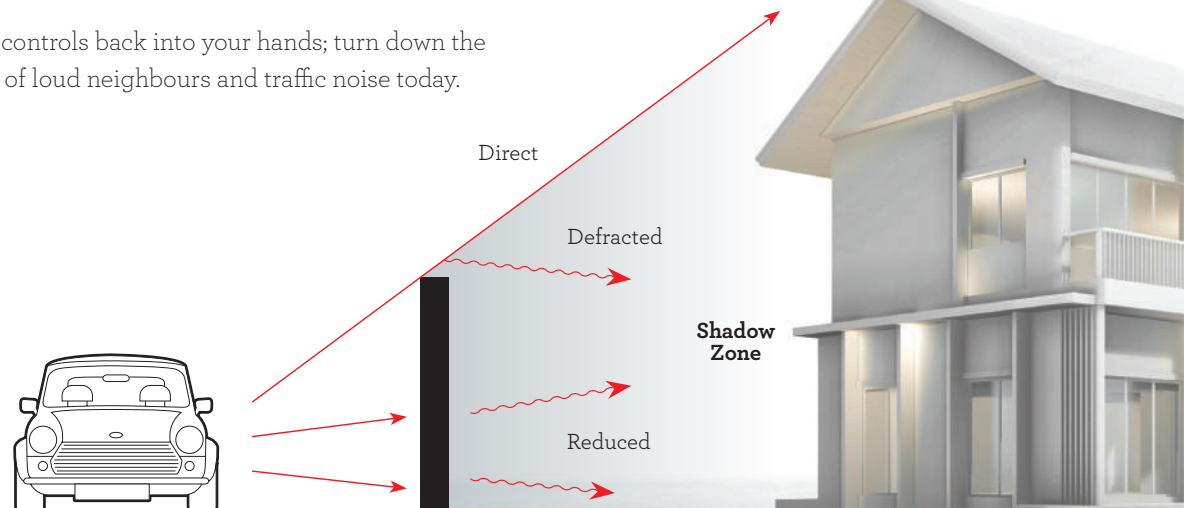



BelAire®
DESIGNER FENCING

...make it your own!

SOLID PANEL FENCING

MODULAR SYSTEM

BelAire solid panel fencing is the most advanced modular fencing system available in New Zealand today.

DESIGNED BY YOU

With the Classic, Signature and Estate styles to choose from, you can design your fence to suit your lifestyle. Our fences and posts are all fully paintable so that you can complement or match the colour of your property.

You can also add stylish slat, louvre, tubular or glass infills, plus there is a choice of post and capping – the options for your fence are only limited by your imagination.

COST-EFFECTIVE

BelAire solid panel fencing has all the properties of a block wall at a fraction of the cost and mess! Once coated, BelAire fencing will look just as good as a block wall.

BUILT TO LAST

Our pre-primed, galvanized, high-tensile support posts are very light yet structurally very strong. Our EPS/fibre cement panels are designed to withstand the typical demands placed on a fence in any environment.

EASY (DIY) INSTALLATION

Our fences are designed to be assembled with ease. There is no need for heavy construction and digging equipment, or cranes – BelAire panels can be easily handled by two people. They are easy to install in difficult-to-access areas such as back yards or annexed ground.

We provide step by step self-install instructions that any competent DIY person should be able to follow, but if you'd rather get someone else to install it, we have a list of preferred installers throughout NZ. Call us on 0800 235 2473 and we will put you in touch with an installer in your area.

WARRANTY

New Zealand-made and 10 year warranty information. Be assured that with very little maintenance your fence will give you great privacy and security for many years to come. Only the finest raw materials have been used in the construction of your fence. The suppliers of these raw materials state that they have a design life well in excess of 20 years. With this assurance we offer you a replacement warranty for any component of your new fencing if it fails within 10 years* from date of purchase.



*2yr Warranty within a 1500m sea spray zone.

Karaka Pines Retirement Village

Karaka Pines Retirement Village in Rototuna, Hamilton, asked for an aesthetically pleasing boundary fence with noise reduction and privacy benefits.

Project Specifications:

Estate Wall

314m x 1.8m high

Exposed Capping, Solid/Slat Bays

900mm high with 900mm high of vertical 85mm slats with 33mm gaps

Colour

Painted double concrete, slats powder coated grey friars

Client: Karaka Pines Group Limited

Architect: Boffa Miskell

Landscaper: Evergreen Landcare LTD

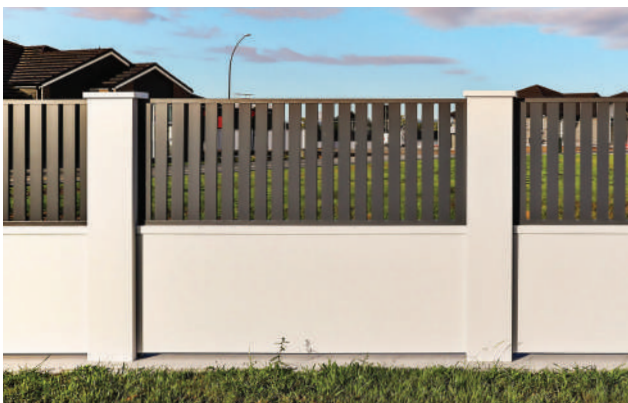

One88 On Commerce

One88 on Commerce motel needed a noise barrier wall that looked great, as it is on a corner of a busy street. BelAire outfitted the motel with an acoustic barrier to separated them from the street and small wing units between the motel rooms to create privacy and provide shade.

Project Specifications:

Client: One88 On Commerce

Signature Wall/ Slat Infill for small wings

2100mm and 1800mm high

Exposed Capping, Solid/Slat Bays

230m

Colour

Clay



EXPOSED JOIN OR CLOSED JOIN ?

An exposed join is recommended – it is more forgiving if you haven't quite got the panels 100% level, and also gives a much more attractive result.

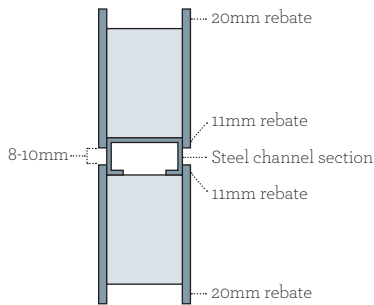

<< How to achieve a exposed join

Insert the steel channel section into the 11mm rebate in the panels

How to achieve a standard join >>

Insert the steel channel section into the 20mm rebate in the panels

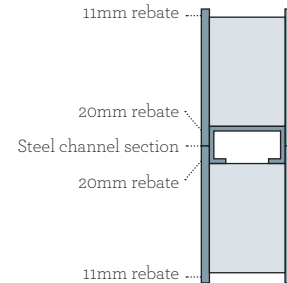

NOISE BARRIER

Our patented solid Poly-Fibre Cement composite sandwich panels are designed to reflect noise. The acoustic performance of this product was evaluated by the Acoustics Research Group at the University of Canterbury and a comprehensive report is available on request.

TYPICAL TRAFFIC NOISE – 12m from road edge

approx. 60 dBa: 2-lane urban road, 6,000 vehicles per day @ 50kph
approx. 68 dBa: 4-lane motorway, 25,000 vehicles per day @ 100kph

TYPICAL OTHER NOISE

approx. 90 dBa: Lawnmower
approx. 100 dBa: Circular saw

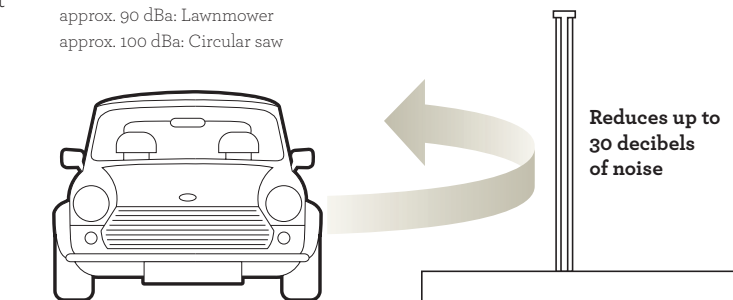

THE ALL-TERRAIN FENCE

BelAire solid panels can be easily cut using a circular saw with a timber blade. This will allow you to easily and neatly follow the terrain of your property.



CLASSIC

Post dimensions: 120mm (deep) x 180mm (face) 0.95 mm BMT

Panel thickness: 50mm

Density of composite panel materials: 15.49kg/m²

Suitable for fence heights: 900mm - 2400mm

Post centres: 2530mm, 2830mm, 3130mm

The classic fence is the most cost effective of the styles and most commonly used in residential boundary/screening fence applications. Suitable for less challenging terrain, this style of fence will provide great sound reduction qualities. Also suited to lower fence designs - 1200mm and 1500mm high.

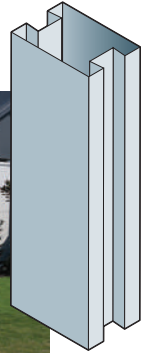

SIGNATURE

Post dimensions: 140mm (deep) x 280mm (face) 0.95 mm BMT

Panel thickness: 70mm

Density of composite panel materials: 15.49kg/m²

Suitable for fence heights: 900mm - 3000mm

Post centres: 2630mm, 2930mm, 3230mm

The Signature fence, our most popular line, is most commonly used where a true masonry wall look is desired, or in a commercial and residential security/sound fence application. The fence has superb sound reduction qualities (National Acoustic Laboratory tested).

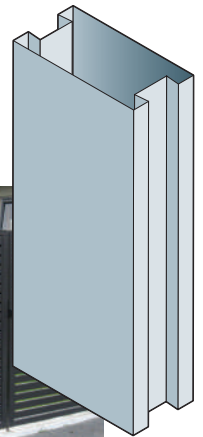

ESTATE

Post dimensions: 210mm (deep) x 320mm (face) 0.95 mm BMT

Panel thickness: 70mm

Density of composite panel materials: 15.49kg/m²

Suitable for fence heights: 900mm - 3000mm

Post centres: 2670mm, 2970mm, 3270mm

The Estate fence is most commonly used where a 'Grand' masonry wall look is desired. The post face is equivalent to a brick and a half in width, and the fence has superb sound reduction qualities (National Acoustic Laboratory tested).

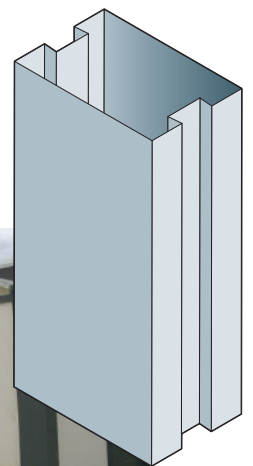

CLASSIC

SPECIFICATIONS

Centre to centre guide

Panel length	Post hole centres
2400mm	> 2530mm
2700mm	> 2830mm
3000mm	> 3130mm

Post hole depth guide Wind Regions A&B

Hole depth into firm earth or clay	Fence height	Hole depth into sand, soft clay or loose earth
450mm	> 900mm	> 550mm
550mm	> 1200mm	> 650mm
600mm	> 1500mm	> 700mm
650mm	> 1800mm	> 800mm
700mm	> 2100mm	> 900mm

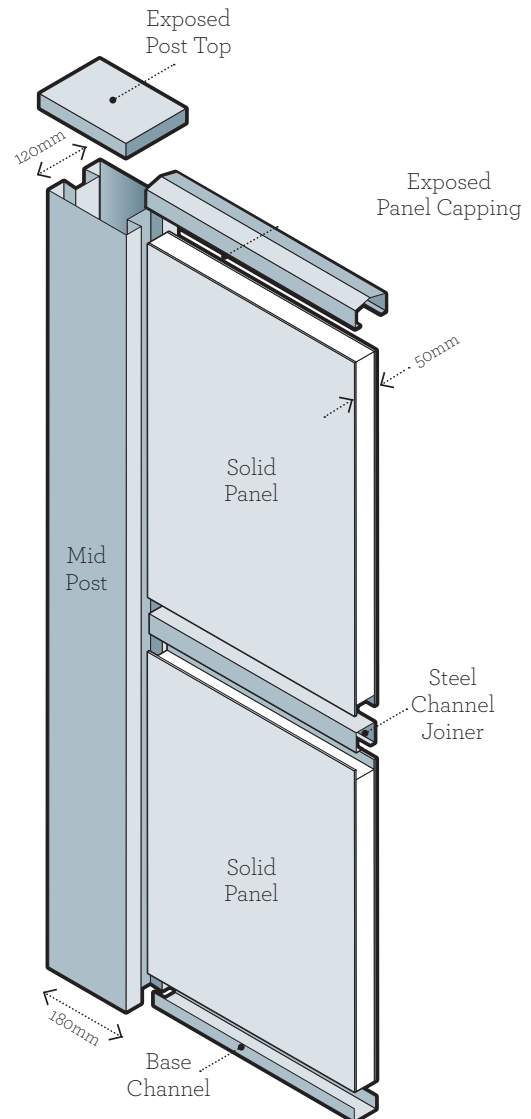
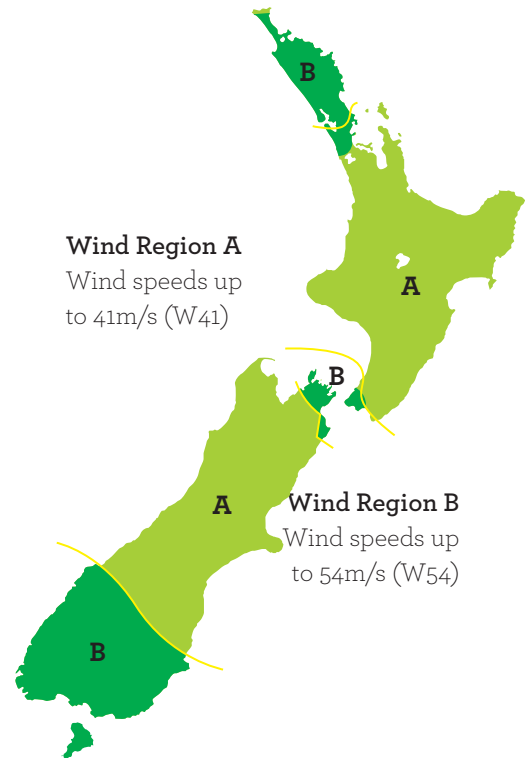

Post hole width: 280mm min (all wind regions)

Soil (including garden fill) should not be placed in contact with the steel post

Top of concrete should be sloped away from post for water drainage

Grade of concrete N20 with maximum size of aggregate 20mm. Concrete shall be compacted after placement inside footing hole.

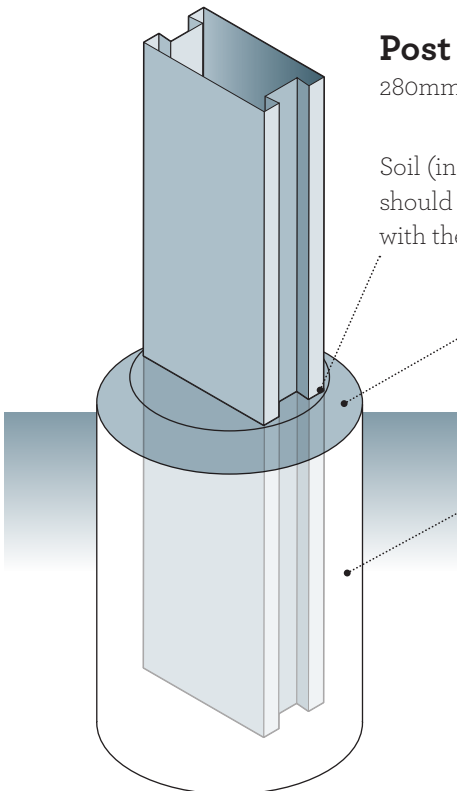

CLASSIC

PRE-PRIMED STEEL COMPONENTS

Pillar

120mm (deep)
 × 180mm (face)
 × length subject to fence
 height plus post hole depth

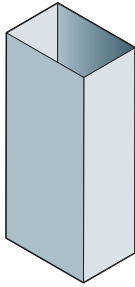

End Post

120mm (deep)
 × 180mm (face)
 × length subject to fence
 height plus post hole depth

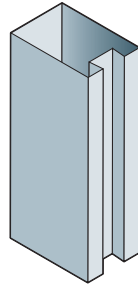

Mid Post

120mm (deep)
 × 180mm (face)
 × length subject to fence
 height plus post hole depth

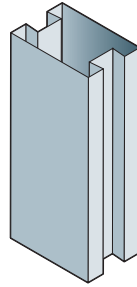

90° Post

120mm (deep)
 × 180mm (face)
 × length subject to fence
 height plus post hole depth

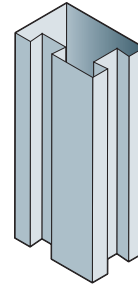

45°/Custom Angle Post

115mm (A) × 117mm (B)
 × 120mm (C)
 × length subject to fence
 height plus post hole depth

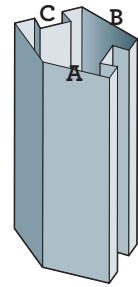

Post Infill

30mm (deep)
 × 50mm (face)
 × length subject to
 fence height

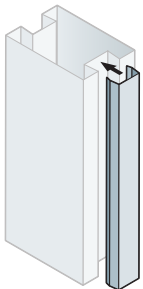

Wall Mount Channel & Masonry Anchor*

30mm (deep)
 × 52mm (back face)
 × length subject to
 fence height

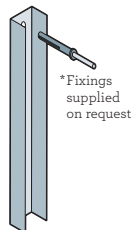

Flush Post Top

120mm (deep)
 × 180mm (face)
 × 20mm (leg height)

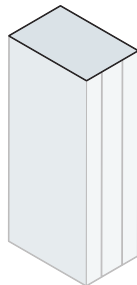

Exposed Post Top

170mm (deep)
 × 240mm (face)
 × 40mm (height)

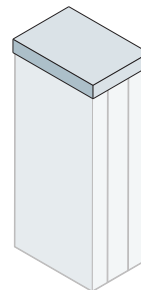

Flush 45° Post Top

110mm (A) × 115mm (B)
 × 118mm (C)
 × 20mm (leg height)

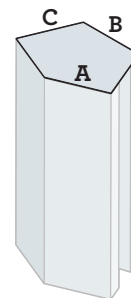

Exposed 45° Post Top

145mm (A) × 145mm (B)
 × 155mm (C)
 × 40mm (height)

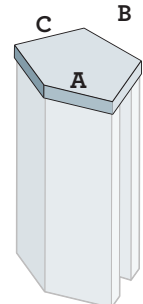

Flush Panel Capping

20mm (leg height)
 × 51mm (top face)
 × length subject to
 panel length

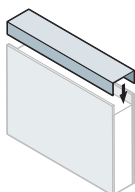

Exposed Panel Capping

45mm (leg height)
 × 80mm (top face)
 × length subject to
 panel length

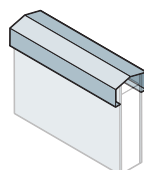

Base Channel

20mm (leg height)
 × 51mm (face)
 × length subject to
 panel length

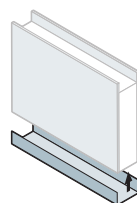

Steel Channel Joiner

30mm (deep) × 40mm (face)
 × length subject to
 panel length

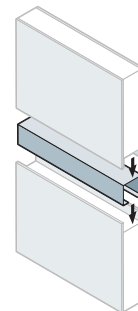

Tek Screw

10/16 galvanised
 tek screw
 16mm (length)

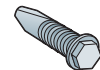

Support Bracket

35mm (deep)
 × 40mm (face with holes) ×
 48mm (wide)

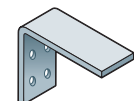

CLASSIC INFILL PANELS

Slat and tubular infills are also available to enhance your fencing. Please refer to the individual infill pages later in this section.

SIGNATURE

SPECIFICATIONS

Centre to centre guide

Panel length	Post hole centres
2400mm	> 2630mm
2700mm	> 2930mm
3000mm	> 3230mm

Post hole depth guide Wind Regions A&B

Hole depth into firm earth or clay	Fence height	Hole depth into sand, soft clay or loose earth
450mm	> 900mm	> 550mm
550mm	> 1200mm	> 650mm
600mm	> 1500mm	> 700mm
650mm	> 1800mm	> 800mm
700mm	> 2100mm	> 900mm
800mm	> 2400mm	> 1000mm
900mm	> 2700mm	> 1100mm
1000mm	> 3000mm	> 1200mm

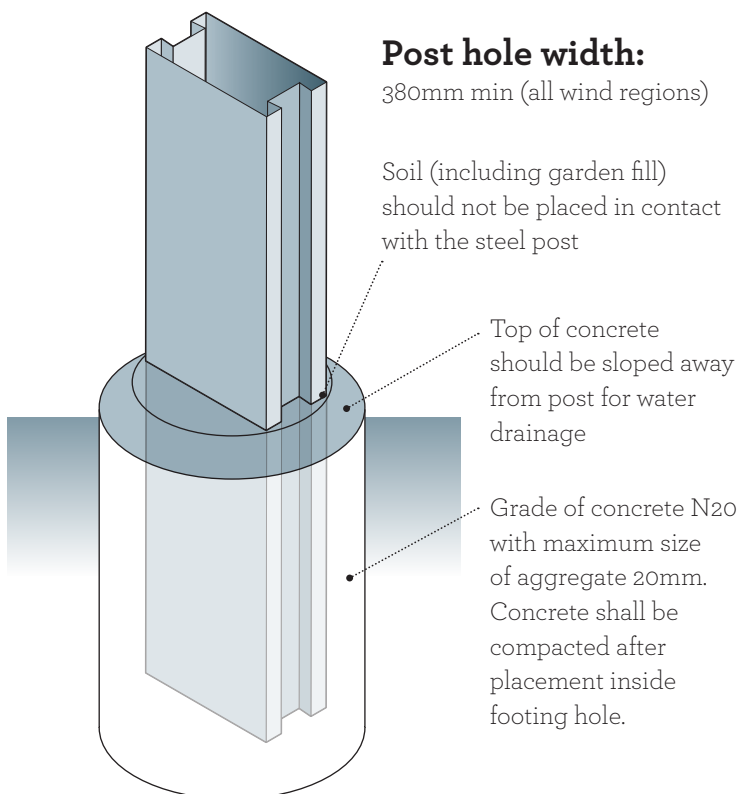
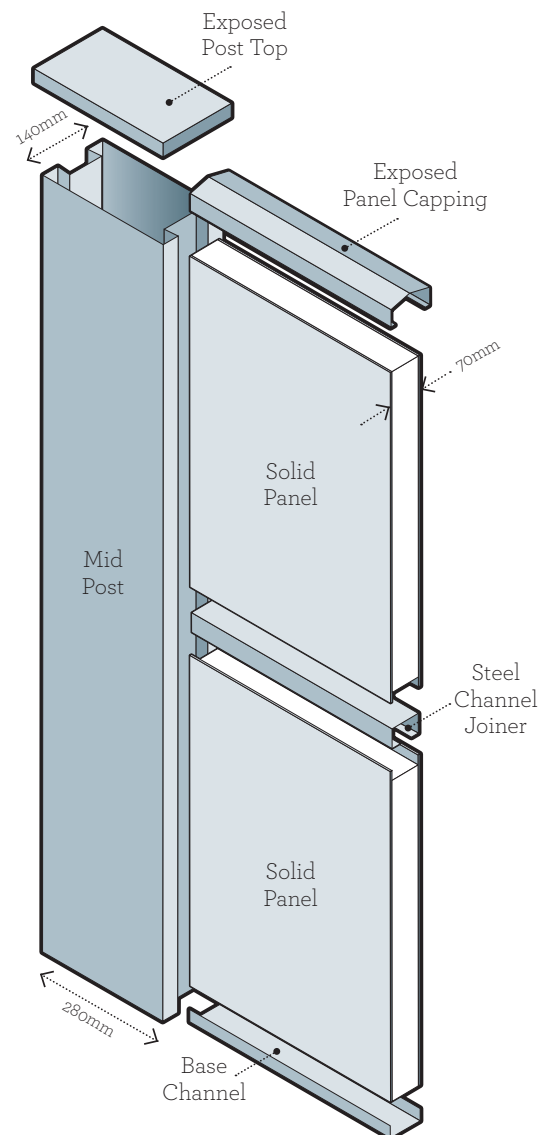
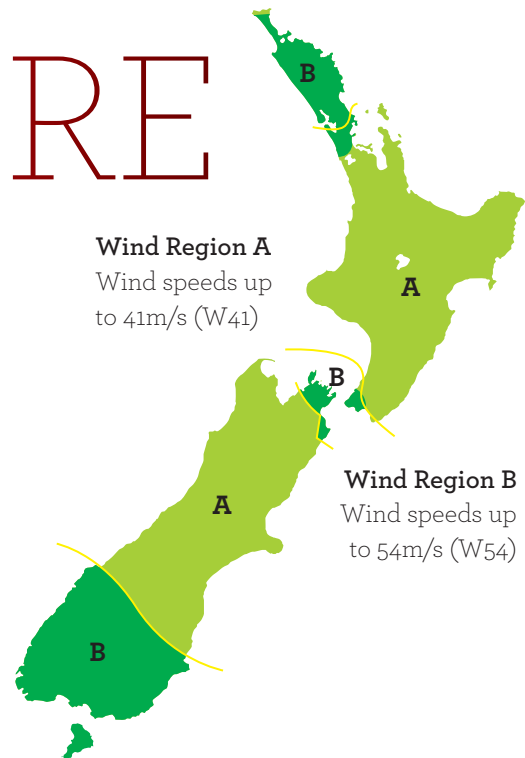

SIGNATURE

PRE-PRIMED STEEL COMPONENTS

Pillar

140mm (deep)
 X 280mm (face)
 X length subject to fence
 height plus post hole depth

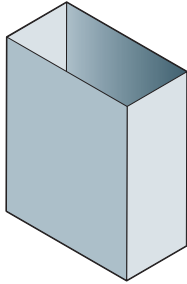

End Post

140mm (deep)
 X 280mm (face)
 X length subject to fence
 height plus post hole depth

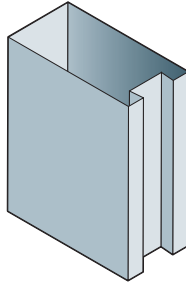

Mid Post

140mm (deep)
 X 280mm (face)
 X length subject to fence
 height plus post hole depth

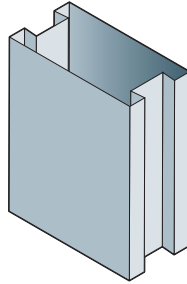

90° Post

140mm (deep)
 X 280mm (face)
 X length subject to fence
 height plus post hole depth

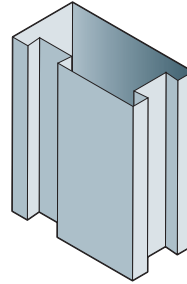

45°/Custom Angle Post

170mm (A) x 205mm (B)
 X 137mm (C)
 X length subject to fence
 height plus post hole depth

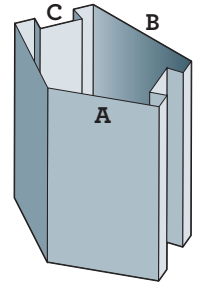

Post Infill

30mm (deep)
 X 70mm (face)
 X length subject to
 fence height

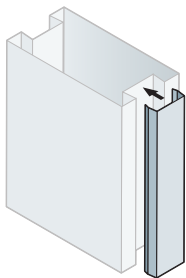

Wall Mount Channel & Masonry Anchor*

30mm (deep)
 X 72mm (back face)
 X length subject to
 fence height

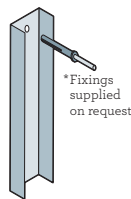

* Fixings
 supplied
 on request

Flush Post Top

140mm (deep)
 X 280mm (face)
 X 20mm (leg height)

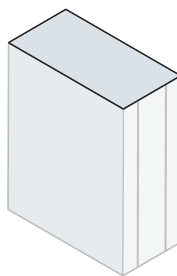

Exposed Post Top

190mm (deep)
 X 330mm (face)
 X 40mm (height)

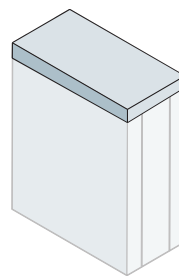

Flush 45° Post Top

165mm (A) X 199mm (B)
 X 139mm (C)
 X 20mm (leg height)

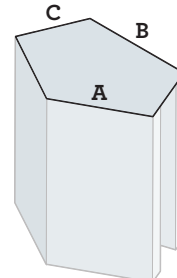

Exposed 45° Post Top

200mm (A) X 230mm (B)
 X 180mm (C)
 X 40mm (height)

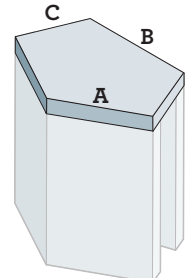

Flush Panel Capping

20mm (leg height)
 X 71mm (top face)
 X length subject to
 panel length

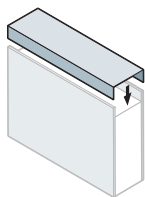

Exposed Panel Capping

55mm (leg height)
 X 100mm (top face)
 X length subject to
 panel length

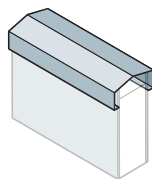

Base Channel

20mm (leg height)
 X 71mm (face)
 X length subject to
 panel length

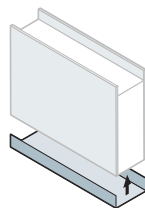

Steel Channel Joiner

30mm (deep) X 60mm (face)
 X length subject to
 panel length

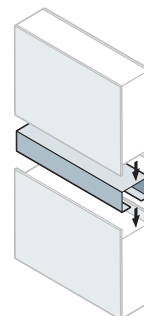

Tek Screw

10/16 galvanised
 tek screw
 16mm (length)

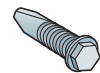

Support Bracket

40mm (deep)
 X 60mm (face with holes) X
 78mm (wide)

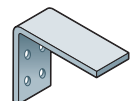

SIGNATURE INFILL PANELS

Slat, louvre, tubular and glass infills are also available to enhance your fencing. Please refer to the individual infill pages later in this section.

ESTATE

SPECIFICATIONS

Centre to centre guide

Panel length	Post hole centres
2400mm	> 2670mm
2700mm	> 2970mm
3000mm	> 3270mm

Post hole depth guide Wind Regions A&B

Hole depth into firm earth or clay	Fence height	Hole depth into sand, soft clay or loose earth
450mm	> 900mm	> 550mm
550mm	> 1200mm	> 650mm
600mm	> 1500mm	> 700mm
650mm	> 1800mm	> 800mm
700mm	> 2100mm	> 900mm
800mm	> 2400mm	> 1000mm
900mm	> 2700mm	> 1100mm
1000mm	> 3000mm	> 1200mm

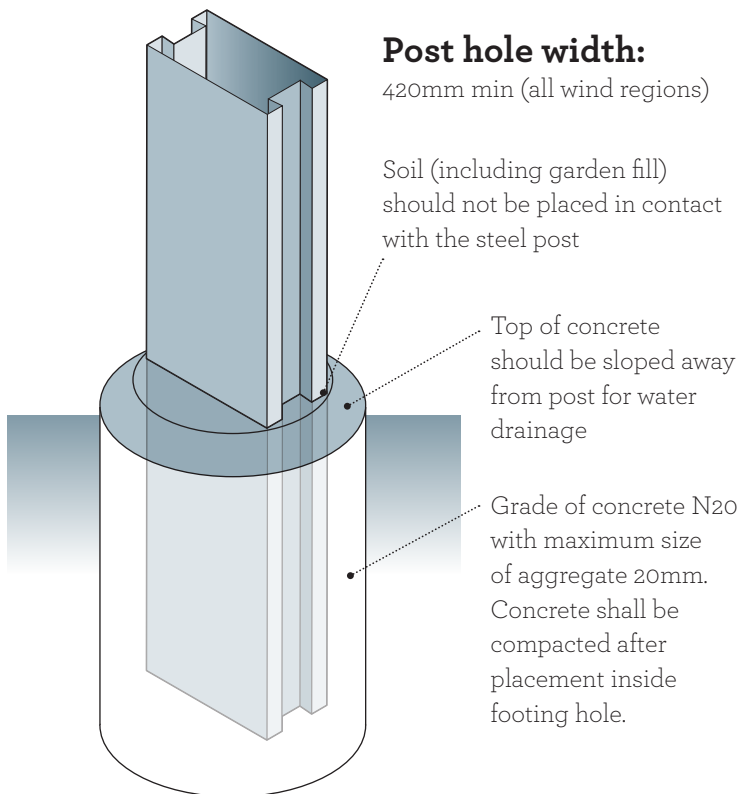
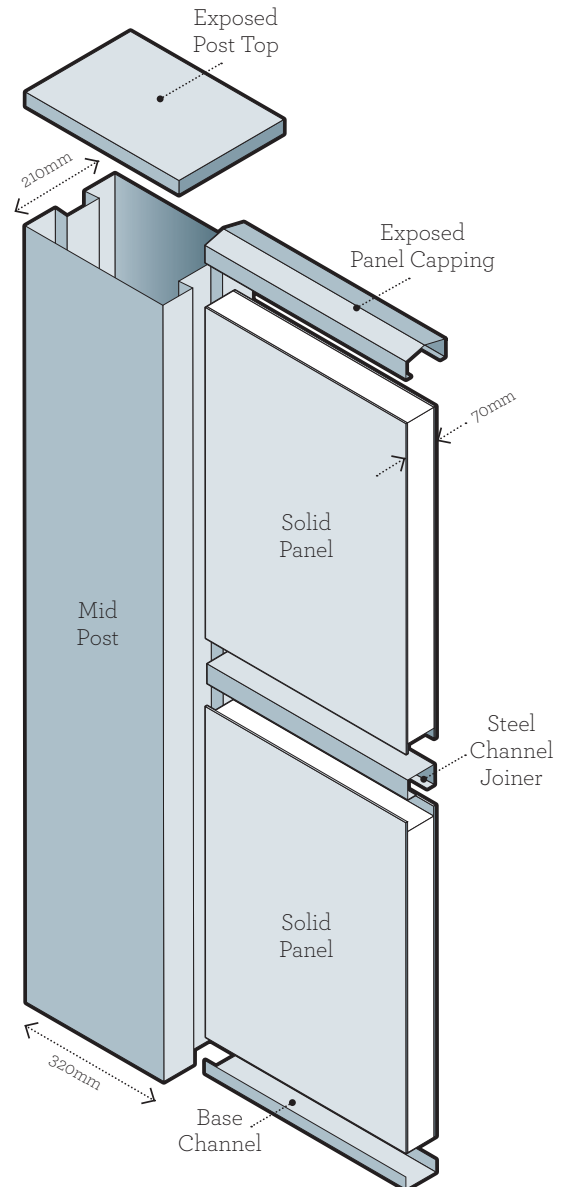
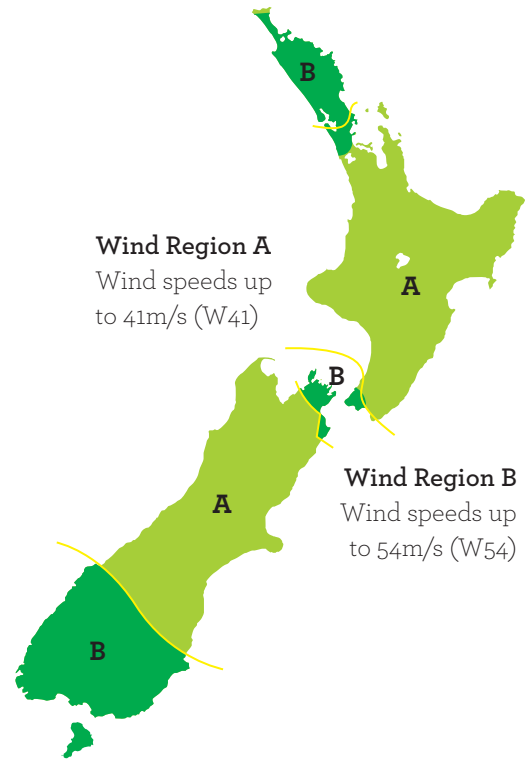

ESTATE

PRE-PRIMED STEEL COMPONENTS

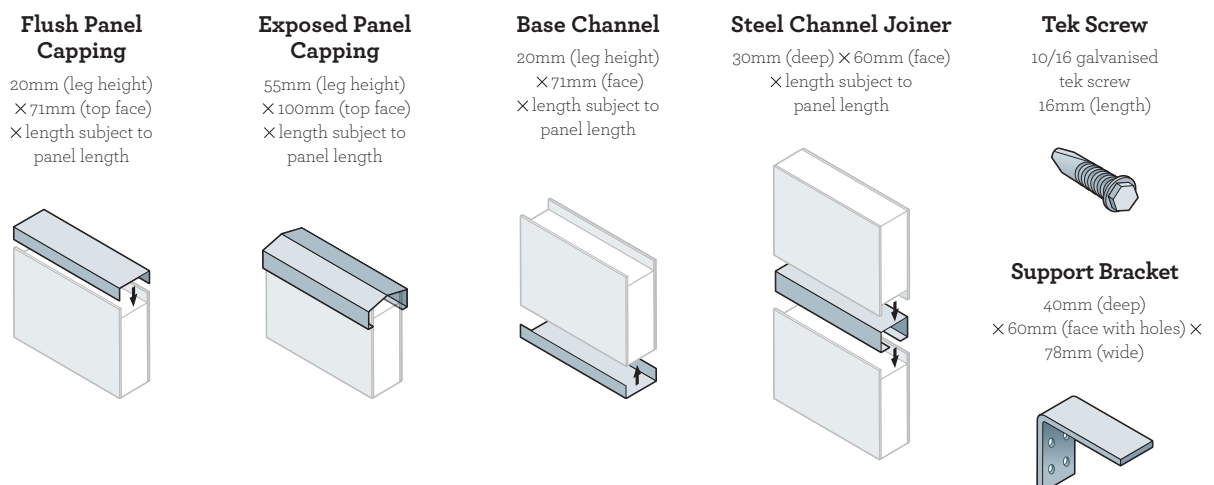
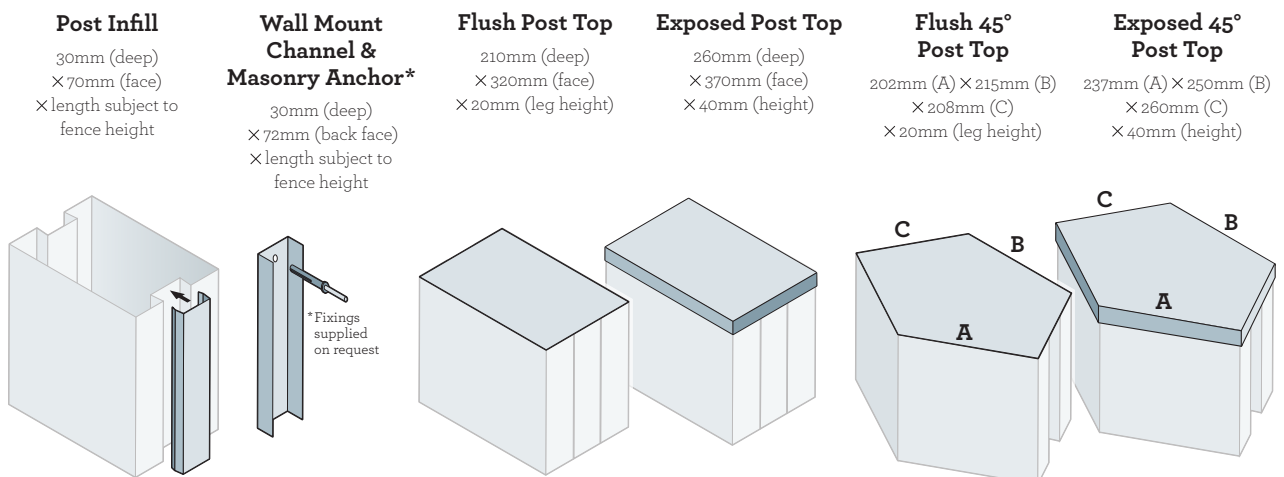
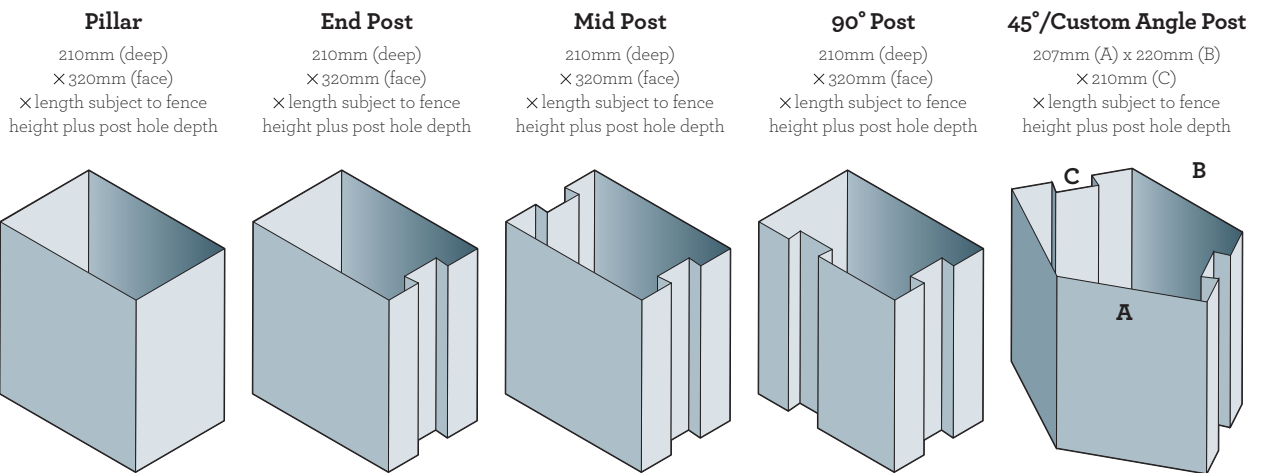

ESTATE INFILL PANELS

Slat, louvre, tubular and glass infills are also available to enhance your fencing. Please refer to the individual infill pages later in this section.

CLASSIC PANELS

SOLID PANELS

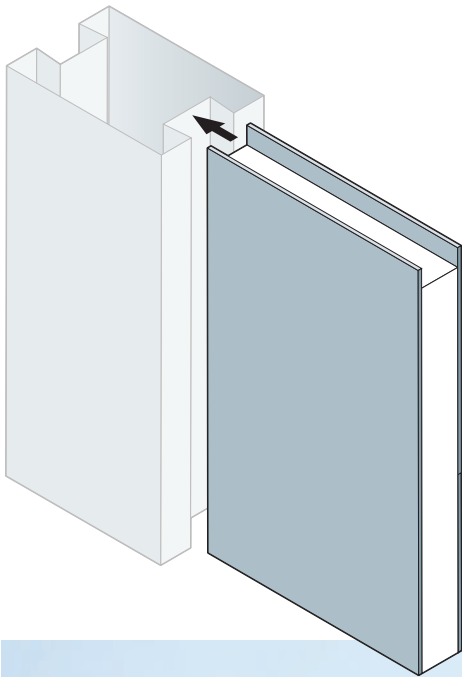

Construction:

5mm fibre cement outer skins
40mm expanded polystyrene core

2400mm (length) x 600mm (height) x 50mm (width)

2400mm (length) x 900mm (height) x 50mm (width)

2400mm (length) x 1200mm (height) x 50mm (width)

2700mm (length) x 900mm (height) x 50mm (width)

2700mm (length) x 1200mm (height) x 50mm (width)

3000mm (length) x 900mm (height) x 50mm (width)

3000mm (length) x 1200mm (height) x 50mm (width)



SIGNATURE/ESTATE PANELS

SOLID PANELS

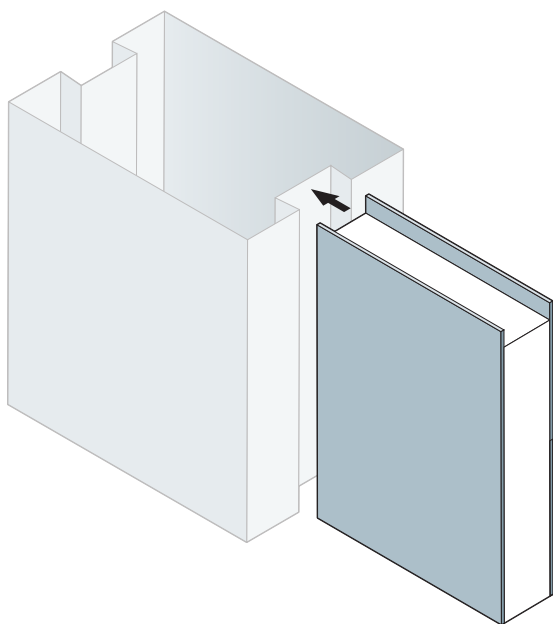

Construction:

5mm fibre cement outer skins

60mm expanded polystyrene core

2400mm (length) x 600mm (height) x 70mm (width)

2400mm (length) x 900mm (height) x 70mm (width)

2400mm (length) x 1200mm (height) x 70mm (width)

2700mm (length) x 900mm (height) x 70mm (width)

2700mm (length) x 1200mm (height) x 70mm (width)

3000mm (length) x 900mm (height) x 70mm (width)

3000mm (length) x 1200mm (height) x 70mm (width)



CLASSIC/SIGNATURE/ ESTATE INFILL PANELS

SLAT INFILL PANELS

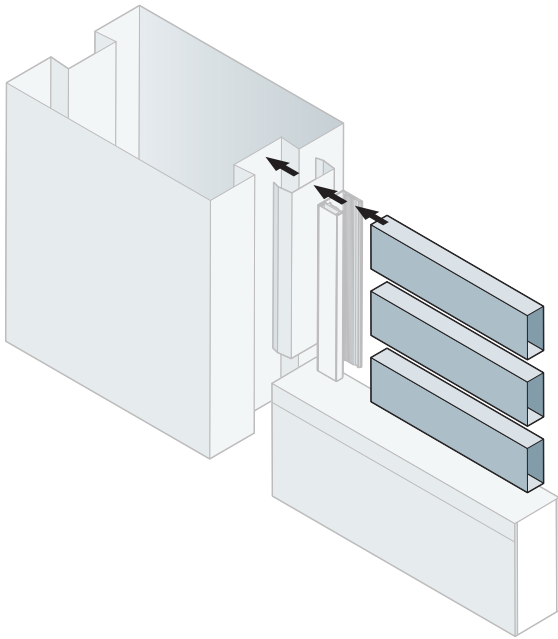

Slat infill panel height options:

300mm	900mm	1500mm
600mm	1200mm	1800mm

Slat construction:
Powdercoated aluminium

Slat sizes:

- 2330mm (length) x 60mm (height) x 25mm (width)**
- 2330mm (length) x 85mm (height) x 25mm (width)**
- 2630mm (length) x 60mm (height) x 25mm (width)**
- 2630mm (length) x 85mm (height) x 25mm (width)**
- 2930mm (length) x 60mm (height) x 25mm (width)**
- 2930mm (length) x 85mm (height) x 25mm (width)**

SLAT INFILL CHANNEL

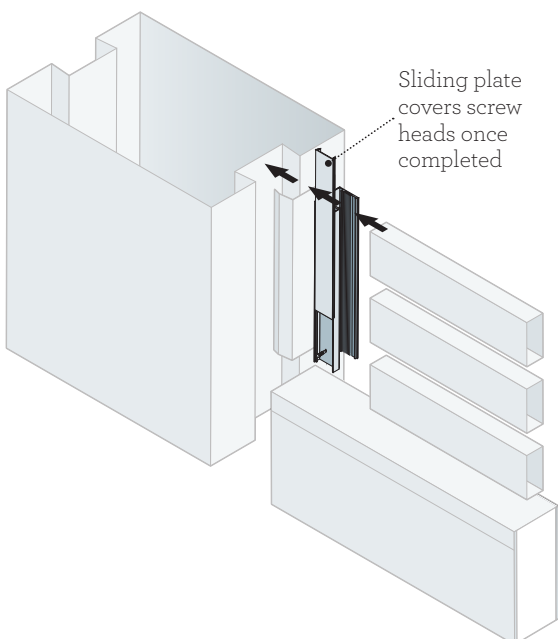

Construction:
Aluminium slat channel with cover,
powdercoated to same colour as the slats.

Slat Channel: 39mm x 32mm (includes screw plate)

Slat channel length will be cut to length required - total height of all slats plus gaps between slats, and gaps top and bottom.

CLASSIC/SIGNATURE/ ESTATE INFILL PANELS

VERTICAL SLAT INFILL PANELS

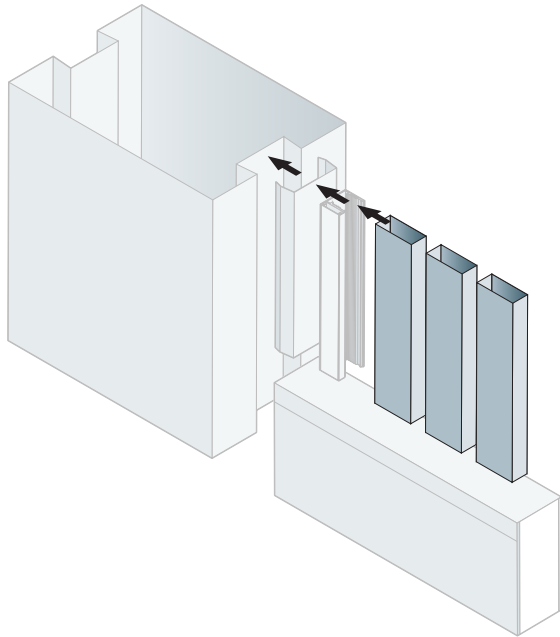

Slat infill panel height options:

300mm	900mm	1500mm
600mm	1200mm	1800mm

Slat construction:

Powdercoated aluminium

Slat sizes:

2330mm (length) x 60mm (height) x 25mm (width)
2330mm (length) x 85mm (height) x 25mm (width)
2630mm (length) x 60mm (height) x 25mm (width)
2630mm (length) x 85mm (height) x 25mm (width)
2930mm (length) x 60mm (height) x 25mm (width)
2930mm (length) x 85mm (height) x 25mm (width)

VERTICAL SLAT INFILL CHANNEL

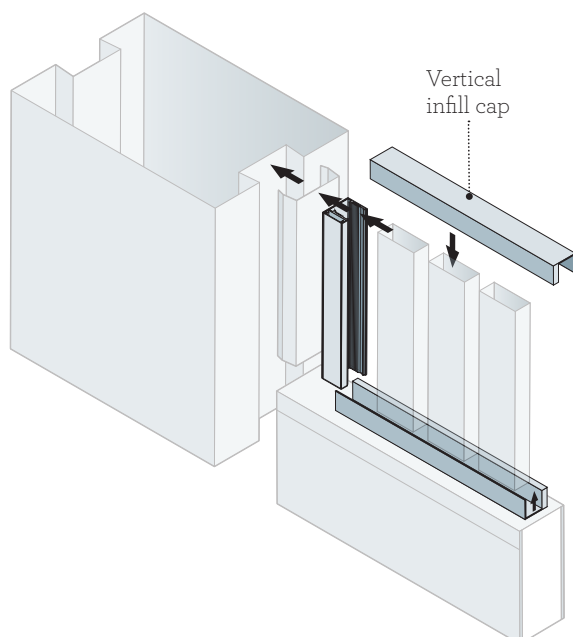

Construction:

**Aluminium slat channel with cover,
powdercoated to same colour as the slats.**

Slat Channel: 39mm x 32mm (includes screw cover plate)

Slat channel length will be cut to length required – total height of all slats plus gaps between slats, and gaps top and bottom.

SIGNATURE/ESTATE INFILL PANELS

LOUVRE INFILL PANELS

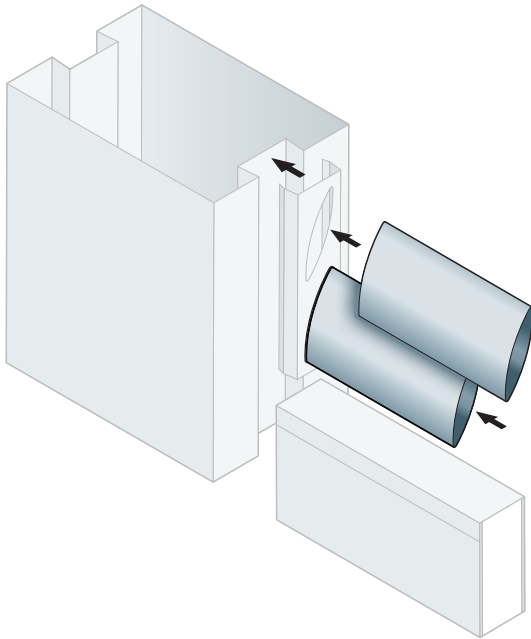

Louvre infill panel height options:

350mm (3 louvres)	1200mm (10 louvres)
600mm (5 louvres)	1500mm (13 louvres)
900mm (8 louvres)	1800mm (15 louvres)

Construction:

135mm high aluminium aerofoil louvre infill powder-coated to your colour choice.

Louvre sizes:

2400mm (length) x 136mm (height) x 32mm (width)
to suit 2400mm panels

2700mm (length) x 136mm (height) x 32mm (width)
to suit 2700mm panels

3000mm (length) x 136mm (height) x 32mm (width)
to suit 3000mm panels

LOUVRE INFILL FIXINGS

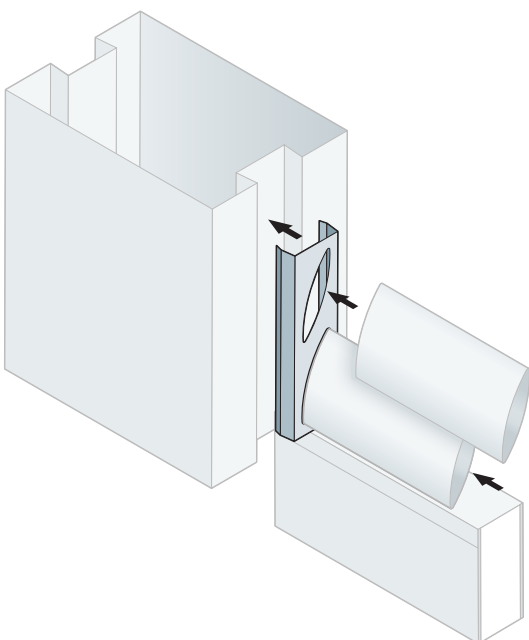

Construction:

Aluminium Louvre 135mm x 30mm inserted into a pre-punched steel Channel that accepts the louvre infill.

Louvres may need to be cut 5mm shorter than your solid panel and then inserted onto the fixing bar. The finished assembly can then be inserted between the posts.

CLASSIC/SIGNATURE/ ESTATE INFILL PANELS

TUBULAR INFILL PANELS

Construction:

Aluminium, powder-coated black. Constructed from 40mm x 40mm rails and 19mm x 19mm pickets. It is important to note that our 'square cross section' tubular panels are superior in strength to some inferior, 'round cross section' panels.

Single Top Rail

2400mm Max. (length) x 950mm (height) x 40mm (width)

2400mm Max. (length) x 1200mm (height) x 40mm (width)



Custom 600mm panel shown.



Double Top Rail

2400mm Max. (length) x 1200mm (height) x 40mm (width)

2400mm Max. (length) x 1500mm (height) x 40mm (width)

2400mm Max. (length) x 1800mm (height) x 40mm (width)



SOLID PANEL FENCING

Vecta

Reversible panel that can be used for a flat-top or rod-top look

2250mm Max. (length) x 1200mm (height) x 40mm (width)

2250mm Max. (length) x 1500mm (height) x 40mm (width)



Custom curved-top panel shown - available on request.

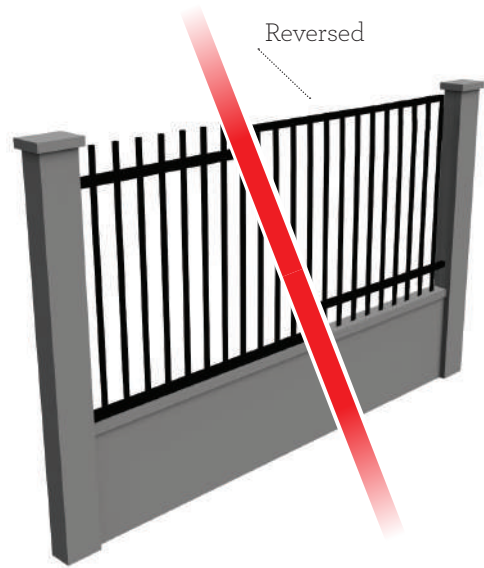

Axis

2250mm Max. (length) x 1200mm (height) x 40mm (width)

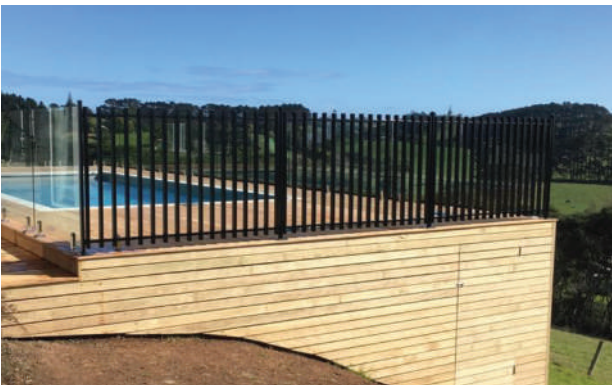

TUBULAR INFILL FIXINGS

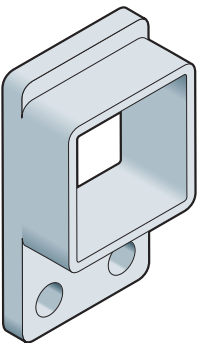

Construction:

3mm aluminium, powder-coated black
Bracket shape dependant on the tubular panel chosen.

SIGNATURE/ESTATE INFILL PANELS

GLASS INFILL PANELS

For the 70mm Signature and Estate posts only

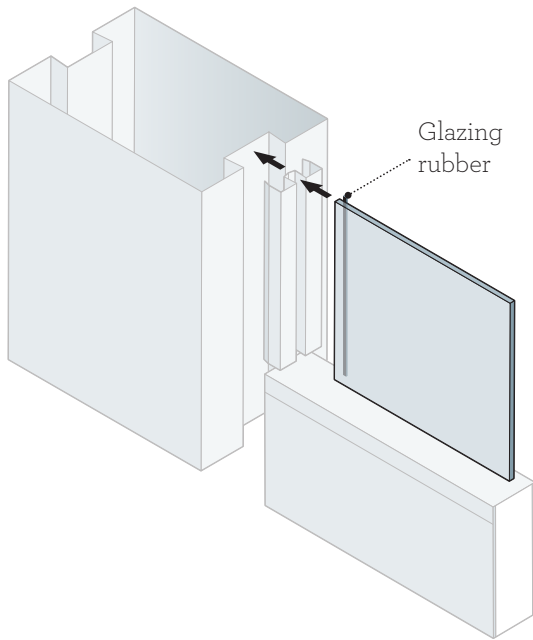

Construction:

12mm toughened safety glass

**2380mm (length) x 1200mm Max. (height)
x 12mm (width)**



GLASS INFILL FIXINGS

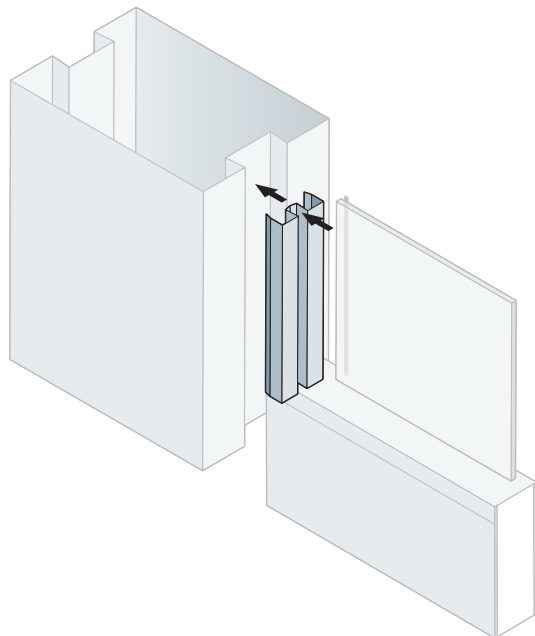

Max glass pannel size

**2400 Max (length) x 1200mm. (height)
x 12mm (width)**







COMMERCIAL ACOUSTIC BARRIERS



BelAire[®]
DESIGNER FENCING

...make it your own!





BelAire®
DESIGNER FENCING

...make it your own!

COMMERCIAL ACOUSTIC BARRIERS

HOW DOES A NOISE BARRIER WORK?

A noise barrier is a solid structure that intercepts and reduces sound within the shadow that it casts. The closer a barrier can be to the source or receiver and the higher it is, the more effective it will be, and, to be effective, the line of sight between the source and receiver must be blocked completely by the barrier.

The standard BelAire 70mm panel, with its 60mm expanded polystyrene core, will reduce sound levels up to approximately 28 decibels*.

*See "Acoustic Barrier Field Test". Levels in your own situation may differ due to environmental conditions such as ground type and surrounding objects or buildings. Frequency is also a factor - high frequency sounds are more effectively decreased than low frequencies.

HUMAN PERCEPTION OF SOUND

DID YOU KNOW? A decrease in noise of 10dB would be perceived to be half as loud, and a 28dB reduction represents a decrease of 85% to the human ear.

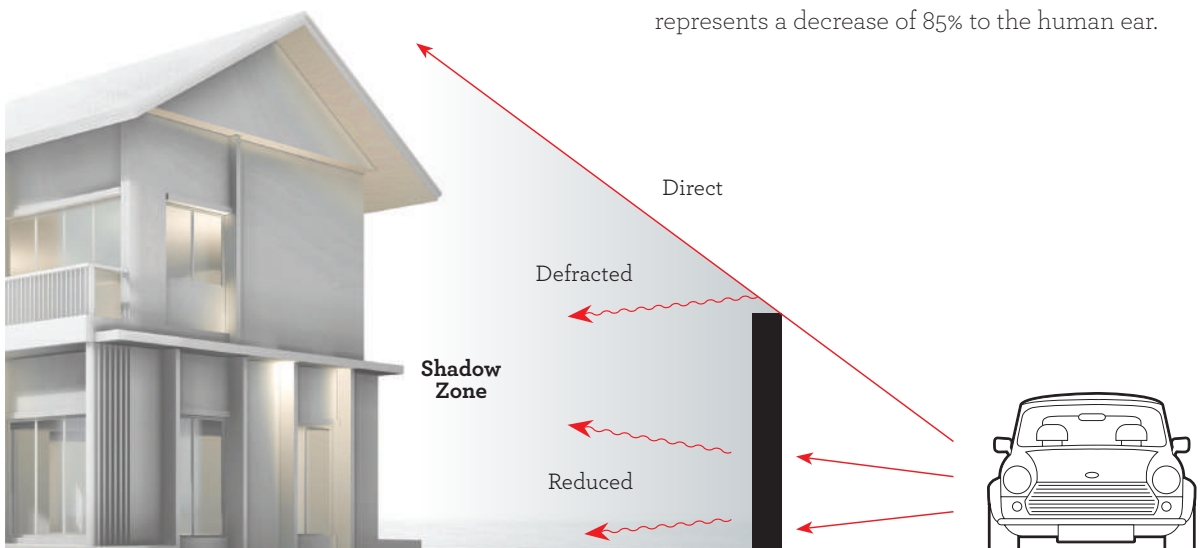

COMMERCIAL ACOUSTIC BARRIERS

Decibels	Residential	Commercial
20dB	Whisper	Secluded Woods
45dB	Bedroom	Library
60dB	Conversation	Air Conditioning Unit
70dB	Living Room Music	Passing Cars
80dB	Factory Office	Passing Truck
90dB	Lawn Mower	Chainsaw
100dB	Motorbike	Jointer/Planer
110dB	Music Concert	Jack Hammer
120dB	Rock Concert	Jet Aircraft 150m away
140dB	Large Generator	Jet Aircraft 5m away

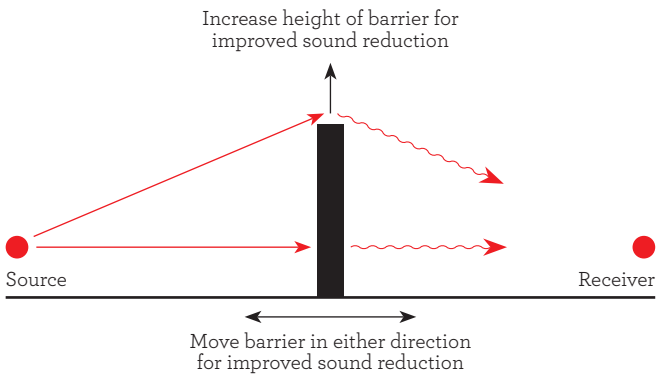

Parkland Subdivision Napier

The Napier Council required a noise attenuation and security wall for its subdivision in Parklands. The project was bordering the expressway so noise reduction was an important feature. In 15 days we were able to construct 1500m of 1.8m high barrier wall.

Project Specifications:

Signature Acoustic Wall

1500m x 1.8m high

Exposed Capping, Solid/Slat Bays

900mm high with 900mm high of vertical 85mm slats with 33mm gaps

Colour

Painted double concrete, slats powder coated grey friars

"We were all very happy with the work carried out. Everything was done in a very efficient and professional manner and the guys are a great team to work with. Thanks again."

Napier Council



Early Education Centre

An early education centre in one of Hamilton's fast-developing subdivision were looking for a wall which provided them with maximum security and noise reduction. BelAire Fencing customised a 200m Classic wall with a fun and playful colour combination.

Project Specifications:

Client: Rob Berridge Fencing

Classic Acoustic Wall

200m x 1.5/1.8m high

Flush Capping, Solid/Slat Bays

900mm high with 900mm high of vertical
85mm slats with 33mm gaps

Colour

Painted double concrete, slats powder coated
grey and green friars



ACOUSTIC FIELD TEST REPORT

Evaluated by the Acoustics Research Group at the University of Canterbury. A comprehensive report is available on request.

PURPOSE:

It is the intention of this report to illustrate the performance of the BelAire barrier system in real-world applications. These testing environments were selected due to their ability to offer easily identifiable and comparable scenarios. This included:

- Origin of sound, its type and extent
- Geographical layout
- Barrier configuration

SCOPE:

This information is to be used as a guide and in conjunction with the independent laboratory testing that has been performed on BelAire barriers. The test results reported below are an accurate account of the locations used. Should specific values be required for an application of the BelAire barrier system, it is recommended that a formal acoustic analysis be undertaken for that environment.

TESTING EQUIPMENT SPECIFICATIONS

Digitech model	QM-1589
Standard applied	IEC651 type 2, ANSI S1.4 type2
Frequency range	31.5Hz-8kHz
Measuring level range	30-130dB (Low range 30-100dB used for these records)
Frequency weighting	A/C (A used for these records)
Microphone	½" electret condenser
Time weighing	Fast 125mS, Slow 1 Sec (Slow used for these records)
Accuracy	+/-1.5dB

TEST 1 HIGHWAY ROAD NOISE

Origin source	6 lane highway (70Km/hr)
Location of barrier from origin	5.5m
Barrier type	4.0m barrier type wall (75mm panel)

Readings at exposed side

Steady fluctuation	71-81dB
Peak reading	84dB
Minimum reading	68dB

Readings at shielded side

Steady fluctuation	58-60dB
Peak reading	61dB
Minimum reading	56dB

NOTES:

Further readings were taken at a distance of 5m back from the shielded side of the barrier (approx 10.5m from origin). Readings at this distance displayed a fluctuating range of 1 to 2dB higher than at the shielded face of the barrier. Readings at greater distances from the shielded face displayed only ambient sound levels and were not influenced by the fluctuating decibel range of the highway.

TEST 2 DOMESTIC LAWNMOWER

Origin source	2-Stroke lawnmower
Location of barrier from origin	2m
Barrier type	2.1m traditional type wall (75mm panel)

Readings at exposed side

Steady fluctuation	90-91dB (min/max reading also)
--------------------	-----------------------------------

Readings at shielded side

Steady fluctuation	62dB (min/max reading also)
--------------------	--------------------------------

NOTES:

A secondary reading was taken at a distance of 5 meters back from the shielded side of the barrier and a steady reading of 63 dB was recorded. This increase of approx 1dB is consistent with the highway values shown in Test 1. The peak and minimum readings for the lawnmower test are not listed due to them being identical to the steady output values.

ACOUSTIC BARRIER POSTS

FOR BARRIERS up to 3.0m HIGH

Post dimensions: 140mm (deep) x 280mm (face) 0.95 mm BMT

Panel thickness: 70mm

Density of composite panel materials: 15.49kg/m²

Suitable for fence heights: 900mm - 3000mm

Post centres: 2630mm, 2930mm, 3230mm

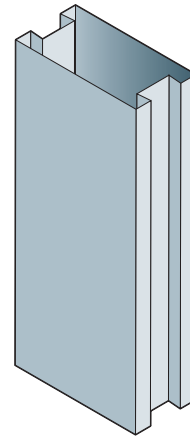

FOR BARRIERS up to 3.1m - 5.1m HIGH

Post dimensions: 250mm (deep) x 150mm (face) 0.95 mm BMT

Panel thickness: 70mm

Density of composite panel materials: 15.49kg/m²

Suitable for fence heights: 3000mm - 5100mm

Post centres: 2500mm, 2800mm

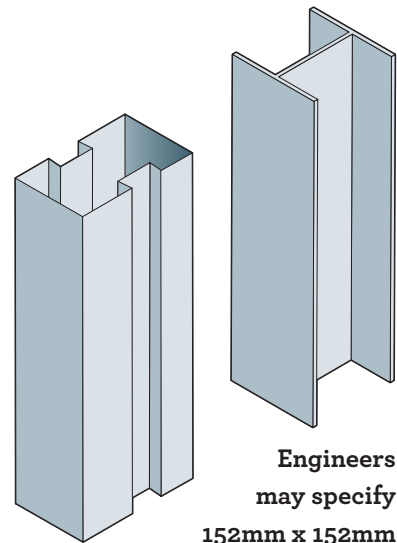

NOTE: All barriers over 3m high need to be engineered to suit the wind regions and the ground conditions. Please contact us on 0800 235 2473 for more details.

Engineers may specify 152mm x 152mm universal columns.



ACOUSTIC BARRIER PANELS

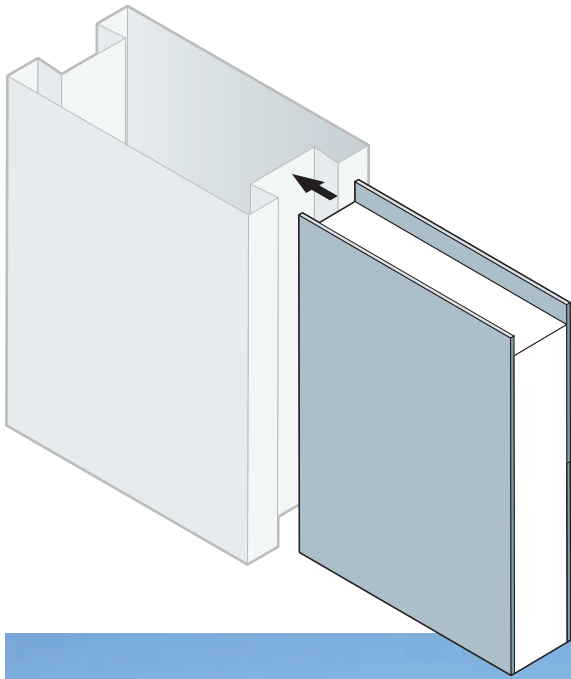

Construction:

5mm fibre cement outer skins

60mm expanded polystyrene core

2400mm (length) x 900mm (height) x 70mm (width)

2400mm (length) x 1200mm (height) x 70mm (width)



Up to 3.0m HIGH

SPECIFICATIONS

Centre to centre guide

Panel length	Post hole centres
2230mm	> 2500mm
2530mm	> 2800mm

Post hole depth guide Wind Regions A&B

Hole depth into firm earth or clay	Barrier height	Hole depth into sand, soft clay or loose earth
450mm	> 900mm	> 550mm
550mm	> 1200mm	> 650mm
600mm	> 1500mm	> 700mm
650mm	> 1800mm	> 800mm
700mm	> 2100mm	> 900mm
800mm	> 2400mm	> 1000mm
900mm	> 2700mm	> 1100mm
1000mm	> 3000mm	> 1200mm

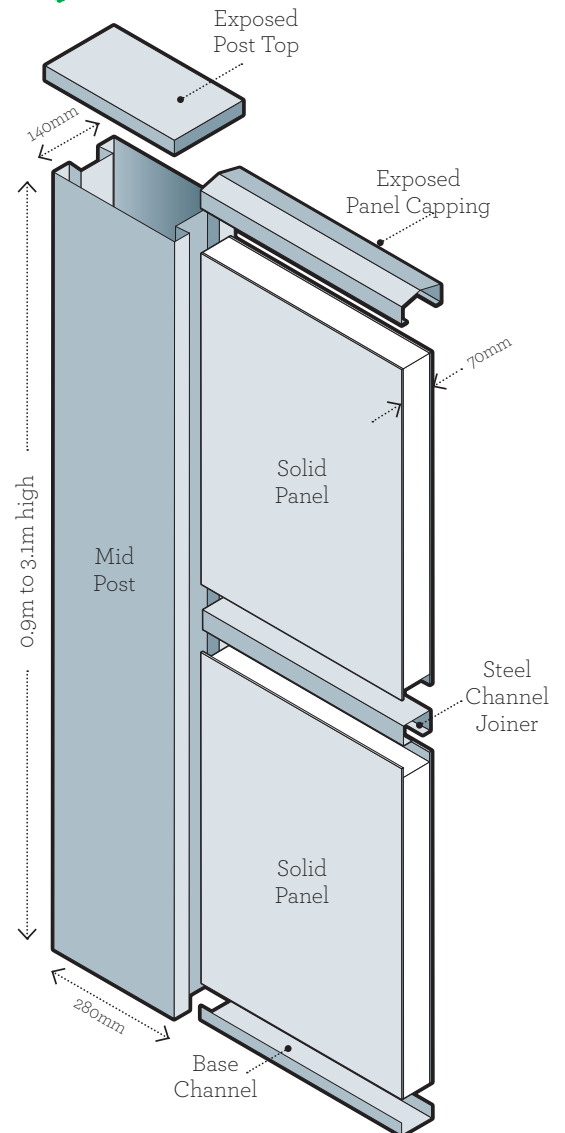
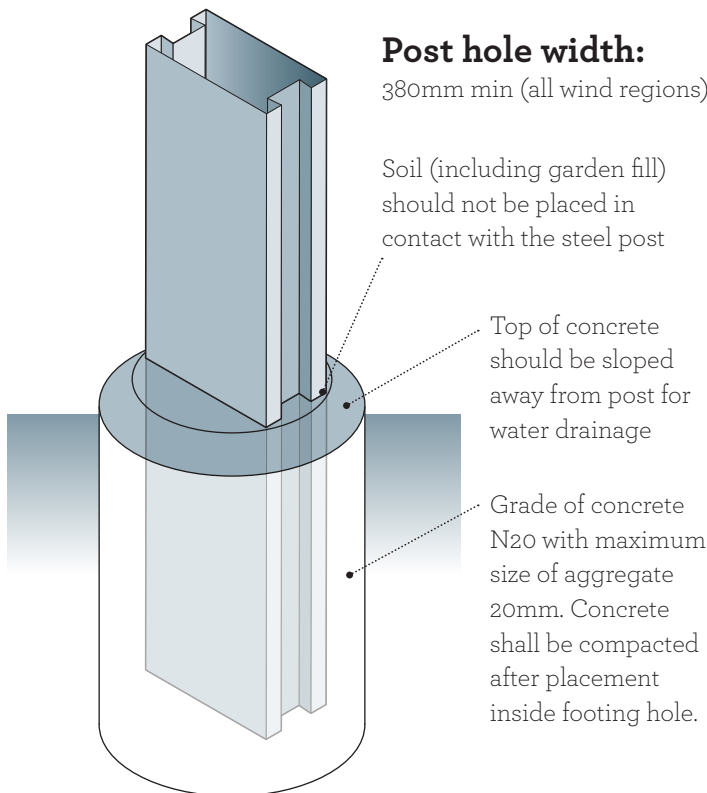
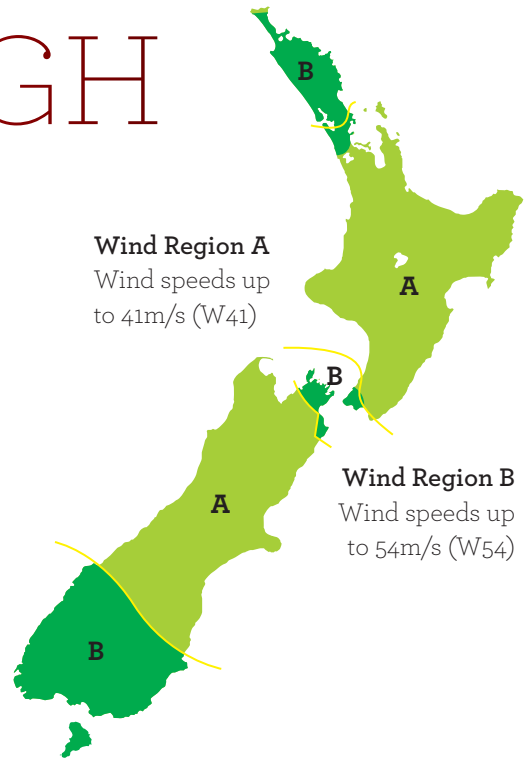

3.1m to 5.1m HIGH

SPECIFICATIONS

Centre to centre guide

Panel length	Post hole centres
2400mm	> 2500mm

Post hole depth guide

Post hole depths and hole sizes will be determined by either the engineer or once on-site soil tests have been done.

Post hole width:

For all barriers over 3.1m high, the post hole width and depth will be determined by the specifics of each site.

Soil (including garden fill) should not be placed in contact with the steel post

Top of concrete should be sloped away from post for water drainage

Grade of concrete N20 with maximum size of aggregate 20mm. Concrete shall be compacted after placement inside footing hole.

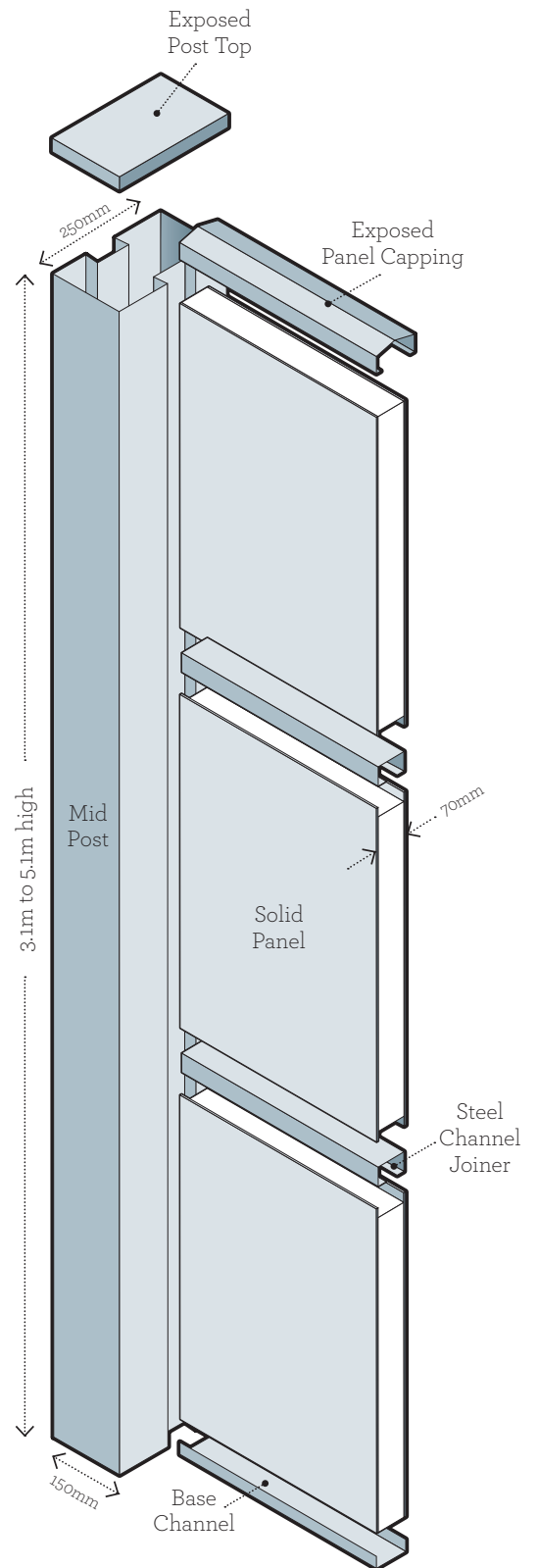
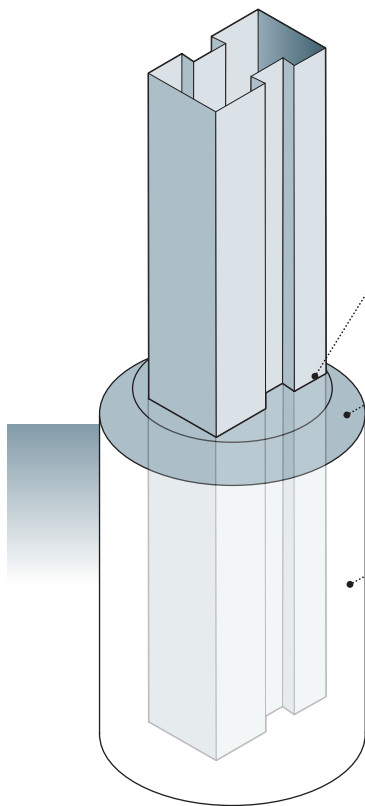





FRAMELESS GLASS FENCING & BALUSTRADE



BelAire[®]
DESIGNER FENCING

...make it your own!

Have you tried out our new 3D Glass Builder?

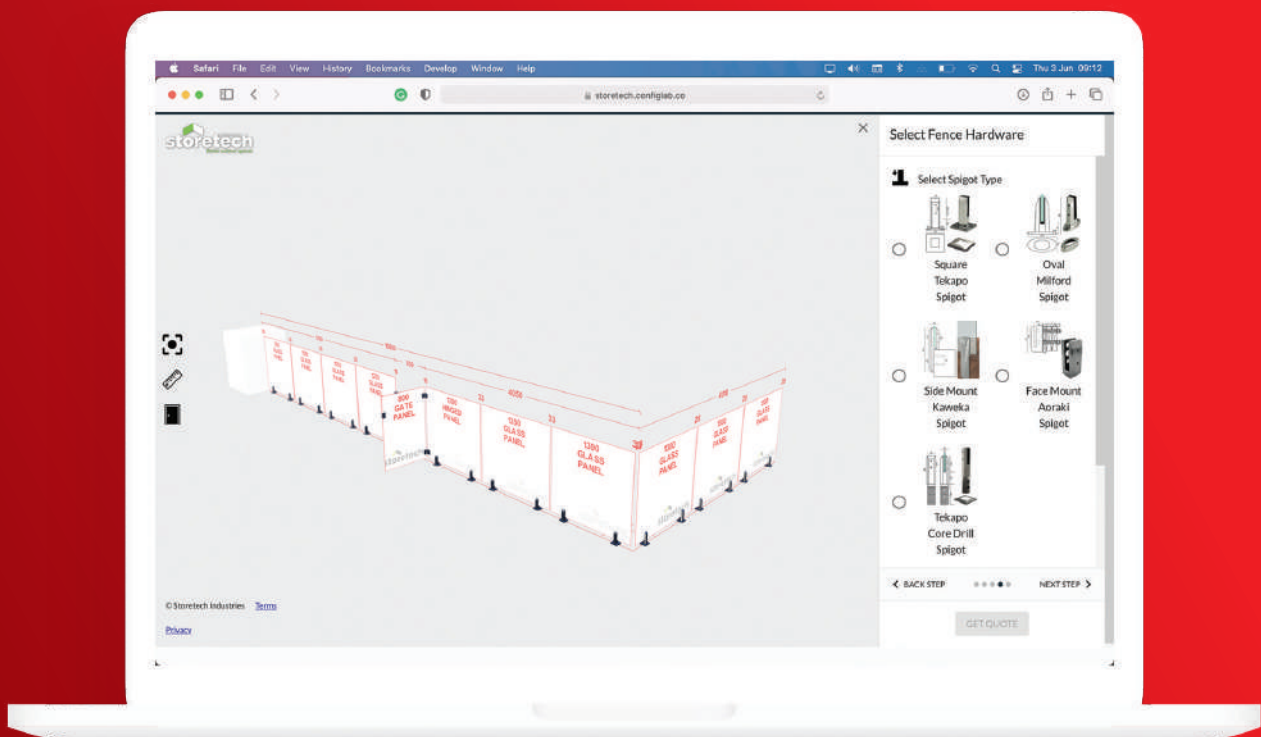

Now you can build your very own glass fencing right in front of your eyes, to the exact specification you need.



What are you waiting for?
Scan or click the QR Code
to start building today.



BelAire®
DESIGNER FENCING

...make it your own!

AS/NZS2208
Grade A TF
ID 7777

FRAMELESS GLASS FENCING & BALUSTRADE

CLEAR

BelAire frameless glass pool fencing and balustrade is invisibly superior – it's crystal clear without the green tint you get with inferior brands. Enjoy lounging by the pool on the deck with nothing to interrupt your view. Relax behind a strong, effective wind barrier and take in all-day sunshine as BelAire glass casts no shadows!

SAFE

With uninterrupted views, you'll always be able to keep your eye on the kids as they play in the pool. And with 12mm thick toughened safety glass with polished bevel edges, you'll know they'll also be safe and sound outside the fence. Our gates also use a self-closing hinge with a side pull latch, so you'll know they'll never be left open by mistake.

VERSATILE

BelAire can be installed on a variety of surfaces, including tiled areas, pavers, timber decks, concrete and across landscaped areas – making it a truly versatile option for pools, water features, patios, decking, and natural settings. The modern architectural look can also be customised from our selection of elegant, corrosion-resistant, mini posts, latches and hinges to match your property.

EASY

It's so simple to clean and maintain – with no frames to collect water and dust, and with corrosion-resistant hardware throughout, it will remain sparkling with minimum effort.

It's also simple to install – most home owners would find the system quick and easy to install using basic tools that they would have in their shed. If you'd rather get someone else to install it, we have a list of preferred installers throughout NZ. Call us on 0800 235 2473 and we will put you in touch with an installer in your area.

COMPLIANT

Our toughened safety glass that comes with the PAS Mark AS/NZS2208 marking on every panel and is all F4 and F9 Building Code compliant. Should you require a PS1 (or an Extra High Wind Zone PS1) to submit with your pool or building permit request, please email us at info@belairefencing.co.nz

You will require a handrail on your balustrade or pool fencing if there is a drop of more than 1m on one side. BelAire slimline handrails are manufactured from polished stainless steel to create a sophisticated finish that does not diminish the appearance of your glass fencing. They are also very strong and fully compliant to NZS4223:2016.

Enfield Drive

With such an amazing view there was no question why we installed the BelAire Glass Fencing system. The job only took two days and resulted in high strength glass fencing with core drill spigots and a clear, uninterrupted view of Hawke's Bay.

Project Specifications:

12mm Toughened Enduroshield Glass Fencing

1200mm High to be pool compliant, with some custom panels beside stepped areas

Polished Core Drill Stainless 2205 Spigots and Soft closing hinges

38 meters installed into concrete by core drilling

Specified by

South Pacific Landscaping



David Reid Homes

How could you install anything other than the BelAire Glass Fencing with this amazing views when the sun sets in the west. As this site was in an Extra High wind zone you'll notice we used 3 Spigots per panel and is A Grade toughened panels to perform against them elements.

Project Specifications:

12mm Toughened Enduroshield Glass Fencing

1200mm High to be pool compliant to NZ compliance F9

Polished Top Mounted Tekapo Stainless 2205 Spigots and Soft closing hinges

52 meters installed into composite decking

Specified by

David Reid Homes



Easy-clean glass coating

Upgrade our toughened safety glass with **EnduroShield**, an invisible, non-stick coating that reduces cleaning time by up to 90%. Your glass stays cleaner for longer, and it's a breeze to rinse down.

Choose to upgrade to EnduroShield-coated glass when you order on-line, or just talk with one of our friendly sales representatives.



Blenheim Balustrade Install

A Blenheim client approached BelAire Designer Fencing for a balustrading solution to boarder his outdoor deck and pool area, not wanting to obstruct his amazing view. Our Frameless Glass Balustrade system provided functionality and safety that complimented the aesthetics of our client's house.

Project Specifications:

12mm Toughened Enduroshield Glass Fencing
Combination of 1200mm high and 1000mm high

Tekapo Base Mounted Spigot
105 meters installed into timber decking

"I was really impressed with how easy BelAire made the whole process. The computerised layout and plan of what was required made it so easy. Great to get a reliable quote and then easy delivery and after care service."

Anonymous Client



Coromandel Glass Install

BelAire came up with the perfect solution for our client where they could be comfortable and compliant with the NZ compliance and still keep their wonderful view.

Project Specifications:

12mm Toughened Enduroshield Glass Fencing

1200mm high to be pool compliant to NZ compliance F9

Polished Top Mounted Tekapo Stainless

2205 Spigots and Soft closing hinges

51 meters installed into timber decking

Specified by

Customer chosen direct with BelAire Fencing



Easy-clean glass coating

Upgrade our toughened safety glass with EnduroShield, an invisible, non-stick coating that reduces cleaning time by up to 90%. Your glass stays cleaner for longer, and it's a breeze to rinse down.

Choose to upgrade to EnduroShield-coated glass when you order on-line, or just talk with one of our friendly sales representatives.



EXAMPLE CONFIGURATION

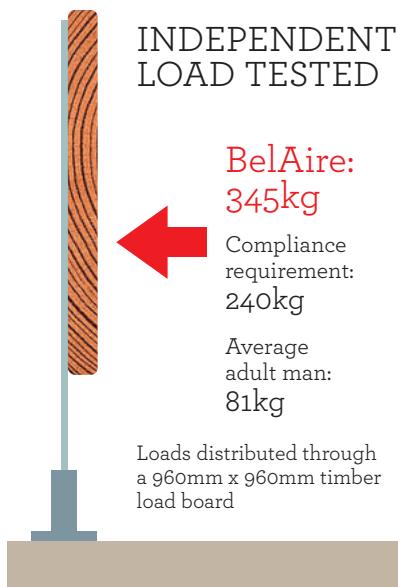
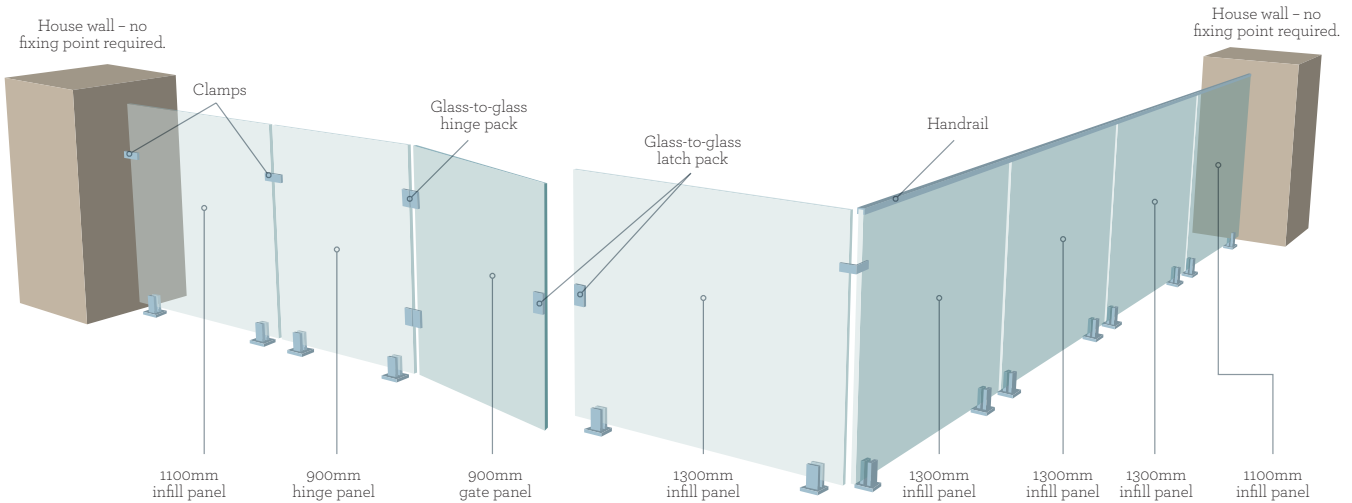

INDEPENDENTLY LOAD TESTED

BelAire:
345kg

Compliance requirement:
240kg

Average adult man:
81kg

Loads distributed through a 960mm x 960mm timber load board

GENERAL FEATURES

- 12mm toughened safety glass
- New Zealand standards compliant
- 10 year warranty
- DIY instructions included

Compliant with:

F4 and F9 Building Code compliant.

AS/NZS2208: 1996

New Zealand standards for safety glass manufacturing

NZS 8500

Safety barriers and fences around swimming pools, spas and hot tubs

NZS 4223.3:2016

Approved Balustrade Handrail

SOFT, NOT SLAMMED

Even though BelAire doors are made from toughened safety glass, a slammed glass gate will always put you on edge.



Relax. Upgrade to glass-to-glass or glass-to wall **polaris soft-closing hinges**, and you'll never hear the bang of a slammed gate again!

Choose to upgrade to polaris soft-closing hinges when you order on-line, or just talk with one of our friendly sales representatives.



FRAMELESS GATE LAYOUTS

GLASS-TO-GLASS HINGES & GLASS-TO-GLASS LATCH

- Hinge panel available widths: 500/900/1300/1450/1600mm
- Use a friction latch. Any size panel can be used as a latch panel

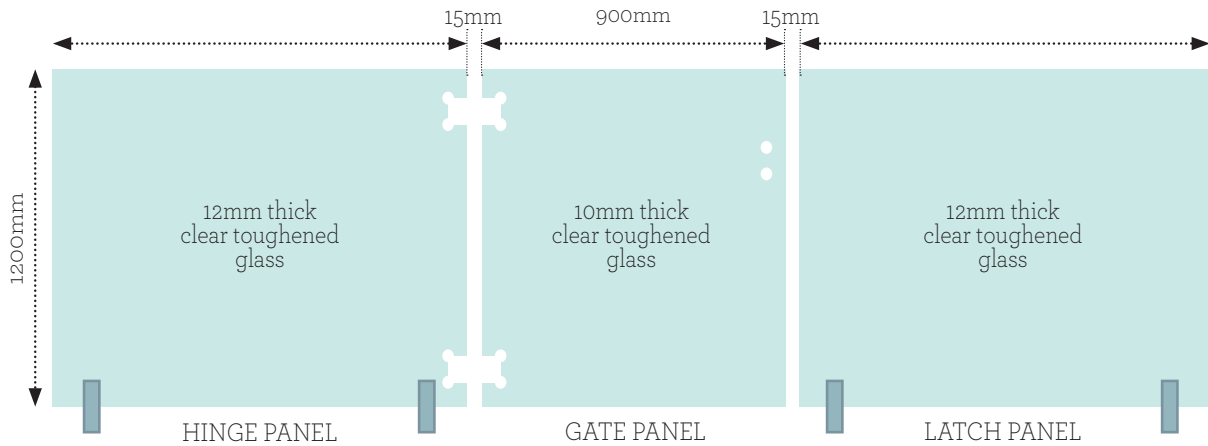

GLASS-TO-GLASS HINGES & WALL/POST GATE LATCH

- Hinge panel available widths: 500/900/1300/1450/1600mm

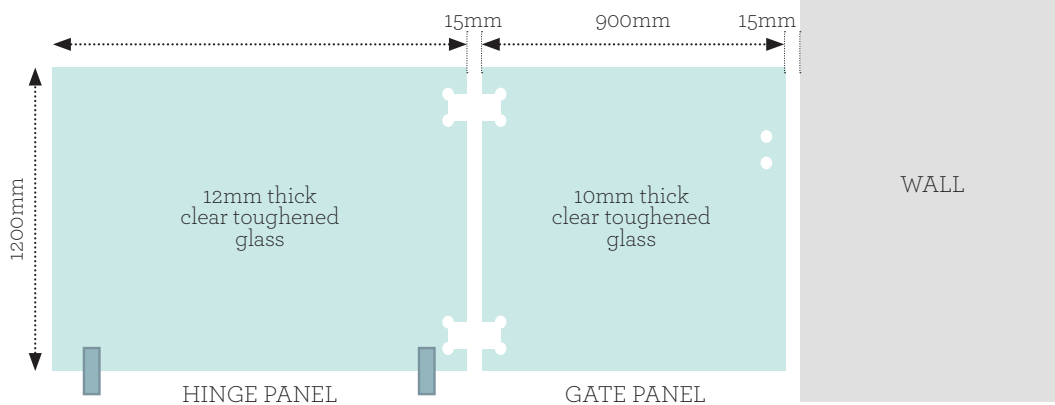

WALL/SQUARE POST GLASS HINGES & GLASS-TO-GLASS LATCH

- Use a friction latch. Any size panel can be used as a latch panel

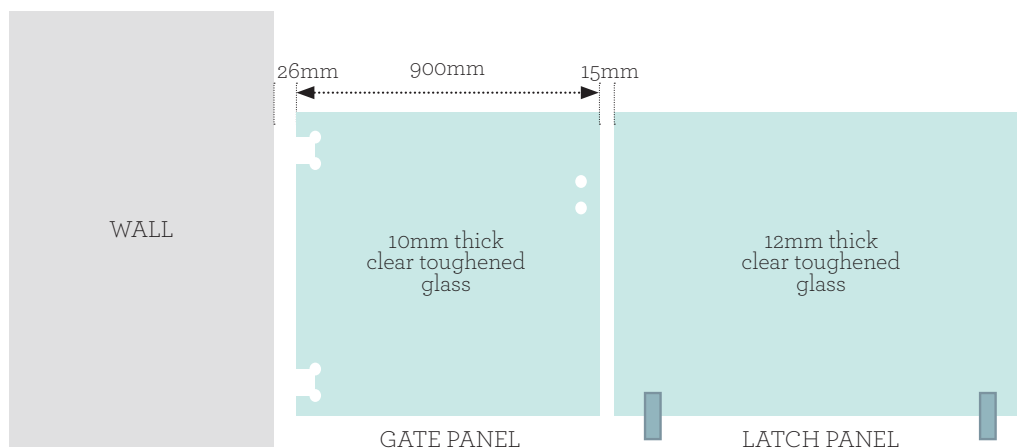



The World's Leading Glass Treatment

ULTIMATE PROTECTION

Optically clear, UV stable, chemical resistant, water and oil repellent.

HIGHLY DURABLE

Permanently bonds to the glass and comes with a true 10 year performance warranty*

LOW SERVICING COSTS

EnduroShield keeps glass visibly clearer for longer and reduces the frequency between cleans.

SUITS ALL GLASS RANGES

From balustrading to pool fencing, high rise and domestic glazing, shower screens and insulated glass units, EnduroShield is the smart choice for glass.

Silicone based coating

Competitor products fill in hills & valleys of the glass.



EnduroShield Coating

EnduroShield follows hills & valleys of the glass.

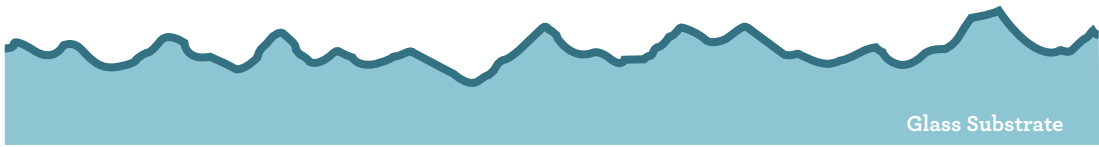

Silicone based seals sit on top of the glass surface and can quickly wear off, leaving the surface unprotected. EnduroShield follows the hills and valleys of the glass, forming a strong, permanent* bond that does not flake or peel.

TESTING AND CERTIFICATION

*EnduroShield's performance has been independently tested by one of the leading global testing and certification houses, TÜV Rheinland in Germany for durability, easy-clean functionality, safety and quality. Testing was carried out to simulate a lifetime of 10 years on glass for both interior and exterior use, and EnduroShield passed all tests.



- Easy to clean
- Durability tested

*Contact us for warranty info and terms and conditions.

FRAMELESS GLASS FENCING PANELS

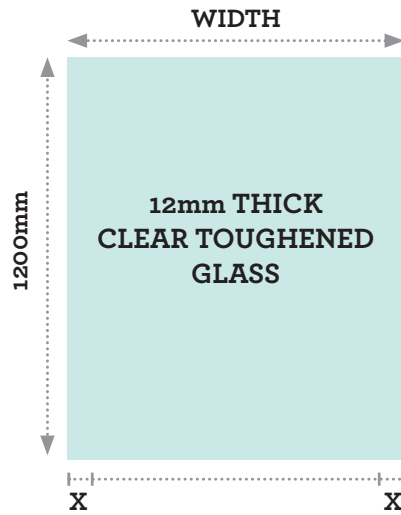

Order Code	Width	Height	Distance from Edge to Spigot (X)	Thickness	Sqm	Glass Weight KGS	Corner Radius
SCE0312PP	300mm	1200mm	75mm	12mm	0.36	11kg	2mm
SCE0412PP	400mm	1200mm	75mm	12mm	0.48	14kg	2mm
SCE0512PP	500mm	1200mm	100mm	12mm	0.60	18kg	2mm
SCE0612PP	600mm	1200mm	100mm	12mm	0.72	22kg	2mm
SCE0712PP	700mm	1200mm	100mm	12mm	0.84	25kg	2mm
SCE0812PP	800mm	1200mm	150mm	12mm	0.96	29kg	2mm
SCE08512PP	850mm	1200mm	150mm	12mm	0.96	29kg	2mm
SCE0912PP	900mm	1200mm	150mm	12mm	1.08	32kg	2mm
SCE09512PP	950mm	1200mm	150mm	12mm	1.08	32kg	2mm
SCE1012PP	1000mm	1200mm	150mm	12mm	1.20	36kg	2mm
SCE10512PP	1050mm	1200mm	150mm	12mm	1.26	37kg	2mm
SCE1112PP	1100mm	1200mm	150mm	12mm	1.32	38kg	2mm
SCE11512PP	1150mm	1200mm	150mm	12mm	1.38	41kg	2mm
SCE1212PP	1200mm	1200mm	150mm	12mm	1.44	43kg	2mm
SCE12512PP	1250mm	1200mm	200mm	12mm	1.50	45kg	2mm
SCE1312PP	1300mm	1200mm	200mm	12mm	1.56	47kg	2mm
SCE13512PP	1350mm	1200mm	200mm	12mm	1.62	49kg	2mm
SCE1412PP	1400mm	1200mm	250mm	12mm	1.68	50kg	2mm
SCE14512PP	1450mm	1200mm	250mm	12mm	1.74	53kg	2mm
SCE1512PP	1500mm	1200mm	250mm	12mm	1.80	54kg	2mm
SCE15512PP	1550mm	1200mm	250mm	12mm	1.86	56kg	2mm
SCE1612PP	1600mm	1200mm	250mm	12mm	1.92	58kg	2mm



FRAMELESS GLASS BALUSTRADE PANELS

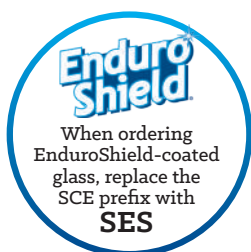
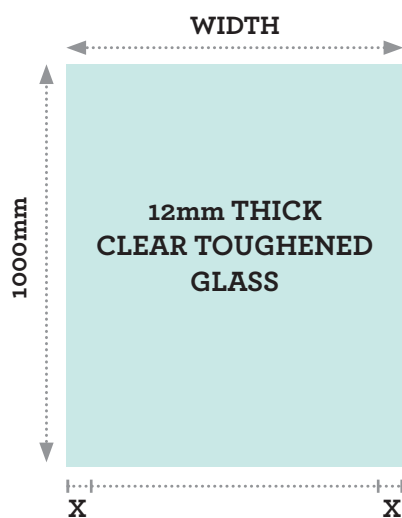

Order Code	Width	Height	Distance from Edge to Spigot (X)	Thickness	Sqm	Glass Weight KGS	Corner Radius
SCE0610BP	600mm	1000mm	100mm	12mm	0.60	18kg	2mm
SCE0710BP	700mm	1000mm	100mm	12mm	0.70	21kg	2mm
SCE0810BP	800mm	1000mm	150mm	12mm	0.80	24kg	2mm
SCE08510BP	850mm	1000mm	150mm	12mm	0.85	25.5kg	2mm
SCE0910BP	900mm	1000mm	150mm	12mm	0.90	27kg	2mm
SCE09510BP	950mm	1000mm	150mm	12mm	0.95	28.5kg	2mm
SCE1010BP	1000mm	1000mm	150mm	12mm	1.00	30kg	2mm
SCE10510BP	1050mm	1000mm	150mm	12mm	1.05	31.5kg	2mm
SCE1110BP	1100mm	1000mm	150mm	12mm	1.10	33kg	2mm
SCE11510BP	1150mm	1000mm	150mm	12mm	1.15	34.5kg	2mm
SCE1210BP	1200mm	1000mm	150mm	12mm	1.2	36kg	2mm
SCE12510BP	1250mm	1000mm	200mm	12mm	1.25	37.5kg	2mm
SCE1310BP	1300mm	1000mm	200mm	12mm	1.3	39kg	2mm
SCE13510BP	1350mm	1000mm	200mm	12mm	1.35	40.5kg	2mm
SCE1410BP	1400mm	1000mm	250mm	12mm	1.4	42kg	2mm



FRAMELESS GLASS GATE & HINGE PANELS

BELAIRE GATE PANELS

- 8 & 10mm thick clear toughened glass
- Corner radius: 2mm
- 10mm supplied as standard

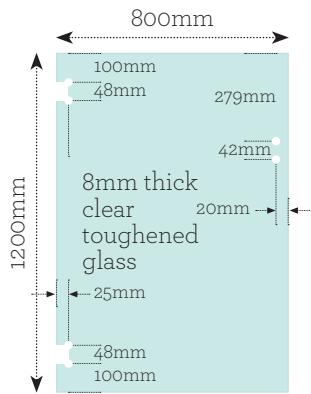

Order Code: SCE0812GP PH
Glass weight: 19.9kg

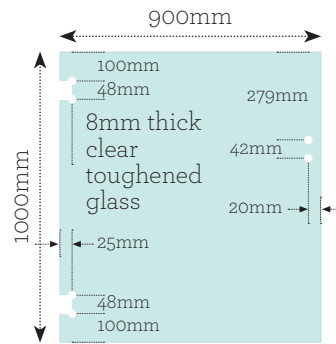

Order Code: SCE0910GP PH
Glass weight: 21.6kg

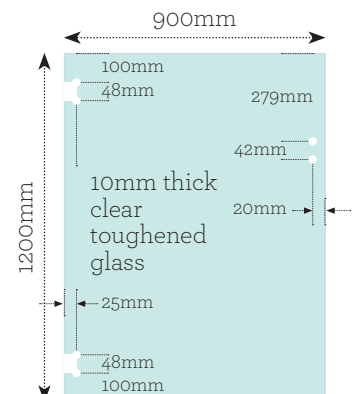

Order Code: SCE0912GP PH
Glass weight: 28kg

BELAIRE HINGE PANELS

- 12mm thick clear toughened glass
- Corner radius: 2mm

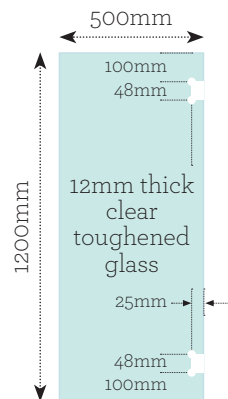

Order Code: SCE0512HP PH
Glass weight: 18kg

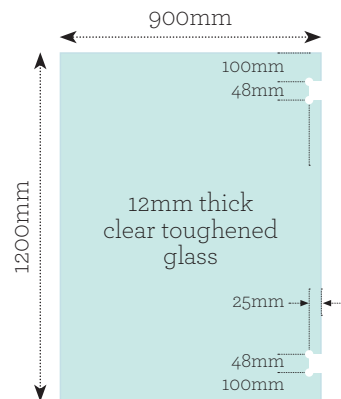

Order Code: SCE0912HP PH
Glass weight: 32.4kg

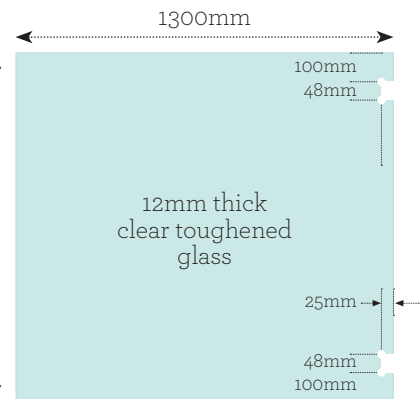

Order Code: SCE1312HP PH
Glass weight: 46.8kg

NOTE: 500mm wide hinge panel is only suitable for use with an 800mm wide gate and clamps



Order Code: SCE14512HP PH
Glass weight: 52.2kg

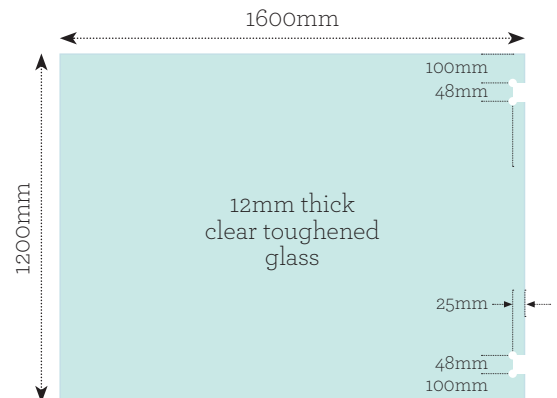

Order Code: SCE1612HP PH
Glass weight: 58kg

DECK LAYOUTS

SQUARE BASE PLATE SPIGOT (TEKAPO)

External deck measurements need a minimum of 60mm + 25mm (total of 85mm) taken off each corner of the deck to get the correct dimensions to work out the glass panels.

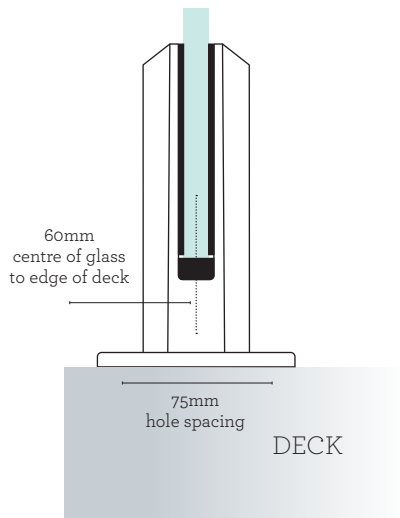

DOMICAL BASE PLATE SPIGOT (MILFORD)XS

External deck measurements need a minimum of 75mm + 25mm (total of 100mm) taken off each corner of the deck to get the correct dimensions to work out the glass panels.

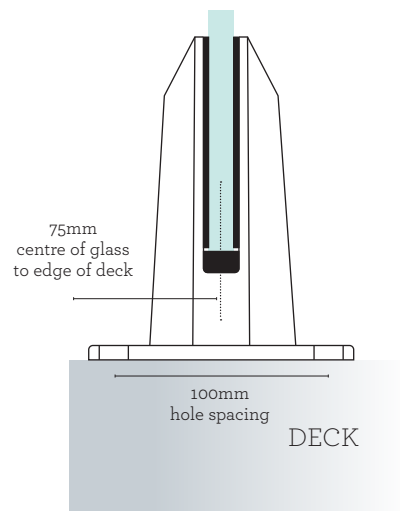

SIDE MOUNT SPIGOT (KAWEKA)

The glass sits flush with the outside of the deck, so use the dimensions of the deck to work out the glass panels.

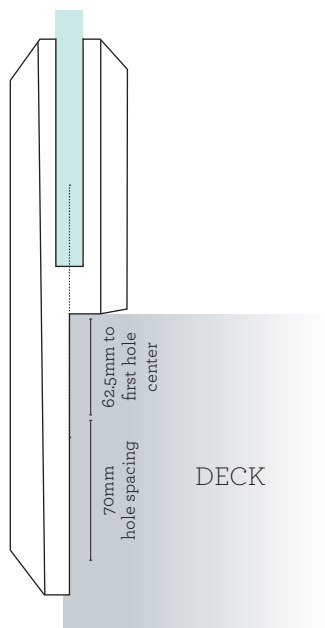

SIDE MOUNT SPIGOT (AORAKI)

External deck measurements need 30mm added to each corner of the deck to get the correct dimensions to work out the glass panels.

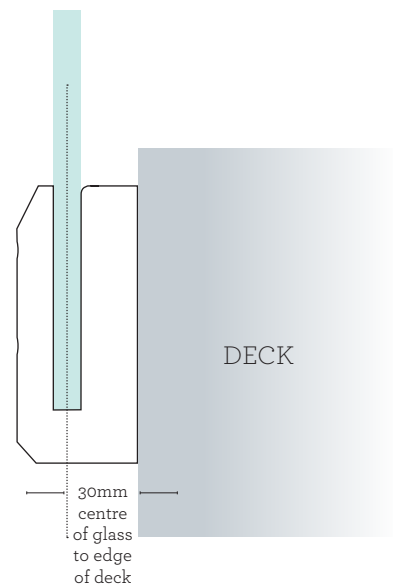

FRICTION SPIGOT RANGE

- Contemporary square shape with minimal visible fixings
- Slim profile with tapered top to comply with “no foot hold” requirements
- Recessed friction plate for neat finish
- Base plate spigots have countersunk holes to enable flush fitting Marine Grade Stainless Steel
- Made from **Duplex 2205 stainless steel** - a superior duplex stainless steel, featuring elevated levels of chemical compounds that enable superior strength and corrosion/pitting resistance. Commonly used in harsh marine environments.

ALL SPIGOTS* ARE NOW AVAILABLE **POWDER-COATED**** IN A RANGE OF **DULUX COLOURS**

TEKAPO BASE PLATE SPIGOT

Duplex 2205 Stainless Steel



BASE PLATED Spigot - FRICTION FIT
Polish Finish Order Code: SCEPSSP
Black Finish Order Code: SCEPSSP B
Satin Finish Order Code: SCEPPSP

SLIMLINE DOMICAL COVER
Polish or Black Finish
 (Comes with base plated spigot)

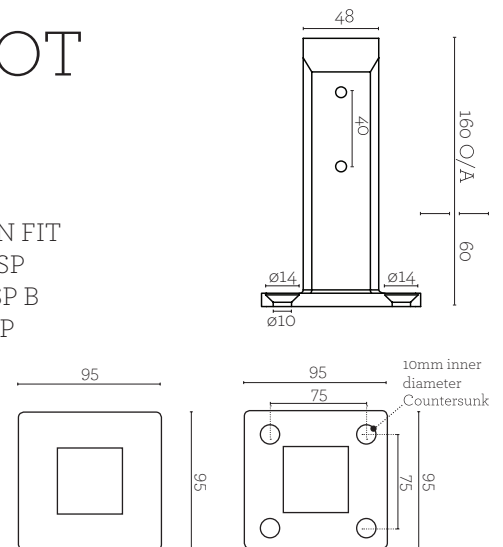

MILFORD BASE PLATE SPIGOT

Duplex 2205 Stainless Steel



BASE PLATE Spigot - FRICTION FIT
Polish Finish Order Code: SCEPSOP
Black Finish Order Code: SCEPSOP B

DOMICAL COVER
Polish, Satin or Black Finish
 (Comes with the base plated spigot)

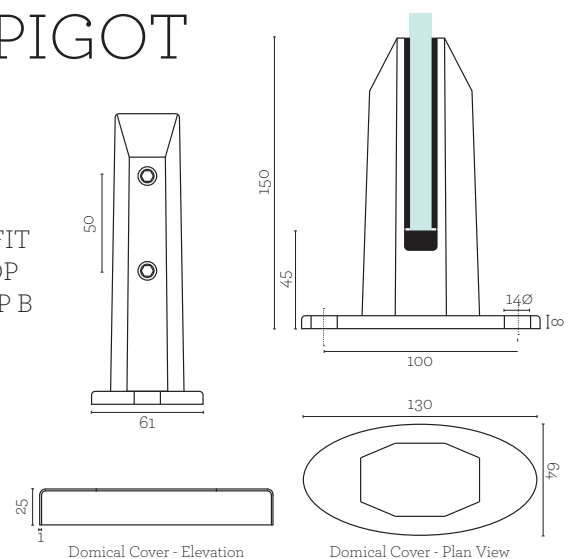

*spigots only, not gate hardware. **1yr Warranty on Powder-Coated black spigots.

ALL
SPIGOTS ARE
NOW AVAILABLE
POWDER-COATED
IN A RANGE OF
DULUX
COLOURS

KAWEKA SIDE MOUNT SPIGOT

Duplex 2205 Stainless Steel

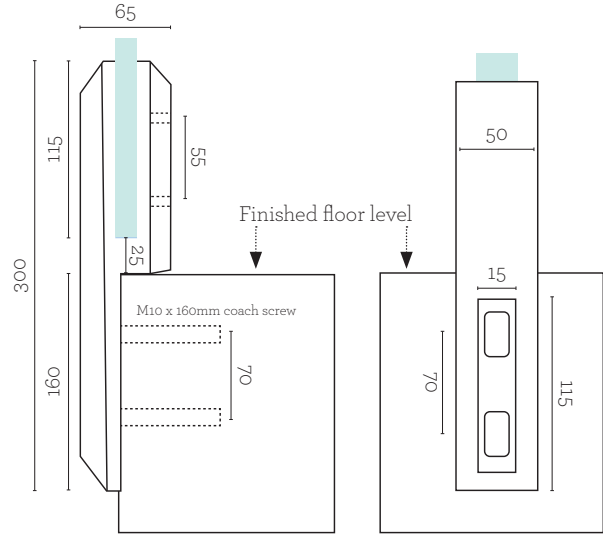

Side Mount Bracket - FRICTION
Polish Finish Order Code: SCESMS
Black Finish Order Code: SCESMS B

AORAKI SIDE MOUNT SPIGOT

Polish finish Duplex 2205 Stainless Steel

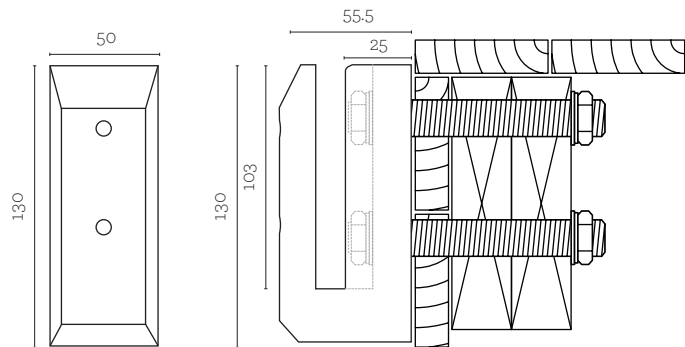

FACE MOUNTED Spigot - FRICTION FIT
Polish Finish Order Code: SCEFMS
Black Finish Order Code: SCEFMS B

SIDE MOUNT ADVANTAGES

- Made from stainless steel 2205
- Convenient alternative to standoffs
- Friction fitting side mount clamp
- Square shape with minimal visible fixings
- No holes in glass required
- Suits 12mm glass
- Quick and easy install

TEKAPO CORE DRILL SPIGOT

Duplex 2205 Stainless Steel



Polish Finish

Black Finish

CORE DRILL Spigot - FRICTION FIT
Polish Finish Order Code: SCECDS
Black Finish Order Code: SCECDS B

DRESS RING
Polish or Black Finish
 (Comes with the core drill spigot)

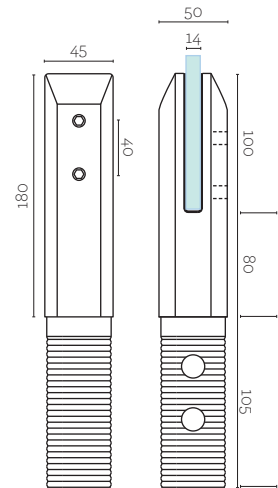

FIXINGS FOR ALL SPIGOTS

Timber Fixings:

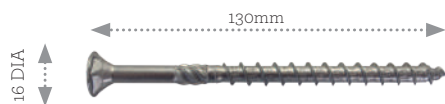

Countersunk Timber Screw 130mm Long

Stainless Steel 316 (Hex head drive)

Order Code: SCETCSK

- Self tapping 130mm length with M8 diameter screw
- Ideal for fixing Tekapo spigots onto a timber deck

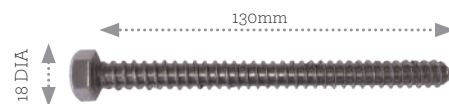

Coachscrew Timber Screw 130mm Long

Stainless Steel 316 (Hex head drive)

Order Code: SCETHX

- Self tapping 130mm length with M10 diameter screw
- Ideal for fixing Milford and Kaweka spigots onto a timber deck

Concrete Fixings:

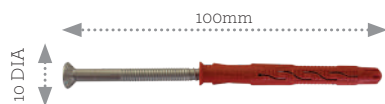

Countersunk Sleeve Concrete Screw 100mm Long

Stainless Steel 316 (Torx head drive)

Order Code: SCECCSK

- Self tapping 100mm length with 10mm outer; M8 diameter screw
- Ideal for fixing Tekapo spigots onto a concrete pad
- Pre-assembled for optimum handling and fastening quality

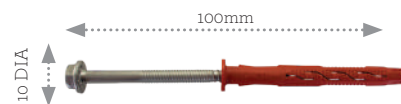

Collard Concrete Anchor 100mm Long

Stainless Steel 316 (Hex head drive)

Order Code: SCECHX

- Self tapping 130mm length with 10mm outer; M8 diameter screw
- Ideal for fixing Milford and Kaweka spigots onto a concrete pad
- Pre-assembled for optimum handling and fastening quality

Also other items such as Chemset and threaded rod available on request.

GLASS SUCTION CUPS



Suction Lifter For Glass - Single Cup Truper

Order Code: SCEGSHS

- Maximum load capacity 40kg
- Rubber cup ideal for handling glass plates

Suction Lifter For Glass - Double Cup Truper

Order Code: SCEGSHD

- Maximum load capacity 70kg
- Rubber cup ideal for handling glass plates

GATE HARDWARE: LATCHES & HINGES

GLASS-TO-GLASS LATCH KIT Polish finish Duplex 2205 Stainless Steel

Order Code: SCEHPGL

SPECIFICATION

- Full stainless steel side pull latch; Duplex 2205 stainless steel
- Friction latch for glass to glass 180 degree application
- Suits 8mm and 10mm glass gates
- Latch panel must be 12mm thick - No latch holes required
- Available in polish finish only

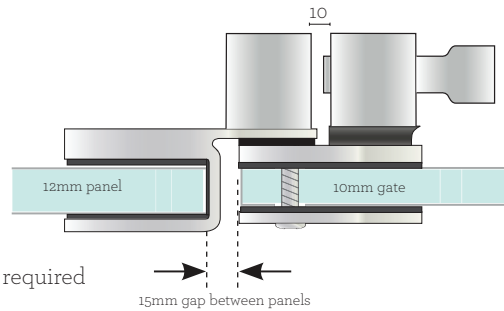

GLASS-TO-WALL/ SQUARE POST LATCH KIT Polish finish Duplex 2205 Stainless Steel

Order Code: SCEHPGWL

SPECIFICATION

- Full stainless steel side pull latch; 2205 stainless steel
- Suitable for application to wall or square posts
- Suits 8mm and 10mm glass gates
- Available in polish finish only



anonymous

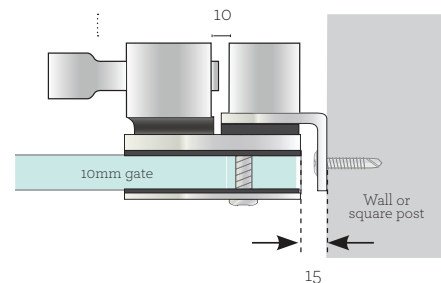

GLASS-TO-GLASS 90° LATCH KIT (external fit) Polish finish Duplex 2205 Stainless Steel

Order Code: SCEHPGL90EX

SPECIFICATION

- Side pull latch glass gate to 90 degree latch panel external fit
- Stainless steel backing plates and latch
- Suits 8mm and 10mm glass gates
- Latch panel must be 12mm thick - no latch holes required

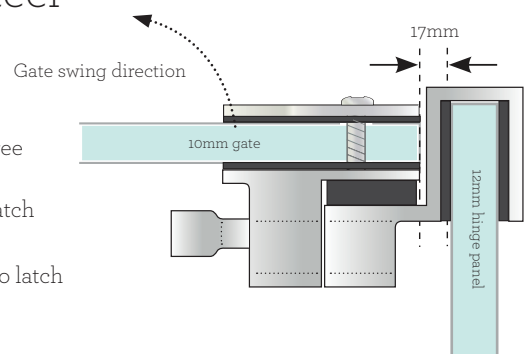

GLASS-TO-GLASS LATCH KIT

316 Stainless Steel & Polymer



Polish Finish Order Code: SCEGL
Black Finish Order Code: SCEGL B
Satin Finish Order Code: SCEGL S

SPECIFICATION

- Side pull latch
- FRICTION LATCH for glass to glass 180 degree application
- Stainless steel backing plates + D&D side pull polymer latch
- Suits 8mm and 10mm glass gate
- Latch panel must be 12mm thick - no latch holes required
- Available in polish finish backing plates

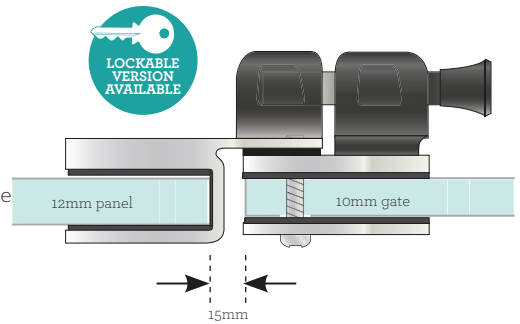

GLASS-TO-GLASS 90° LATCH KIT (external fit)

316 Stainless Steel & Polymer



Polish Finish Order Code: SCEGL90EX
Black Finish Order Code: SCEGL90EX B
Satin Finish Order Code: SCEGL90EX S

SPECIFICATION

- Side pull latch glass gate to 90 degree latch panel external fit
- Stainless steel backing plates + D&D side pull polymer latch
- Suits 8mm and 10mm glass gates
- Latch panel must be 12mm thick - no latch holes required

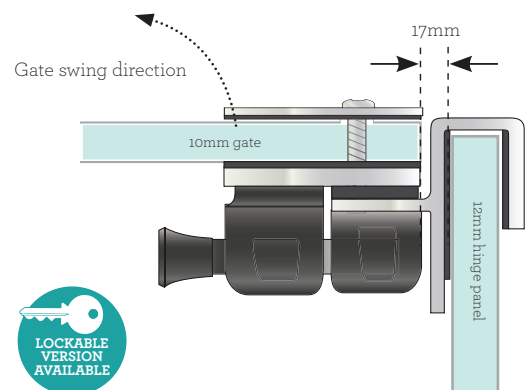

GLASS-TO-GLASS 90° LATCH KIT (internal fit)

316 Stainless Steel & Polymer



Polish Finish Order Code: SCEGL90IN
Black Finish Order Code: SCEGL90IN B
Satin Finish Order Code: SCEGL90IN S

SPECIFICATION

- Side pull latch
- Glass gate to wall/square post application
- Stainless steel backing plates + D&D side pull polymer latch
- Suits 8mm and 10mm glass glass gates
- Available in satin or polish finish backing plate
- Suits 'internal 90 degree' configuration

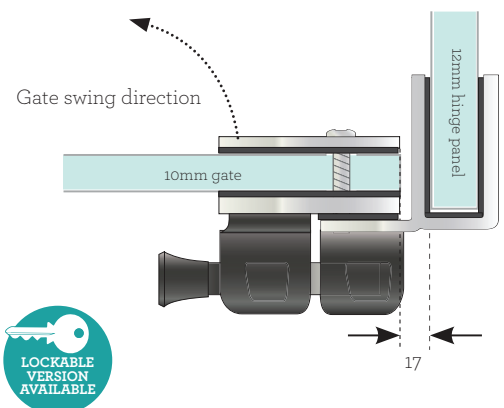

GLASS-TO-WALL/ SQUARE POST LATCH KIT

316 Stainless Steel & Polymer



Polish Finish Order Code: SCEGWL

Black Finish Order Code: SCEGWL B

Satin Finish Order Code: SCEGWL S

SPECIFICATION

- Side pull latch glass gate to 90 degree latch panel internal fit pull polymer latch
- Stainless steel backing plates + D&D side
- Suits 8mm and 10mm glass gates
- Latch panel must be 12mm thick - no latch holes required
- Available in polish finish backing plate

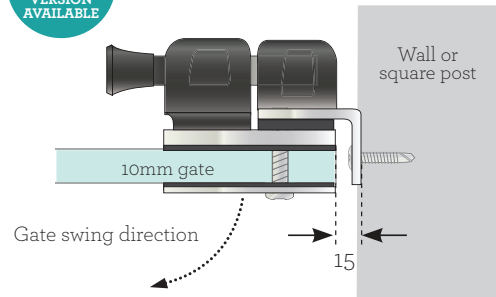

POLARIS SOFT CLOSING GLASS-TO-GLASS HINGE

120 Series Pool Hinge



Polish Finish
Order Code: SCEPHGG



Black Finish
Order Code: SCEPHGG B

SPECIFICATION

- 2205 grade stainless steel
- Self closing pool fence compliant safety hinge
- Suits 10 or 12mm thick glass gates (max 45kg)
- Polish or Matt Black finish
- Sleek New Look
- Revolutionary Anti-Drop Gate Packing system which lowers the chance of the gate dropping.

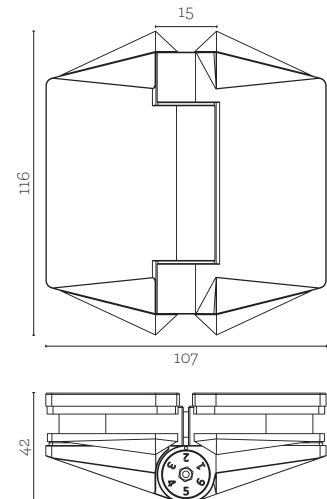

Easy swing tension adjustment with allen key

GLASS-TO-WALL/SQ. POST HINGES (set of 2)

Polish finish Duplex 2205 Stainless Steel



Order Code: SCEHPGWHS

SPECIFICATION

- Glass gate to wall or square post application
- Suits 8 and 10mm glass gates
- Stainless steel Duplex 2205
- Available in polish or satin finish
- Cone cap incorporated to prevent 'toe hold'

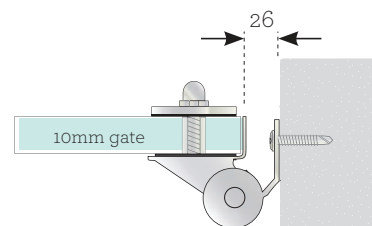

GLASS-TO-GLASS HINGES (set of 2)

Duplex 2205 Stainless Steel



Polish Finish Order Code: SCEPHPS
Satin Finish Order Code: SCEPHPS S
Black Finish Order Code: SCEPHPS B

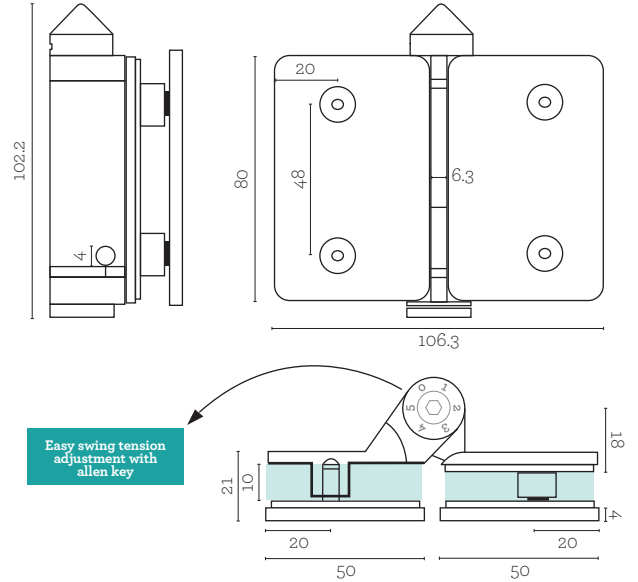

SPECIFICATION

- Glass gate to glass hinge panel
- Stainless steel Duplex 2205
- Suits 8 and 10mm glass gates
- Available in polish finish
- Cone cap incorporated to prevent 'toe hold'
- Includes solid stainless 2205 backing plates for a premium finish

POLARIS 125 SERIES GLASS-TO-WALL HINGES (set of 2)

Duplex 2205 Stainless Steel



Polish Finish
 Order Code: SCEPHGW



Black Finish
 Order Code: SCEPHGW B

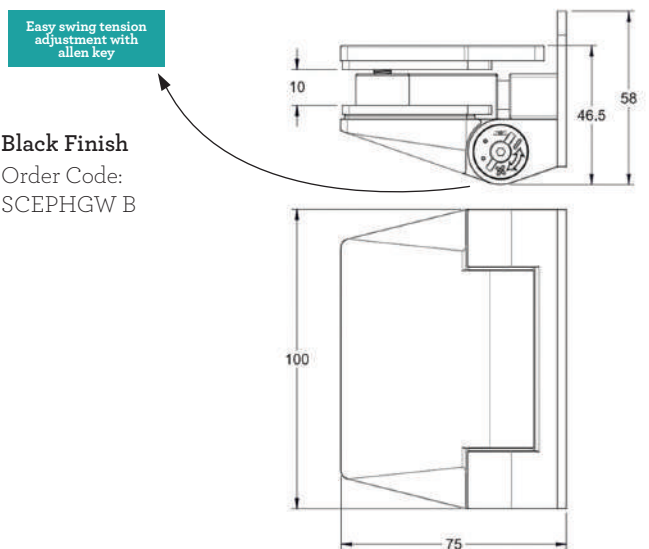

SPECIFICATION

- 2205 grade stainless steel
- Self closing pool fence compliant safety hinge
- Suits 10 or 12mm thick glass gates (max 45kg)
- Polish or Matt Black finish
- Sleek new look
- Revolutionary Anti-Drop Gate Packing system which lowers the chance of the gate dropping.

CLAMPS & HANDRAILS

- Contemporary rigidity brackets that are “friction fit” – the glass panels do not require pre-drilled holes.
- All are suitable for 12mm glass.

SMALL RIGI CLAMP

316 Stainless Steel

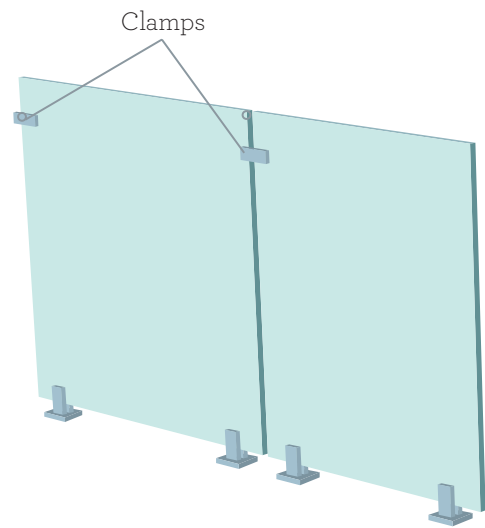
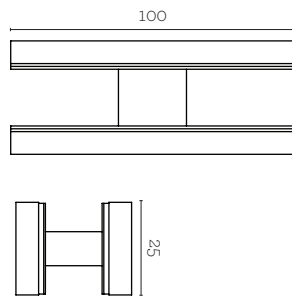

Polish Finish Order Code: SCEGGS
Black Finish Order Code: SCEGGS-B

- Tightens with an allen key
- Gap between panels: min 18mm / max 40mm

LARGE RIGI CLAMP

316 Stainless Steel

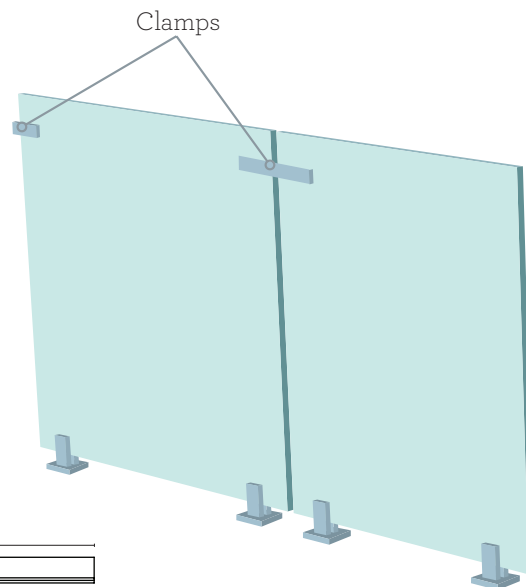
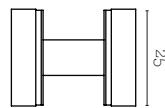

Polish Finish Order Code: SCEGGL
Black Finish Order Code: SCEGGL-B

- Tightens with an allen key
- Gap between panels:
min 40mm / max 70mm

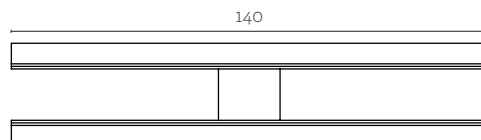

90° RIGI CLAMP

316 Stainless Steel

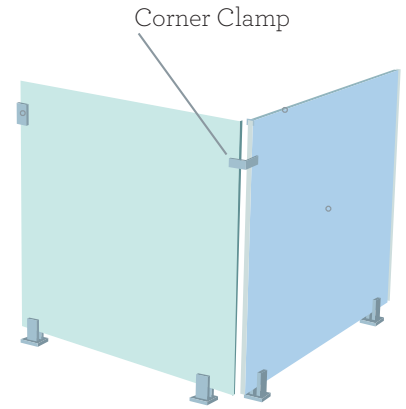
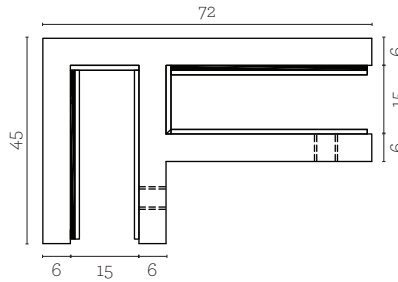

Polish Finish Order Code: SCEGG90
Black Finish Order Code: SCEGG90-B

90° HEAVY DUTY CORNER CLAMP

316 Stainless Steel

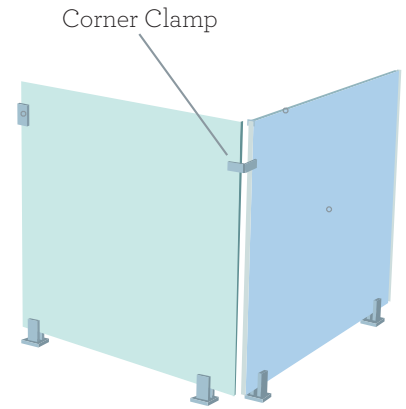
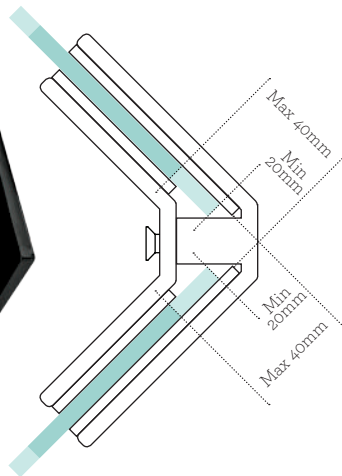

Polish Finish Order Code: SCEGG90HD
Black Finish Order Code: SCEGG90HD-B

WALL RIGI CLAMP

316 Stainless Steel



Polish Finish Order Code:
 SCEGWV (Vertical)
 SCEGWH (Horizontal)
Black Finish Order Code:
 SCEGWV B (Vertical)
 SCEGWH B (Horizontal)

- Adjustable with allen key
- Counter sunk screw holes

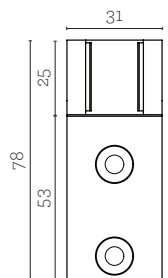
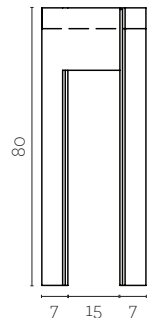
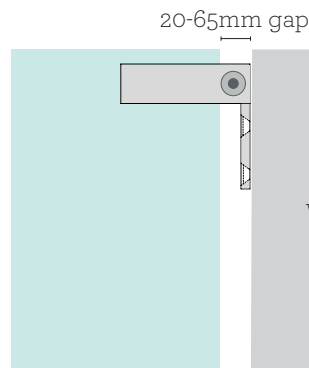

HEAVY DUTY WALL CLAMP

316 Stainless Steel

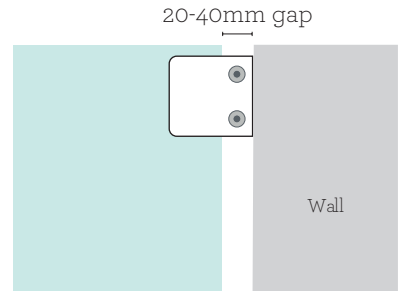
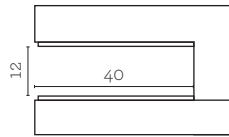
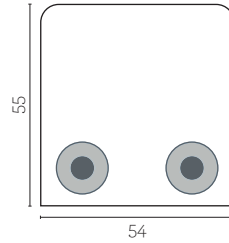

Polish Finish Order Code: SCEGWHD
Black Finish Order Code: SCEGWHD-B

- Adjustable with allen key
- Counter sunk screw holes

SWIVEL RIGI CLAMP

316 Stainless Steel

VARIABLE ANGLE

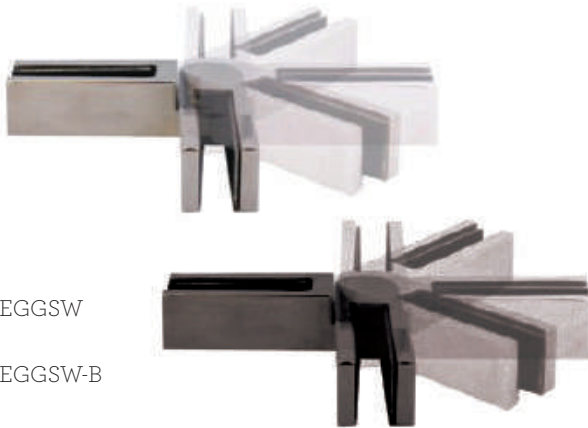

Polish Finish
 Order Code: SCEGGSW

Black Finish
 Order Code: SCEGGSW-B

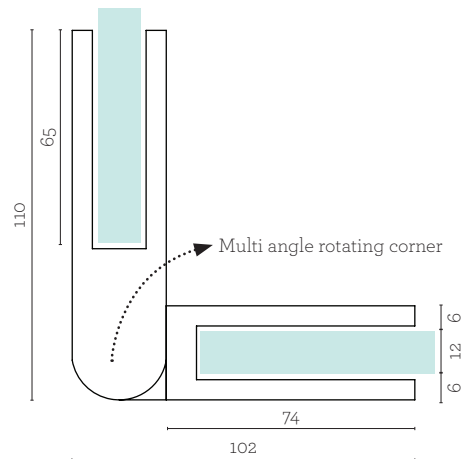

HANDRAIL – 5800mm x 25mm x 21mm

316 Stainless Steel

Polish Finish

SLIMLINE RAIL



Black Finish

COMPLIANT WITH
 NZS4223:2016 and F4

Polish Finish Order Code: SCEHR5,8 OR 2.9
Black Finish Order Code: SCEHR5,8 OR 2.9 B

SPECIFICATION

- Slimline stylish profile - caps over 12mm thick glass
- 1.2mm wall thickness
- 14 x 14mm glazing pocket: silicone onto glass or use in conjunction with glazing rubber
- To be compliant with NZS4223:2016 - Approved Balustrade Handrail

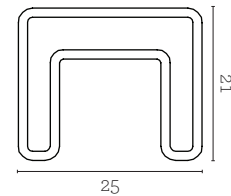
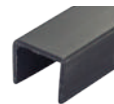

180° CONNECTOR – 25mm x 21mm

316 Stainless Steel

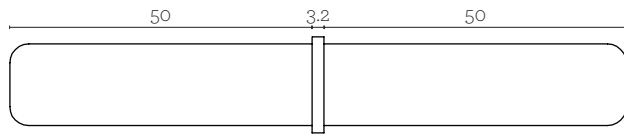

Polish Finish

Order Code: SCEHR180

Black Finish

Order Code: SCEHR180-B

SPECIFICATION

- In-line rail joiner
- Easy to use tap-in fitting; allows for increased speed of assembly
- Stainless Steel 316
- Friction fitting or epoxy can be used

90° CONNECTOR – 25mm x 21mm

316 Stainless Steel

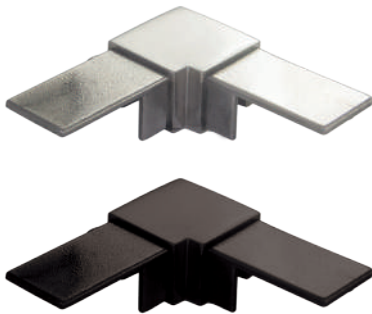

Polish Finish Order Code: SCEHR90

Black Finish Order Code: SCEHR90-B

SPECIFICATION

- 90 degree corner joiner ; easy to use tap-in fitting
- Stainless Steel 316
- Epoxy glue or drill/tap tube for joining strength

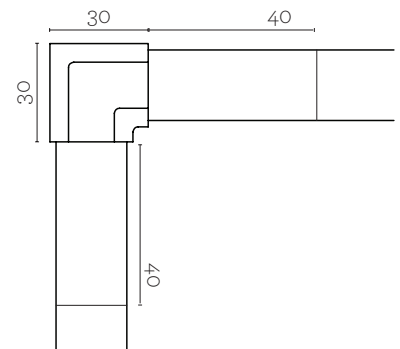

HANDRAIL SWIVEL VERTICAL CORNER JOINER LEFT AND RIGHT

316 Stainless Steel



Polish Finish Order Code: SCEHRSCJL

Black Finish Order Code: SCEHRSCJL-B

LEFT SPECIFICATION

- Variable angle corner joiner
- From straight rail, achieve up to 90 degrees left angle joining
- Epoxy glue, weld or drill/top tube for joining strength

Polish Finish Order Code: SCEHRSCJR

Black Finish Order Code: SCEHRSCJR-B

RIGHT SPECIFICATION

- Variable angle corner joiner
- From straight rail, achieve up to 90 degrees right angle joining
- Epoxy glue, weld or drill/top tube for joining strength

SWIVEL HORIZONTAL CONNECTOR

316 Stainless Steel

VARIABLE ANGLE



Polish Finish Order Code: SCEHRH
Black Finish Order Code: SCEHRH-B

SPECIFICATION

- Variable angle horizontal joiner
- From straight rail, achieve up to 90 degrees left or right angle joining
- Epoxy glue or drill/top tube for joining strength

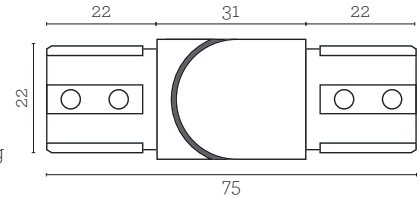

SWIVEL VERTICAL CONNECTOR

316 Stainless Steel

VARIABLE ANGLE



Polish Finish Order Code: SCEHRV
Black Finish Order Code: SCEHRV-B

SPECIFICATION

- Variable angle vertical joiner
- From straight rail, achieve up to 45 degrees upwards and downwards
- Ideal for staircase installation

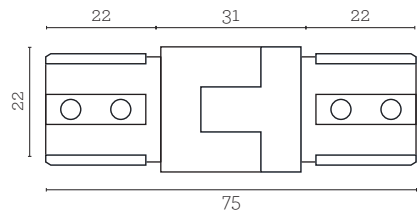

END CAP – 25mm x 21mm

316 Stainless Steel



Polish Finish Order Code: SCEHREC
Black Finish Order Code: SCEHREC-B

SPECIFICATION

- End cap; easy to use tap-in fitting
- Stainless Steel 316
- Epoxy glue or drill/tap tube for joining strength

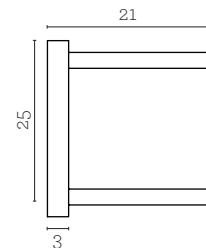

WALL PLATE – 25mm x 21mm

316 Stainless Steel



Polish Finish
 Order Code: SCEHRWC
Black Finish
 Order Code: SCEHRWC-B

SPECIFICATION

- Bracket can be affixed to wall/post
- 25 x 21mm tube fits into opening (female fit)
- Stainless Steel 316
- Grub Screw for joining strength

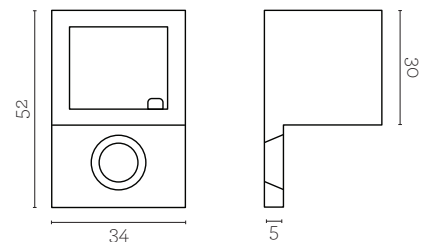



ALUMINIUM FENCING & SCREEN SYSTEMS



BelAire[®]
DESIGNER FENCING

...make it your own!

**BELAIRE
SLAT FENCING
IS F9 COMPLIANT FOR
RESIDENTIAL SWIMMING
POOLS WHEN:**

Fence is at least 1.8m high
Fence composed of horizontal slats

Gaps between slats are
less than 10mm

Gap under fence is
less than 100mm





BelAire slats between BelAire Signature posts.

BelAire[®]
DESIGNER FENCING

...make it your own!

ALUMINIUM FENCING & SCREEN SYSTEMS

COST-EFFECTIVE

BelAire slat and louvre fencing is a great cost-effective option where a degree of privacy and security is required.

BUILT TO LAST

Our powder-coated aluminium posts, channels and slats are very light, structurally very strong, and are supplied to you in a colour (or combination of colours) of your choice.

It is important to note that our fencing, with 25mm wide slats, is superior in strength to some inferior fencing with 15mm wide slats.

EASY INSTALLATION

Our slat and louvre fencing is designed to be assembled with ease. The posts can be concreted into post holes, or attached to existing walls or posts. BelAire slat fencing panels can be easily handled by two people, making them perfect for difficult-to-access areas such as back yards or annexed ground.

We provide step by step self-install instructions that any competent DIY person should be able to follow, but if you'd rather get someone else to install it, we have a list of preferred installers throughout NZ. Call us on 0800 235 2473 and we will put you in touch with an installer in your area.

WARRANTY

New Zealand-made and 10 year warranty information. Be assured that with very little maintenance your fence will give you great privacy and security for many years to come. Only the finest raw materials have been used in the construction of your fence. The suppliers of these raw materials state that they have a design life well in excess of 20 years. With this assurance we offer you a replacement warranty for any component of your new fencing if it fails within 10 years* from date of purchase.



*2yr Warranty within a 1500m sea spray zone.

Kotuitui Development

After Ace Landscapes installed traditional timber fences for Kāinga Ora homes' Kotuitui development they could see how it could degrade after a few weeks. Then they came across BelAire Designer Fencing's Aluminium Slat fencing range, provided them a good, strong, and low maintenance system that would look great for many years.

Project Specifications:

Vertical Slats Fencing

1200, 1500 and 1800mm high

Flush Capping, Slatted Bays and Solid Bays

85 x 25mm used to create open slats with closed areas of 60 x 60mm posts. Bay widths varied from 1800 - 2400mm

Colour

Flax (matches Dulux Flaxpod)

Before



After



Dominion Construction

Being situated in the centre of New Zealand's busiest CBD, on Princess Street, the architects wanted a product that was robust, strong and looked great. Our perfect solution was to supply and install the BelAire Slat fencing system which enhanced the project and caused little disturbance to the site.

Project Specifications:

Aluminium Slat

2400mm high

Flush Capping, Slatted Bays and Solid Bay

Slat panels between engineered 150 x 100mm, with 15mm Gaps

Aluminium Flange plated posts, 54m with 3 Gates

Colour

Ebony (Black)



Matarangi Slat Fencing

With such a modern stylish looking house, the Aluminium Slats were a perfect complimentary look. The matching gates, along with their full automation functionality allow the customer to easily access his boat, house and garden exactly as requested.

Project Specifications:

Horizontal Slats Fencing

Ranging between 1900mm to 1600mm high

Flush Capping and Slatted Bays

85x25mm Aluminium Slats between
90x90mm Aluminium Flange posts fixed to
concrete nib/Timber decking

Colour

Black

“When we approached BelAire Designer Fencing, we were after a fencing solution that would look good and enhance the overall look of our house and the property. The fencing system also needed to be low maintenance, durable and cost effective. BelAire fit perfectly with all our criteria. BelAire overall advice, service and project communications were excellent. Considering the customisation required for the tricky site, the installation of the fence and gates went smoothly. Thank you BelAire”

Tadek G





Why Choose BelAire Slat Fencing?

See below our strength test of the BelAire 85 x 25 mm slat. What super strength was proven in this test when we loaded 69.3kgs onto the 85 x 25mm slat spanning 2400mm. The 65 x 16mm slat took a mere 30kgs before it crumpled to the ground. You will see in the bow in the pictures below that the BelAire Slat had a similar bow but not as much as the 65mm slat with only 25.2kgs loaded to it.

KEY FEATURES

- No Twisting, Warping, Rotting
- Looks the same as the day it was installed for many years
- Already finished to a colour of your choice
- Simple Install
- Customizable and versatile to suit any landscape
- Horizontal or Vertical options
- Lightweight but very Durable
- Low Maintenance
- Modern Sleek look
- Adjustable gaps to suit your privacy needs

BELAIRE SLAT vs TRADITIONAL 65 X 16MM SLAT



SLAT FENCING

Post dimensions: 60 x 60mm or 90 x 90mm, 2mm BMT

Slat thickness: 25mm

Suitable for fence heights: 900mm - 2400mm

Post centres: 2400mm, 2700mm, 3000mm

BelAire slat fencing is fully customisable. If there's a particular size or configuration you require, call us on 0800 235 2473 and we'll custom-make a fence just for you.

POWDER-COAT COLOURS



Titania Gull Grey Slate Grey Grey Friars Ironsand Ebony Flax

STANDARD COLOUR RANGE FOR 85mm SLATS (BEST PRICES)

You can choose the same colour for your posts, channels and slats, or any combination you wish!

We can also powdercoat the slats to any of the colours in the Dulux powdercoating chart, found at: www.duluxpowdercoatings.co.nz

SLATS

Slat construction:

- 85mm x 25mm (standard stocked size)
- 60mm x 25mm (available on request)
- 1.6mm powder-coated aluminium

It is important to note that our fencing, with 25mm wide slats, is superior in strength to some inferior fencing with 16mm wide slats.

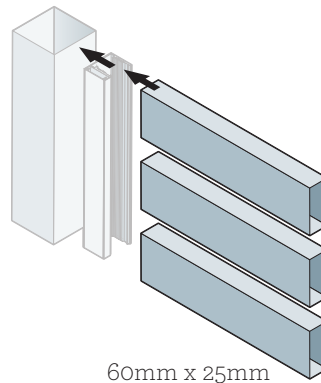

60mm x 25mm

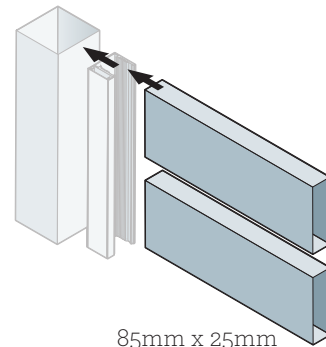

85mm x 25mm

Refer to www.belairefencing.co.nz/aluminium-slat-fencing/ for Slat testing examples

SLAT FENCING CHANNEL

Construction:

Powder-coated aluminium.

Channel: 39mm x 32mm (includes sliding screw cover plate)

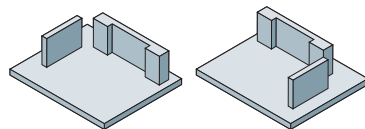

Left and right channel caps available in Gull Grey or Black

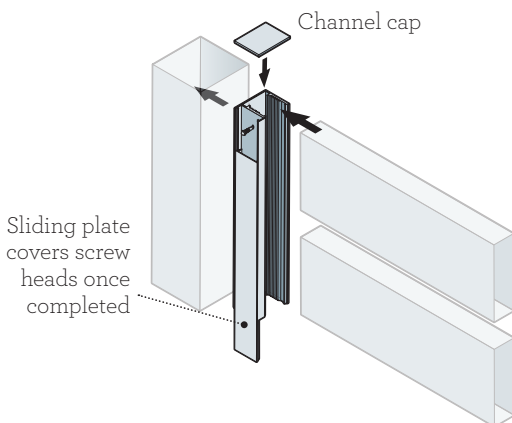

Sliding plate covers screw heads once completed

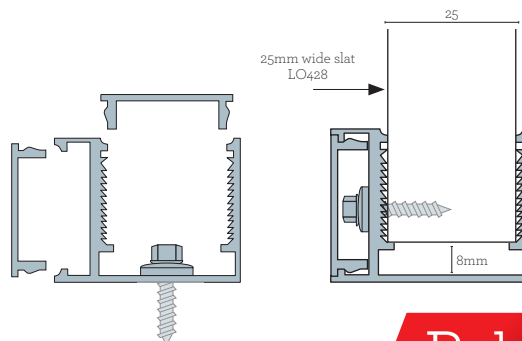

SLATS

Available in two heights - 85mm is our standard stocked size, and 60mm slats are available on request. The two types of slats can be used exclusively, or combined in any way you choose. Both can also be used either horizontally or vertically.

2330mm (length) x 85mm (height) x 25mm (width)

2630mm (length) x 85mm (height) x 25mm (width)

2930mm (length) x 85mm (height) x 25mm (width)

2330mm (length) x 60mm (height) x 25mm (width)

2630mm (length) x 60mm (height) x 25mm (width)

2930mm (length) x 60mm (height) x 25mm (width)

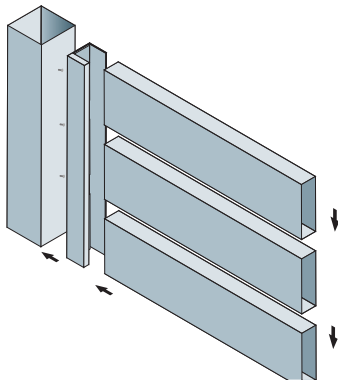

All 85mm horizontal slats

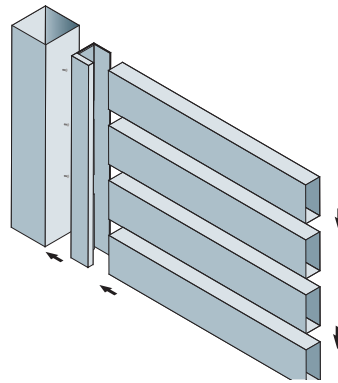

All 60mm horizontal slats

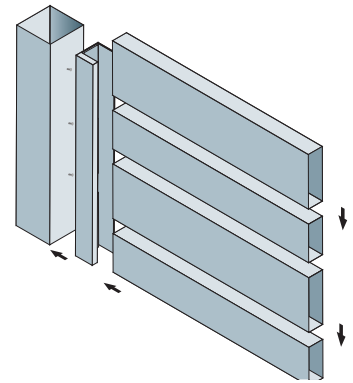

85mm and 60mm horizontal slats

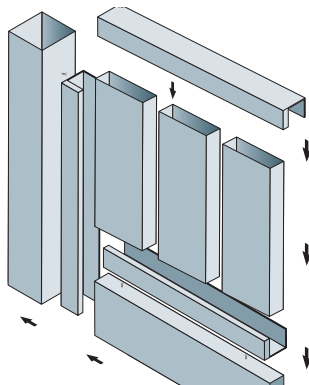

All 85mm vertical slats

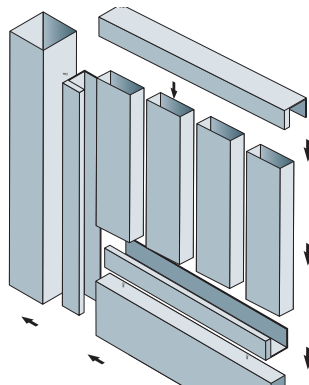

All 60mm vertical slats

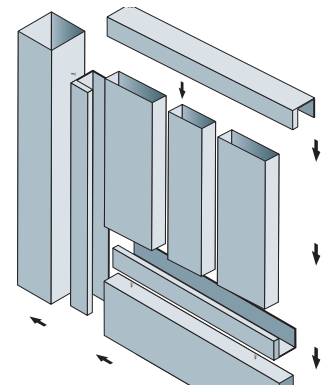

85mm and 60mm vertical slats

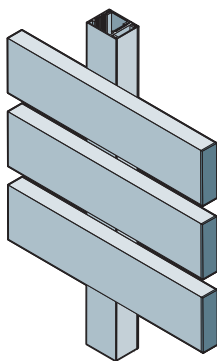

All 85mm with slat caps, mounted horizontally onto channel

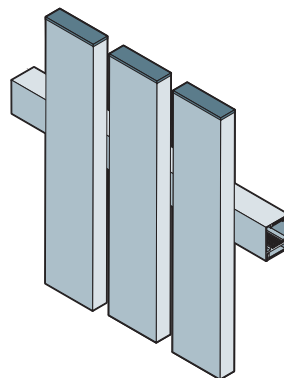

All 85mm with slat caps, mounted vertically onto channel

85mm slat caps available in grey or black

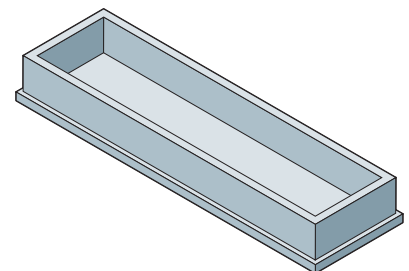

SLAT FENCING

SLATS

Both slat and louvre fencing is supplied with 60mm x 60mm in-ground posts as standard.

The following posts are available as options:

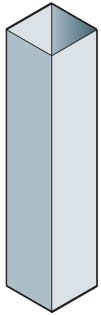

60mm x 60mm
in-ground post

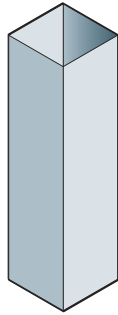

90mm x 90mm
in-ground post

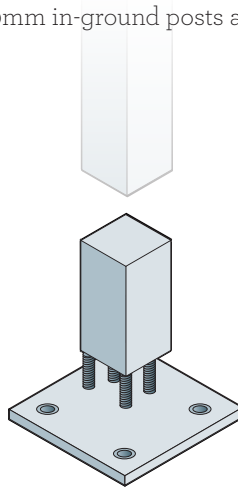

60mm x 60mm
flanged fixing
(post slides
onto fixing)

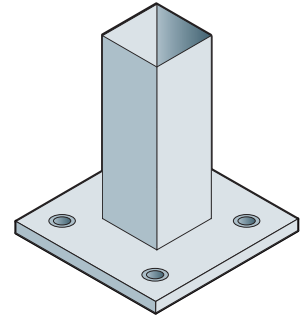

90mm x 90mm
welded flanged post



LOUVRE FENCING

Louvre sizes:

2400mm (length) x 136mm (height) x 32mm (width)

to suit 2400mm panels

2700mm (length) x 136mm (height) x 32mm (width)

to suit 2700mm panels

3000mm (length) x 136mm (height) x 32mm (width)

to suit 3000mm panels

**BelAire louvre fencing
is fully customisable.
If there's a particular size or
configuration you require, call
us on 0800 235 2473
and we'll custom-make
a fence just for you.**

You can choose the same colour for your posts, channels and slats, or any combination you wish!

**We powdercoat the louvres to any of the colours in the Dulux powdercoating chart, found at:
www.duluxpowdercoatings.co.nz**

LOUVRE FENCE PANELS

Louvre fence height options:

350mm (3 louvres)

600mm (5 louvres)

900mm (8 louvres)

1200mm (10 louvres)

1500mm (13 louvres)

1800mm (15 louvres)

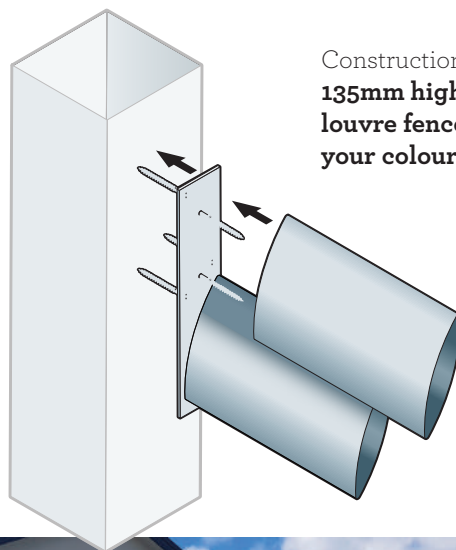

Construction:

**135mm high aluminium aerofoil
louvre fence powder-coated to
your colour choice.**



TONGUE & GROOVE PANELS

Post dimensions: 60mm (deep) x 60mm (face) 2mm BMT

Slat thickness: 14.8mm

Suitable for fence heights: 900mm - 2400mm

Post centres: 2400mm, 2700mm, 3000mm

BelAire tongue & groove panels are fully customisable. If there's a particular size or configuration you require, call us on 0800 235 2473 and we'll custom-make a fence just for you.

Construction:

1.6mm aluminium T&G with a 60 mm x 60mm frame.

Tongue & groove dimensions:

- 14.8mm (width) x 84.38mm (height) 80mm cover

Vertical & horizontal options available

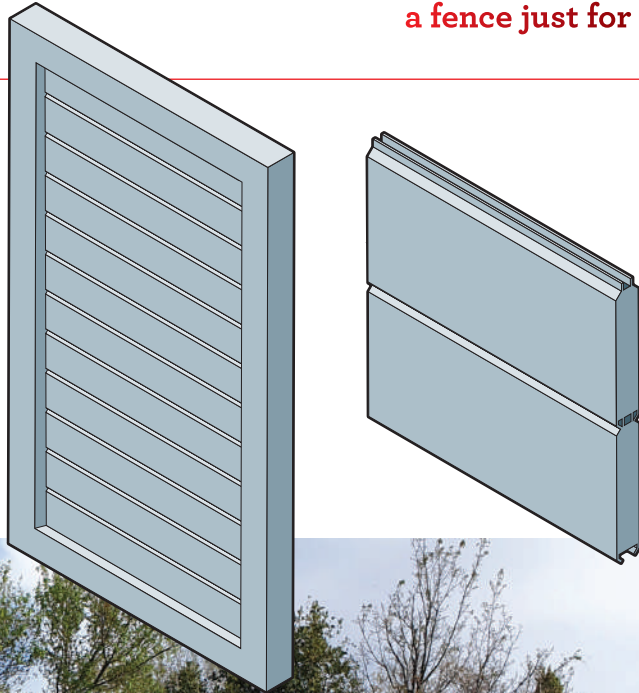



GATES



BelAire[®]
DESIGNER FENCING

...make it your own!



SLAT GATES

Height: 1200mm - 2100mm

Pedestrian Gate Width: 800mm - 2500mm

Driveway Swing Gate Width: 800mm - 2500mm

Driveway Sliding Gate Width: 2500mm - 6000mm

Colour: Client's choice of any Dulux powdercoat colour

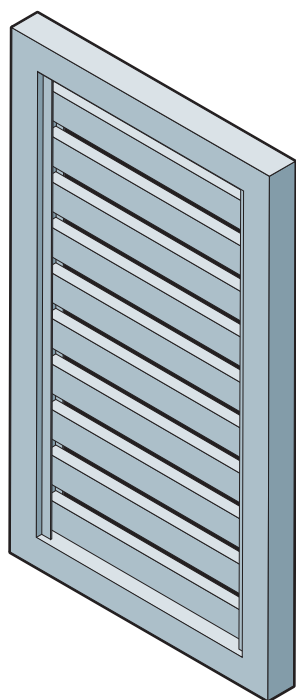

Height: 1200mm, 1500mm and 1800mm

Pedestrian Gate Width: Up to 1000mm

Powder-coat colours:



Titania



Gull Grey



Slate Grey



Grey Friars



Ironsand



Flax



Ebony



Construction:

Powdercoated aluminium.

Slat dimensions:

- Standard 85mm (height) x 25mm (width)
- Custom 60mm (height) x 25mm (width)

Also available in vertical slats.

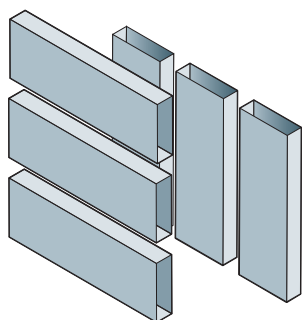

All gates come with a 60mm x 60mm aluminium frame as standard unless stated otherwise.

For larger sliding gates we use a 100mm high x 60mm width bottom rail for strength and a 60mm x 60mm surround frame.



ECO SLAT GATE KIT

Height: 1200mm, 1500mm and 1800mm

Pedestrian Gate Width: Up to 1000mm

Powder-coat colours:



Titania



Gull Grey



Slate Grey



Grey Friars



Ironsand



Flax



Ebony

Introducing our new, economical, cut-to-size, kitset slat gate

Supplied in kit form as:
Two 1200mm channels and 12 x 1000mm wide slats (85mm x 25mm), or
Two 1500mm channels and 15 x 1000mm wide slats (85mm x 25mm), or
Two 1800mm channels and 18 x 1000mm wide slats (85mm x 25mm)

Gates also include 2 x Stainless steel Butt hinges, and a Viper Gravity latch (lockable from both sides)
Simply assemble your gate - the sliding plate covers will cover the screws to provide a professional finish.

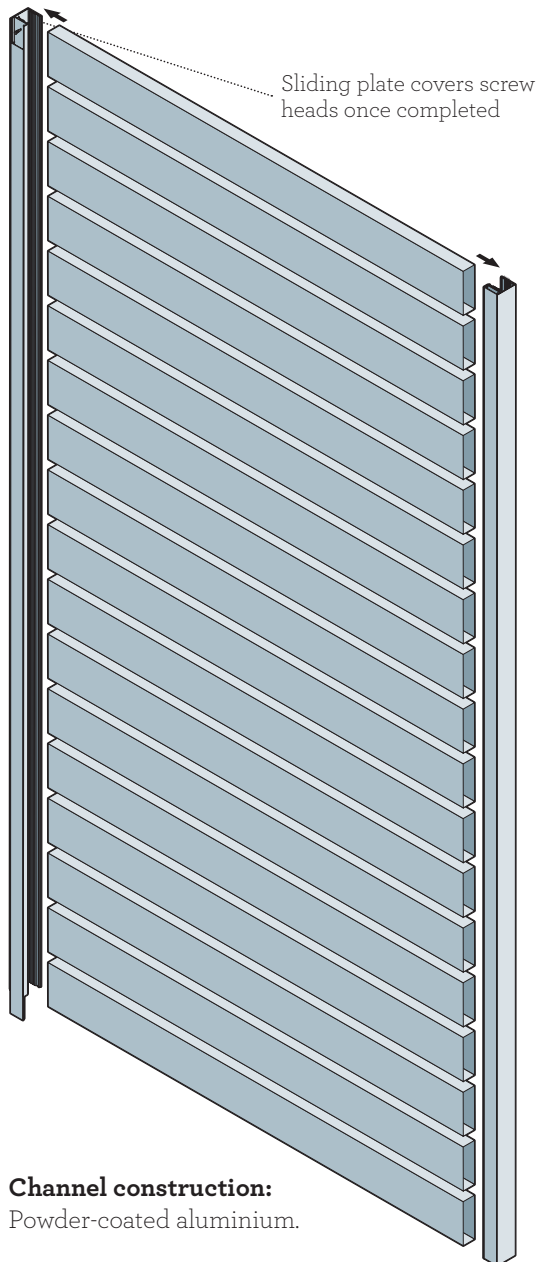

Channel construction:
Powder-coated aluminium.

Channel: 39mm x 32mm
(includes sliding screw cover plate)



Above:

Double Eco Slat Gate Kits shown,
cut down in height to 1485mm (15 slats)

Slat construction:

85mm x 25mm
1.6mm powder-coated aluminium

It is important to note that our gates with 25mm wide slats are superior in strength to some inferior walls with 16mm wide slats.

LOUVRE GATES

Height: 1200mm - 2100mm

Pedestrian Gate Width: 800mm - 2500mm

Driveway Swing Gate Width: 800mm - 2500mm

Driveway Sliding Gate Width: 2500mm - 6000mm

Colour: Client's choice of any Dulux powdercoat colour

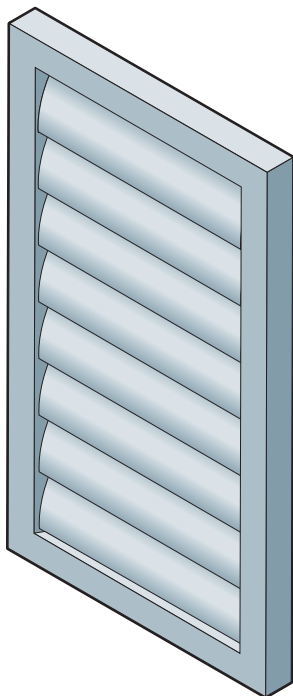

Construction:

Powdercoated aluminium.

Louvre dimensions:

- 135mm (height) x 30mm (width)

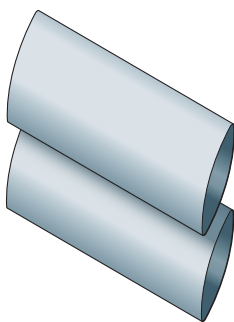

All gates come with a 60mm x 60mm aluminium frame as standard unless stated otherwise.

For larger sliding gates we use a 100mm high x 60mm width bottom rail for strength and a 60mm x 60mm surround frame.



SOLID GATES

Height: 1200mm - 2100mm

Pedestrian Gate Width: 800mm - 2500mm

Driveway Swing Gate Width: 800mm - 2500mm

Driveway Sliding Gate Width: 2500mm - 6000mm

Colour: Preprimed and ready for painting

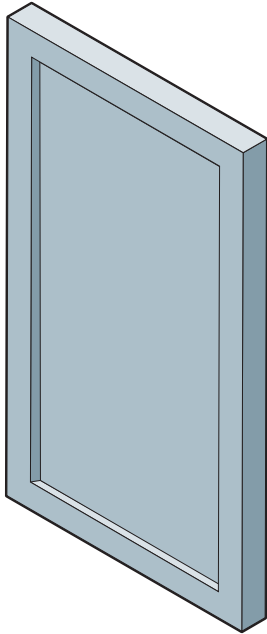

Construction:

0.55mm preprimed steel outer skins.
13mm expanded polystyrene core.
Welded Aluminium frame.

Panel dimensions:

- Up to 1200mm (wide)
x 2100mm (width)

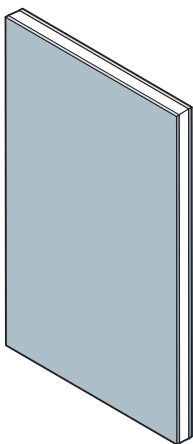

TUBULAR GATES

Height: 1200mm - 2100mm

Pedestrian Gate Width: 950mm

Driveway Swing Gate Width: 1000mm - 2300mm

Driveway Sliding Gate Width: 2300mm - 6000mm

Horizontal rails: 40mm x 40mm | **Vertical bars:** 19mm x 19mm

Stile size: 50mm x 50mm, 60mm x 60mm

Colour: Powder-coated black as a standard colour or custom colour of choice at extra cost

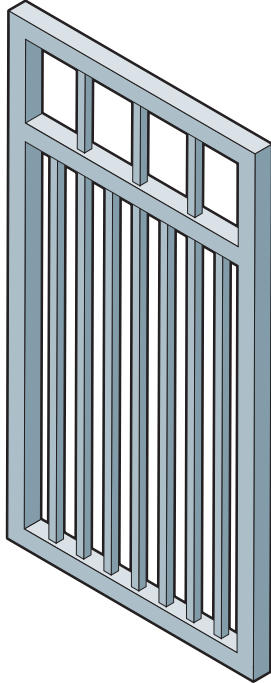

Construction:

2mm aluminium.

Rail dimensions:

- 40mm (width) x 40mm (depth)

Picket dimensions:

- 19mm (width) x 19mm (depth)

It is important to note that our 'square cross section' tubular gates are superior in strength to some inferior, 'round cross section' gates.

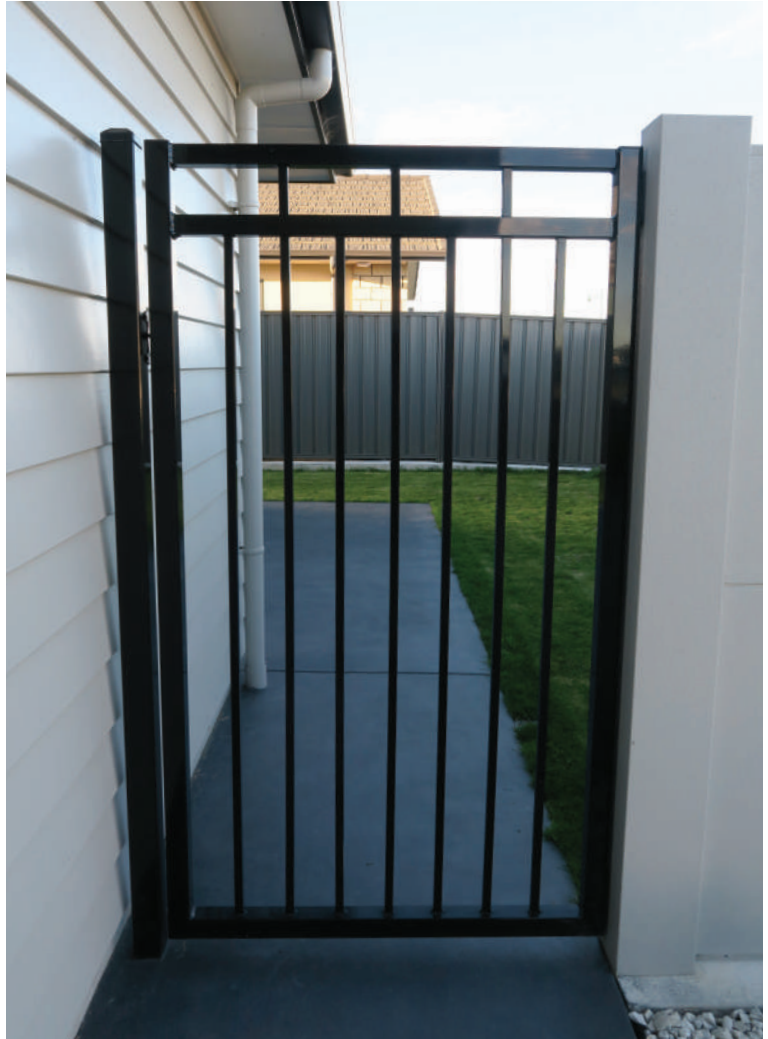
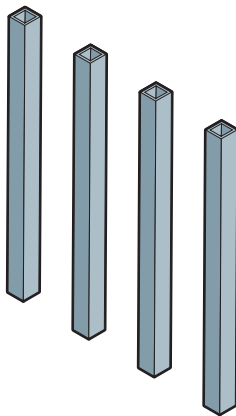

TONGUE & GROOVE GATES

Height: 1200mm - 2100mm

Pedestrian Gate Width: 800mm - 2500mm

Driveway Swing Gate Width: 800mm - 2500mm

Driveway Sliding Gate Width: 2500mm - 6000mm

Colour: Client's choice of powdercoat colour

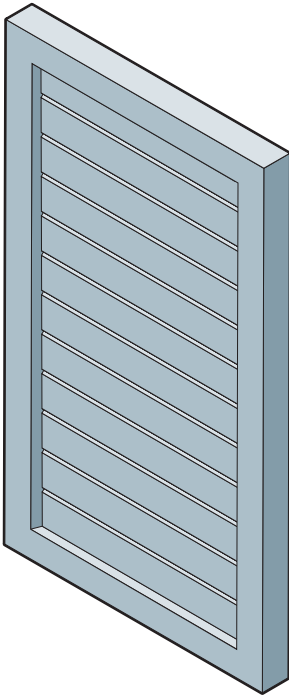

Construction:

1.6mm aluminium T&G with a 60 mm x 60mm frame.

Tongue & groove dimensions:

- 14.8mm (width) x 84.38mm (height)
80mm cover

Vertical & horizontal options available

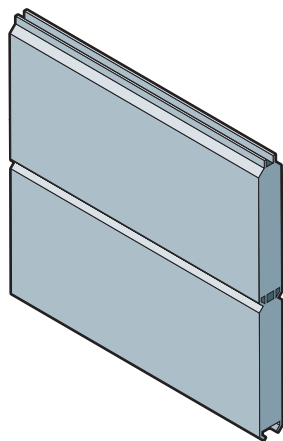

All gates come with a 60mm x 60mm aluminium frame as standard unless stated otherwise.

For larger sliding gates we use a 100mm high x 60mm width bottom rail for strength and a 60mm x 60mm surround frame.



SLIDING GATES

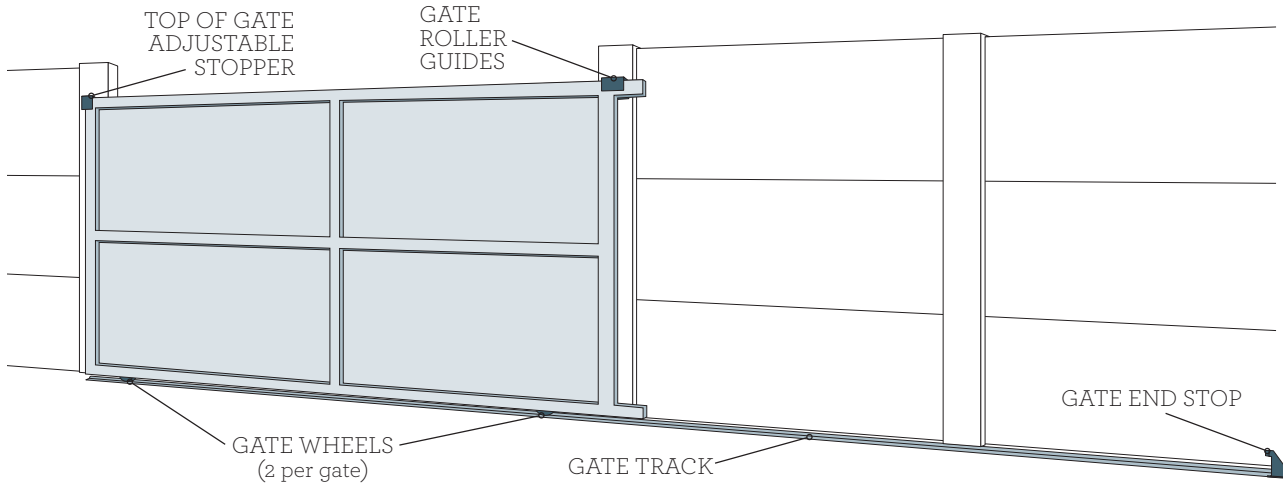

GATE ROLLER GUIDE

Heavy Duty 2.4mm Steel



Order Code: BELTRB

SPECIFICATION

- Heavy duty top gate support roller
- Powdercoated black

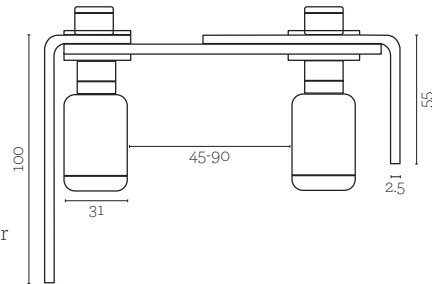

TOP OF GATE ADJUSTABLE STOPPER

Heavy Duty 2.4mm/8mm Steel



Order Code: BELGS

SPECIFICATION

- Fully adjustable end catch
- Heavy duty
- Powdercoated black

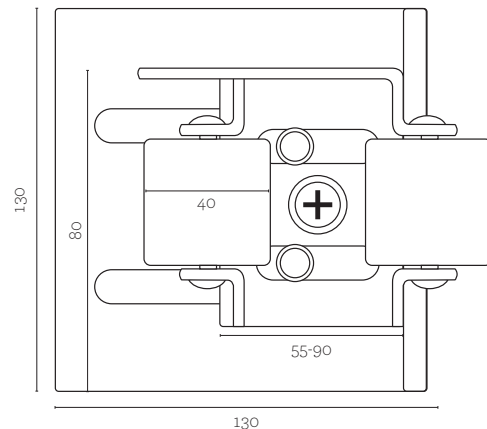

GATE TRACK

Heavy Duty 3mm Galvanised Steel



Order Code: BELGT

SPECIFICATION

- Heavy duty galvanised gate track
- Fittings excluded

Supplied in 3m long lengths

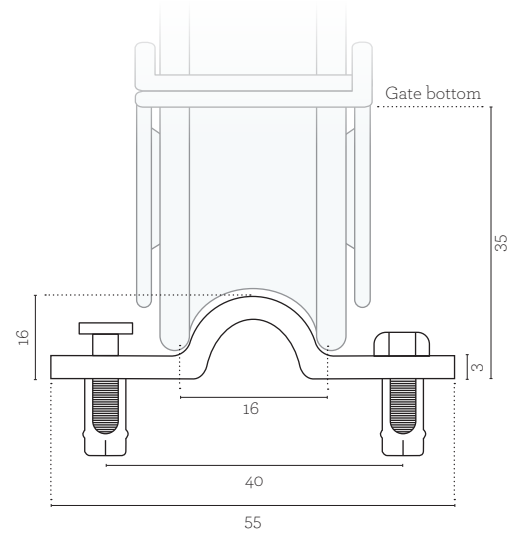

GATE WHEELS

Heavy Duty Steel



Order Code: BELSGW

SPECIFICATION

- Heavy duty up to 300kg
- Powercoated black

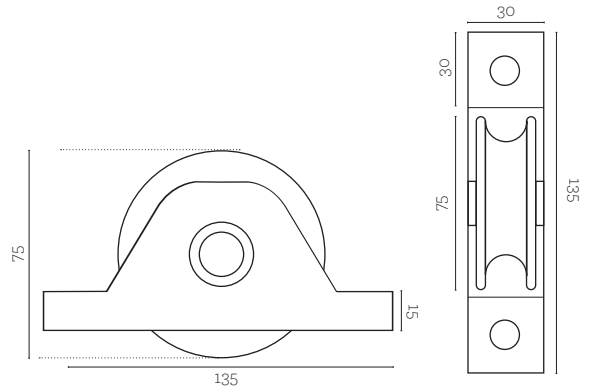

GATE END STOP

Heavy Duty 8mm Steel



Order Code: BELGES

SPECIFICATION

- Rigid bolt down
- Powercoated black

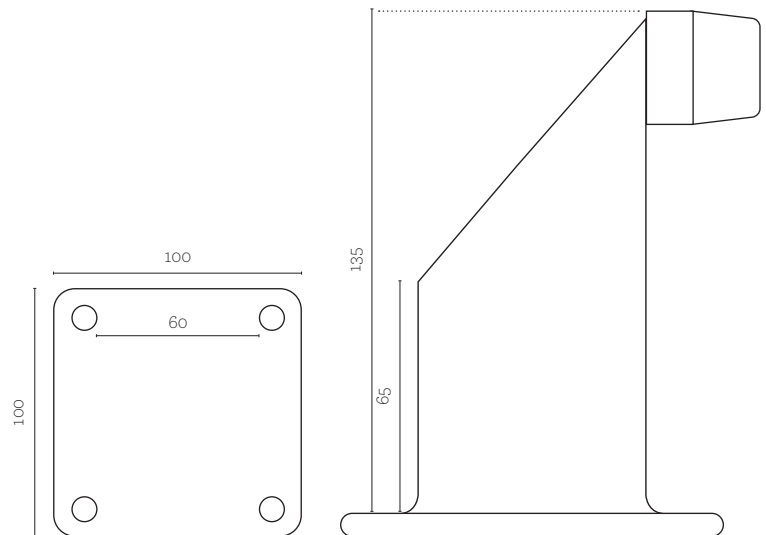

HINGED GATES

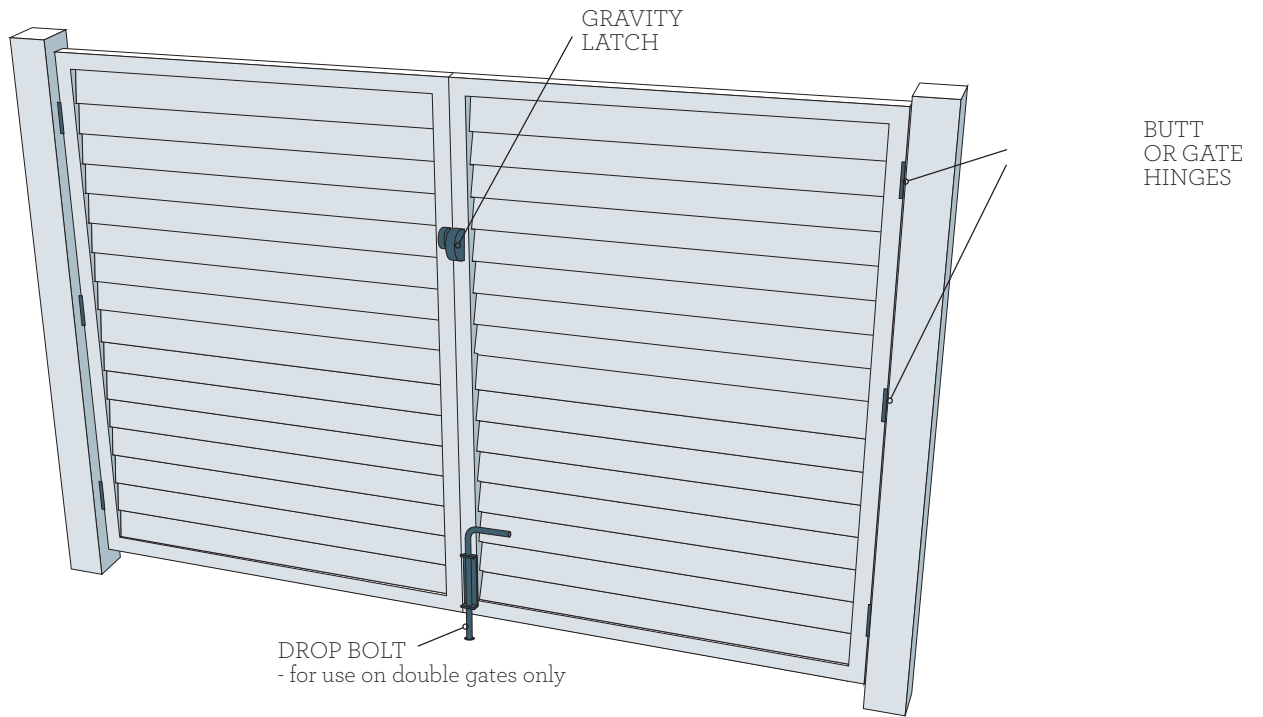

GRAVITY LATCH Polymer and Stainless Steel



Order Code: BELHGL

SPECIFICATION

- High grade polymer and stainless steel
- Resists UV and rust degradation

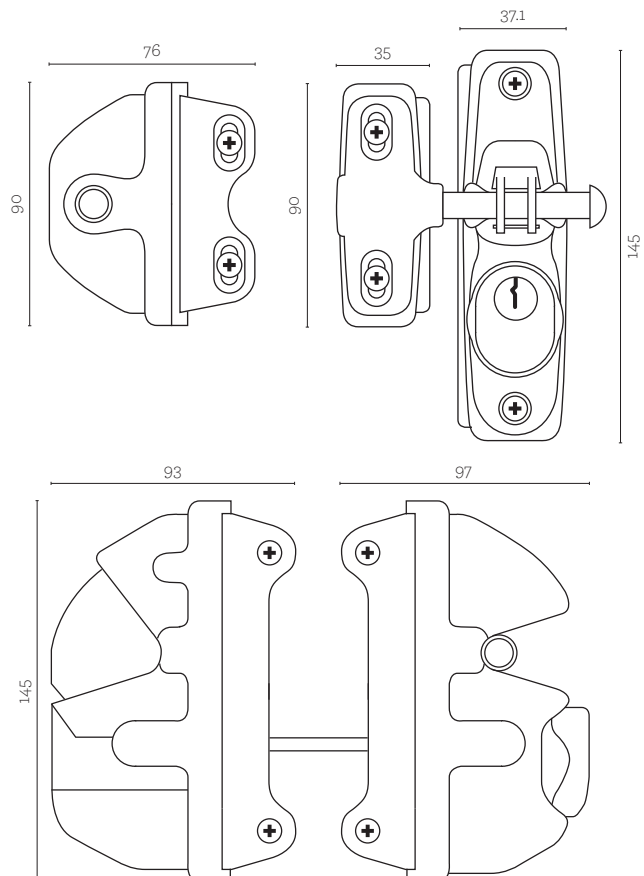

STAINLESS STEEL BUTT HINGE

304 Grade Satin Finish Stainless Steel

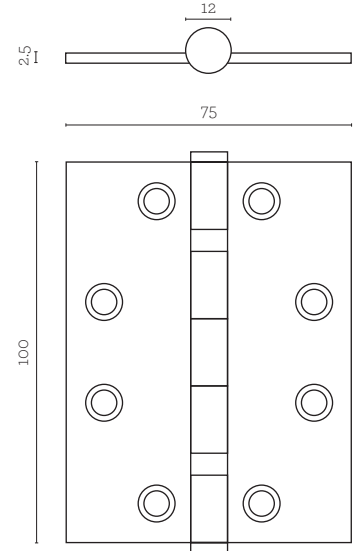
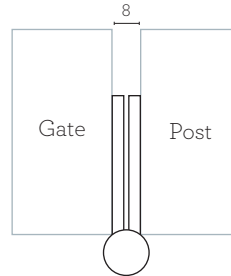

Order Code:

Stainless: BELSSBH

Stainless Black: BELSSBH B

SPECIFICATION

- 304 grade stainless steel
- Satin finish
- Fixed pin
- Square edge
- Stainless steel screws supplied
- Size: 100mm x 75mm 2.5mm
- For gates from 900 - 1500mm wide
- Rivets provided

When using **STAINLESS STEEL BUTT HINGES**, leave a gap between the posts that is:

- 25mm wider than the gate (for a single gate) or
- 35mm wider than the gates (for double gates).

HEAVY-DUTY BLACK HINGE

3mm Aluminium Wall or Post Mounted

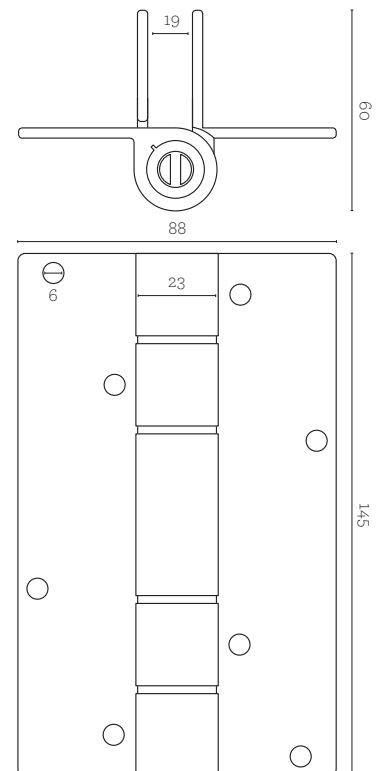
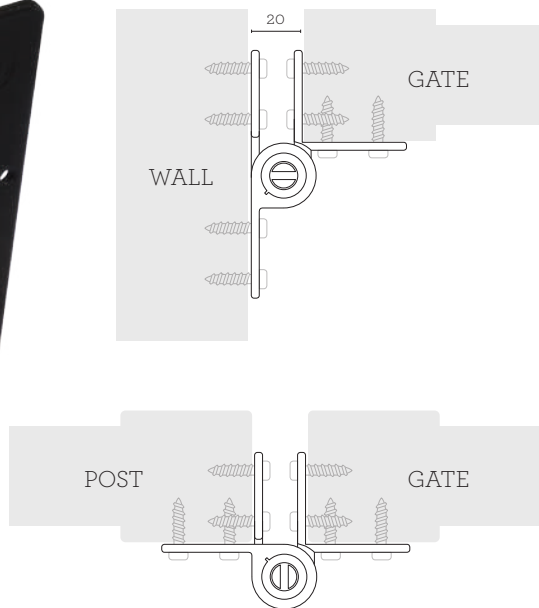

Order Code: BELKFH

SPECIFICATION

- 3mm aluminium
- Black satin finish
- Adjustable tension
- Size: 145mm x 88mm 55mm
- For gates up to 1500mm wide

When using **HEAVY-DUTY BLACK HINGES**, leave a gap between the posts that is:

- 35mm wider than the gate (for a single gate) or
- 55mm wider than the gates (for double gates).

HINGED GATES

HEAVY DUTY GATE HINGES

8mm Steel

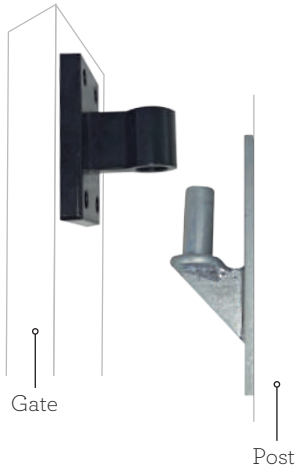

Order Code: BELHDGH

SPECIFICATION

- Screw on fittings
- Powercoated to same as gate colour
- For gates 1500 - 2500mm wide

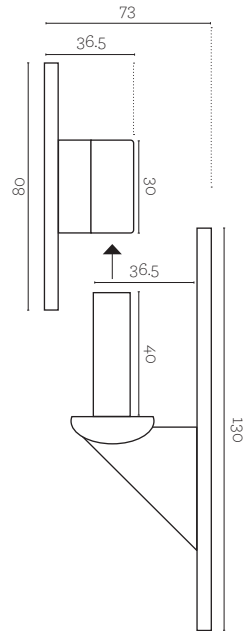
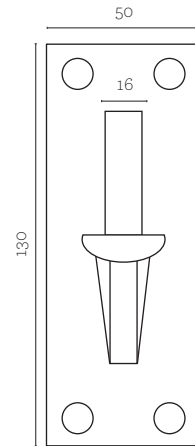
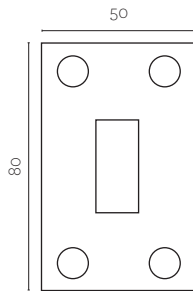

DROP BOLT

12mm Diameter Steel

Order Code:

Stainless: BELDB

Stainless Black: BELDB B

SPECIFICATION

- Screw on fittings

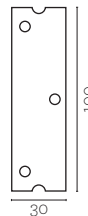
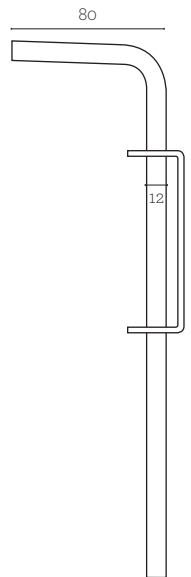

Order Code:
BELDB

POOL HINGE & LATCH SET

SET INCLUDES 2 HINGES & LATCH: Order Code: PGH

MAGNETIC SAFETY LATCH

Polymer and stainless steel

SPECIFICATION

- Visual indicator shows Locked/Unlocked status
- New, higher-security lock cylinder
- Vertically and horizontally adjustable
- Indicator marks show if adjustment is required
- Meets all Australian and NZ Standards for pool gates
- Minimum post size: 25mm+
- Ideal gate gap: 19mm
- Fixing method: screw-on

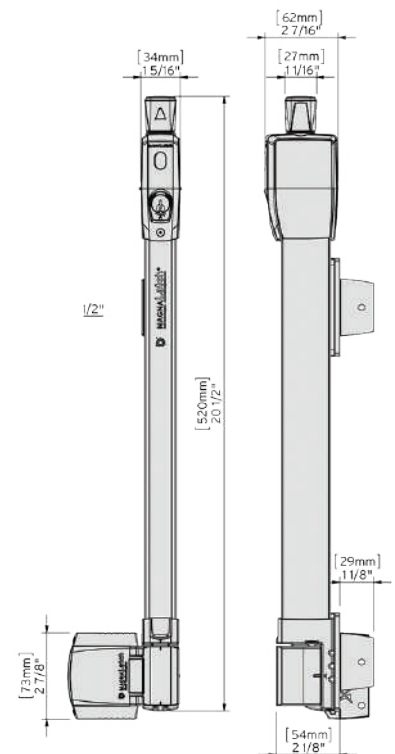
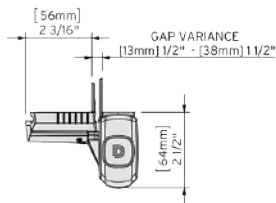



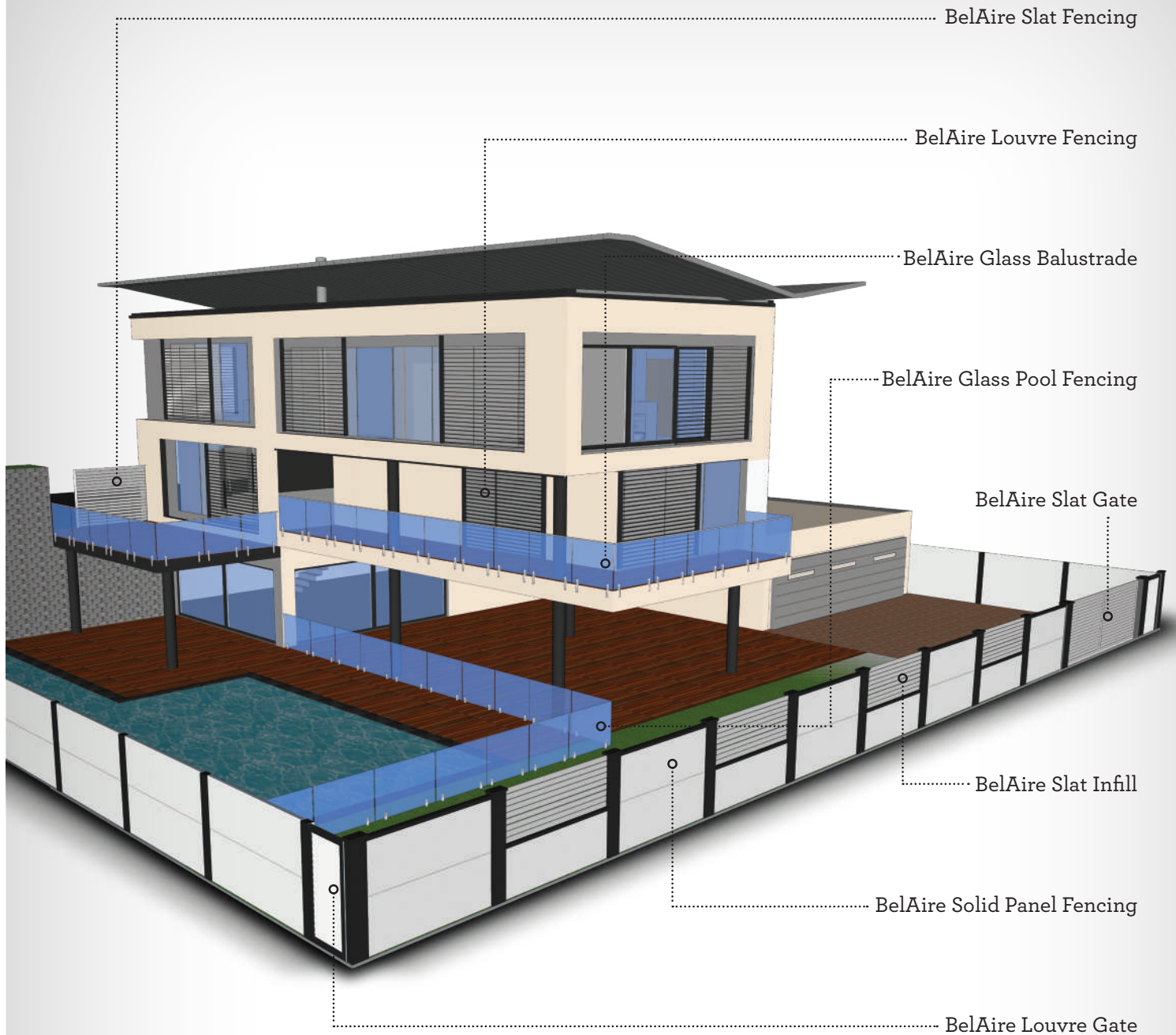

For more information, call us to speak to one of our friendly team:

0800 235 2473

BelAire Designer Fencing is a division of:



BelAire Designer Fencing
 PO Box 3030, Hawke's Bay Mail Centre, Napier 4142 New Zealand

Tel: 0800 BELAIRE (0800 235 2473) · **Fax:** 06 878 5758

Email: info@belairefencing.co.nz · www.belairefencing.co.nz