

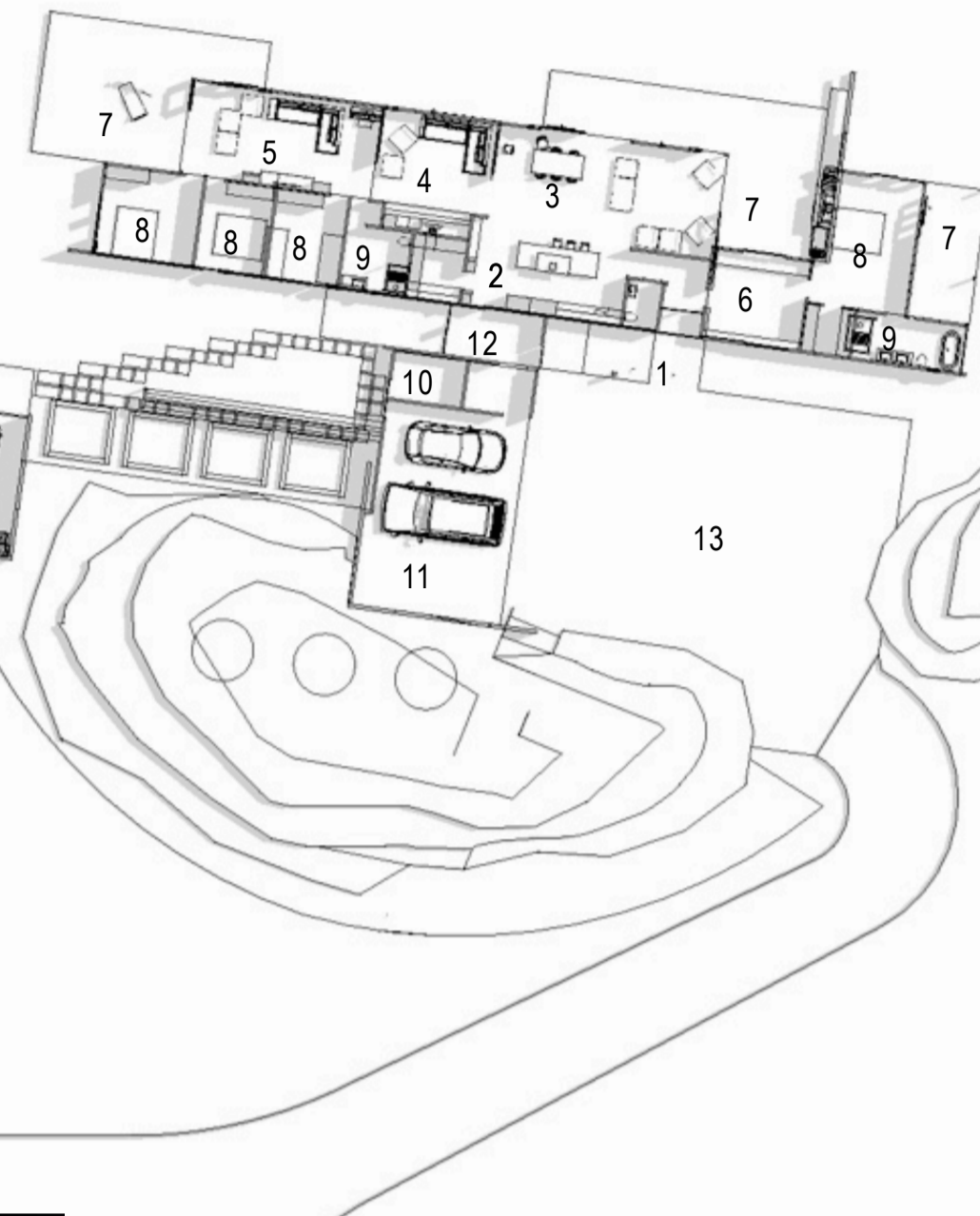

- 1 Entry
- 2 Kitchen
- 3 Family
- 4 Winter room
- 5 Lounge
- 6 Office
- 7 Courtyards
- 8 Bedrooms
- 9 Bathrooms
- 10 Laundry
- 11 Garage
- 12 Mud room
- 13 Forecourt



BIG SKY FARM HOUSE:
 This project took 3 years of Planning before the client walked the site with us. A gentle sloping open expansive plot overlooking the Alluvial Firth of Thames basin that string together many Dairy Farms.
 The vista stretches from the Kaimai Ranges to Te Aroha & is the site settles below the Maungakawa Ranges to the South.
 The client wanted a house of Concrete, timber, steel & Glass. It had to be fun, relaxed & love to cook & entertain. This is a very active family & have four generations that connect to the local community.
 The house needed to be affordable & we discussed how to achieve this. Open to new construction techniques, & commercial detailing allowed the design to move outside NZBC acceptable solutions & with the use of Metalcraft composite panels, the house roof & walls become a key to meeting the budget. This allowed the construction program to be reduced through prefabrication.
 This also has allowed the house to remain simple in form, warm & quiet (with double the required insulation required) and also allowed us to become bold with a dark exterior cladding (which recedes into the landscape) & has no thermal bridging issues. A thermally insulated floor creates a vey large heat sink & a casual robust feel to a Modern Country Home.
 The Plan form, lays out all the social spaces to the North & wraps the sleeping spaces at each end. The study to the east & the Family room to the West act as circulation to serve the bedrooms.
 The garage & mud room are an annex to the rear of the building, with large areas for string sports equipment & gear associated with running a farm.
 Skylights, & a sheltered entry were part of the brief. The entry to the South is concealed by two large berms of earth, relocated from nearby topsoil. This along with the garage Tilt slab, helps to reflect wind & noise from SHW 27.
 The Kitchen is the heart of the house & connects to the large dining table seating & external fireplace courtyard. This has created a special Home that feels peaceful & relaxed. Complimentary to the clients that live there.



