

JOSEPH GILES



LV1058
'Bartlett' Solid Brass Lever Handle
with unique Rota-Bearing Sprung Rose

LV1058

'Bartlett' Solid Brass Lever Handle

JOSEPH GILES

The 'Bartlett' door lever handles are made from finest grade solid brass and are available in all our signature finishes. Our lever handles come with a 10-year mechanical guarantee.

The 'Bartlett' family, sharing the same name as the famed Bartlett School of Architecture in London's University College London, was crafted with attention to architecture, fusing traditional concentric patterns with a contemporary cylindrical design. Joseph Giles understands the necessary marrying of form and function, and with this knowledge, created this collection.

The simple geometry of concentric circles and clean lines are the hallmark of the 'Bartlett' family. The contemporary design will co-ordinate effortlessly across a space for a pleasing, modern aesthetic, with subtle nods to traditional design classics. The beauty of this design is that individual pieces will stand out on their own, or you can combine the collection for a holistic scheme.

We started the collection with this lever handle which was very successful with architect and interior design practices, and so cabinet pulls and a door knob swiftly followed. More recently we've added floor and wall door stops, as well as centre door knobs.

Dimensions:

Code	A	B	C
LV1058.01	146mm	75mm	54mm

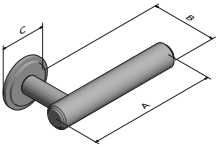

Available Finishes:



Dark Bronze Waxed DBZW



Polished Brass Waxed PBW



Polished Chrome PC



Polished Nickel PN



Brushed Brass Waxed BBW



Brushed Nickel BN



Mid Antique Brass Waxed MABW

Related Products:



CP1004: 'Bartlett' Solid Brass Cabinet Pull



DK1020: 'Bartlett' Solid Brass Door Knob



EP1001: 'Bartlett' Solid Brass Small Round Edge Pull