

## Trade Waste Solutions

**3monkeez**<sup>®</sup>  
innovate. create. deliver.



2022

**3monkeez**<sup>®</sup>

[www.3monkeez.com.au](http://www.3monkeez.com.au)

[sales@3monkeez.com.au](mailto:sales@3monkeez.com.au)

Model: SCRAP-S-50



Setting the **right** trap.



## Australia's 1st and only 50mm sink waste arrestor!

- Perfect for use in commercial and domestic food preparation areas.
- Innovative and highly effective design prevents scraps entering drains.
- One fixed and one removable dual stainless steel basket system.
- Easy to install, clean and maintain.
- 90mm and 125mm also available.
- Also available in 304 or 316 grade stainless steel



[3monkeez.com.au](http://3monkeez.com.au)

# Setting the right trap.



## Contents

### Index

Sink Waste Arrestor	4	Round Floor Wastes - heel proof	29, 30
Domestic Sink Waste Arrestor	8	Square Floor Wastes - heel proof	31-39
Cast Stainless Steel Sink Waste Arrestors	9, 10, 11	Round Vinyl Floor Wastes - heel proof	40, 41
Cast Stainless Steel Shut Off Valve	12	Round Floor Waste Arrestors - heel proof	42, 43
Cast Stainless Steel Sink Waste Arrestor with Shut Off Valves	13, 14, 15	Square Floor Waste Arrestors - heel proof	44-52
Pre-Rinse Scrapbaskets	16	Round Vinyl Floor Waste Arrestors - heel proof	53, 54
Sink Wastes Standard & Designer	17	Vertical Variable Height Main Body	55, 56
Round Floor Waste Arrestors	19, 20	Clay / Plaster Arrestors	57, 58
Square Floor Waste Arrestors	21, 22	Clay Arrestor	59
Vinyl Floor Waste Arrestors	23, 24	Plaster Arrestor	60
Round Clear Outs	25, 26	Tundish	61
Round Vinyl Floor Clear Outs	27, 28	Tundish with Extended Front Sleeve	61

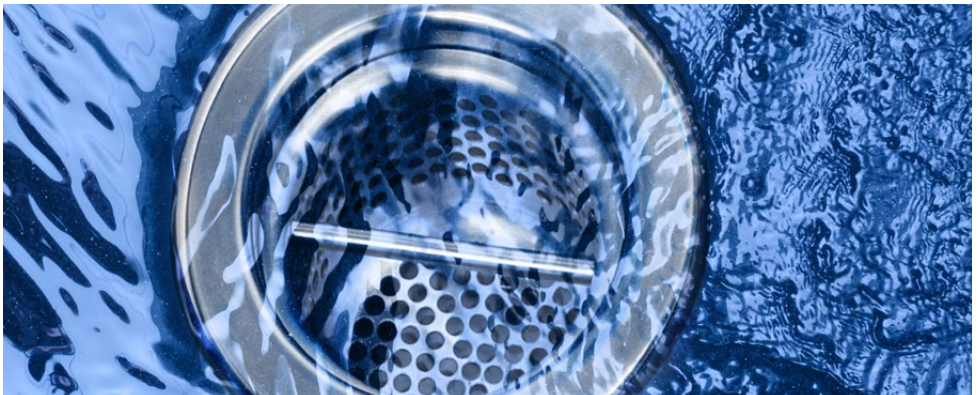

## 40mm Sink Waste Arrestor (suits 40mm outlet)



### SSBW-40

**P-PLUGSSBW-40 (PLUG ONLY)**

**P-BASKETSSBW-40 (BASKET ONLY)**

- 40mm MI BSP Connection
- Includes fixed strainer, removable basket and plug
- 4mm diameter strainer holes
- Can be retrofitted to 40mm outlet



Top

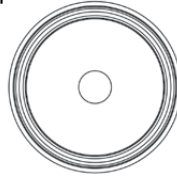

Side

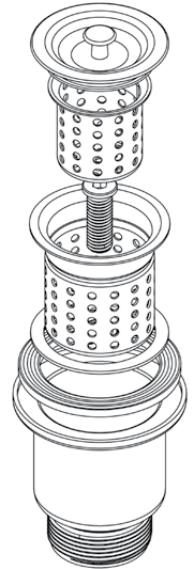
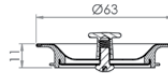
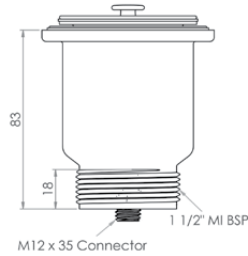

Cross Section

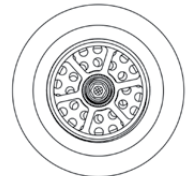
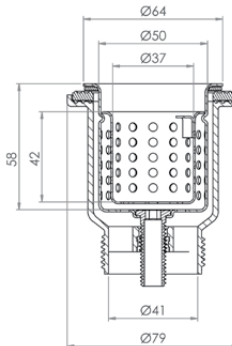

P-BASKETSSBW-40



P-PLUGSSBW-40

## Sink Waste Arrestor (suits 50mm outlet)



### SSBW-50

**P-PLUGSSBW-50 (PLUG ONLY)**

**P-BASKETSSBW-50 (BASKET ONLY)**

- 50mm MI BSP Connection
- Includes fixed strainer, removable basket and plug
- 4mm diameter strainer holes
- Can be retrofitted to 50mm outlet

Top

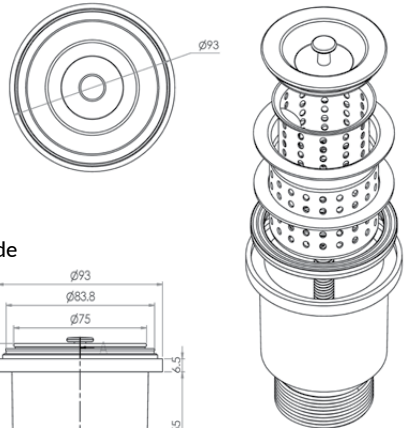

Side

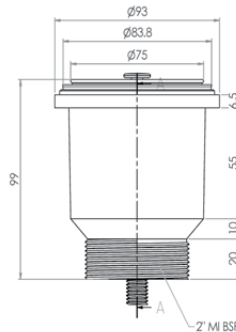

Cross Section

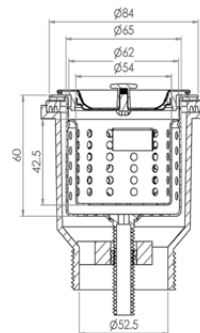

P-BASKETSSBW-50



P-PLUGSSBW-50

## Sink Waste Arrestor (suits 90mm outlet)



### SSBW

**P-PLUGSSBW (PLUG ONLY)**

**P-BASKETSSBW (BASKET ONLY)**

- 50mm MI BSP Connection
- Includes fixed strainer, removable basket and plug
- 3.95mm diameter strainer holes
- Can be retro fitted to 90mm outlet

Top

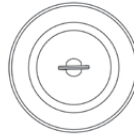

Bottom

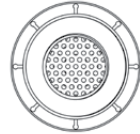

Side

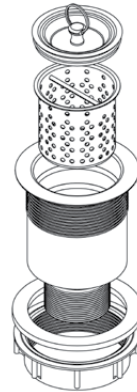
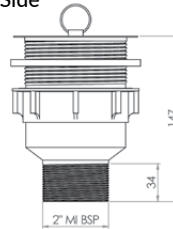

Cross Section

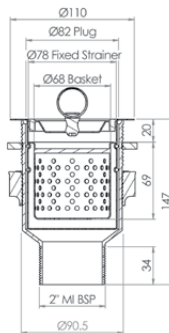

P-BASKETSSBW



P-PLUGSSBW

## Sink Waste Arrestor with 3mm holes (suits 90mm outlet)



### SSBW-3

**P-PLUGSSBW (PLUG ONLY)**

**P-BASKETSSBW-3 (BASKET ONLY)**

- 50mm MI BSP Connection
- Includes fixed strainer, removable basket and plug
- 3mm diameter strainer holes
- Can be retro fitted to 90mm outlet

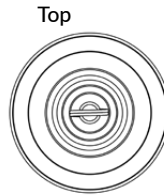

Top

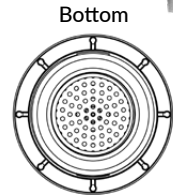

Bottom

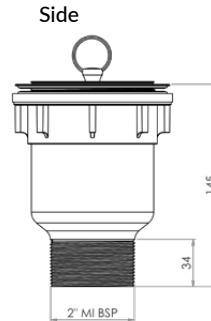

Side

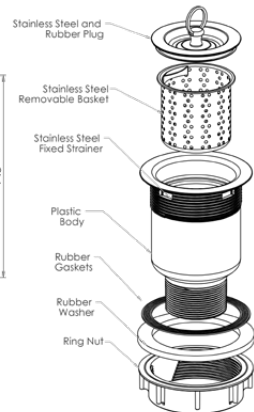

P-BASKETSSBW-3



P-PLUGSSBW

### Cross Section

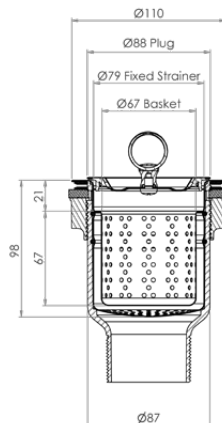

## Sink Waste Arrestor (suits 127mm outlet)



### SSBW-1

**P-PLUGSSBW-1 (PLUG ONLY)**

**P-BASKETSSBW-1 (BASKET ONLY)**

- 50mm MI BSP Connection
- Includes fixed strainer, removable basket and plug
- 3.95mm diameter strainer holes
- Suits a 127mm outlet

Top

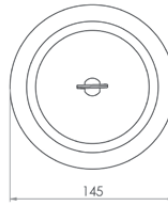

Bottom

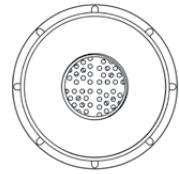

Side

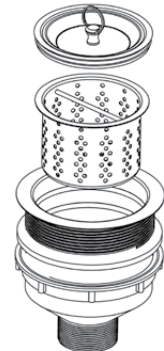
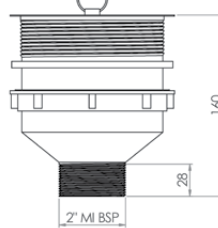

Cross Section

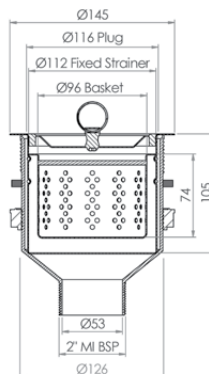

P-BASKETSSBW-1



P-PLUGSSBW-1



## Domestic Sink Waste Arrestor (suits 90mm outlet)



### SSDBW

**P-SSDBW-PLUG (PLUG ONLY)**

**P-SSDBW-BASKET (BASKET ONLY)**

- 50mm BSP Connection
- Minimises blockages and solids entering the sewerage system
- Suitable for domestic applications
- Perfect for multi dwelling constructions
- Includes fixed strainer, removable basket and plug
- Can be retro fitted to 90mm outlet

Top



Side

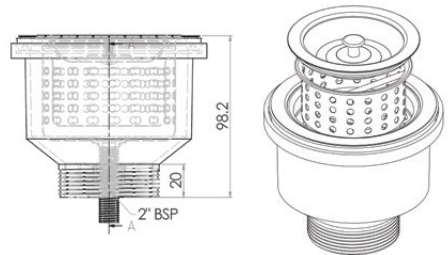

Cross Section

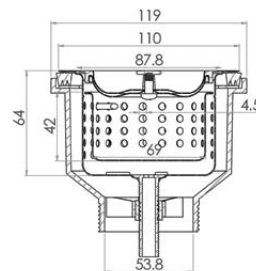

P-SSDBW-BASKET



P-SSDBW-PLUG

## Cast Stainless Steel Sink Waste Arrestor (suits 50mm outlet)



**SCRAP-S-50 (304 GRADE)**

**SCRAP-S-50-316 (316 GRADE)**

**SCRAP-S-50-P-316 (PLUG ONLY)**

**SCRAP-S-50-B-316 (BASKET ONLY)**

- Available in 304 or 316 grade stainless steel
- Cast stainless construction
- 50mm MI BSP Connection
- Includes fixed strainer, removable basket and plug
- 4mm diameter strainer holes
- Suitable for use with SCRAP-V and SCRAP-V316 shut off valves

Top



Bottom

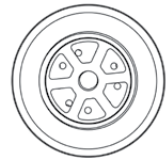

Side

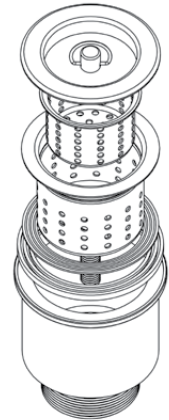

Cross Section

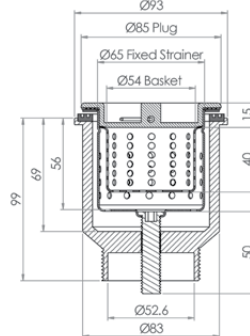

SCRAP-S-50-B-316

SCRAP-S-50-P-316

## Cast Stainless Steel Sink Waste Arrestor (suits 90mm outlet)



**SCRAP-S-90 (304 GRADE)**

**SCRAP-S-90-316 (316 GRADE)**

**SCRAP-S-90-P-316 (PLUG ONLY)**

**SCRAP-S-90-B-316 (BASKET ONLY)**

- Available in 304 or 316 grade stainless steel
- Cast stainless construction
- 50mm MI BSP Connection
- Includes fixed strainer, removable basket and plug
- Reliable and hard-wearing
- 4mm diameter strainer holes
- Suitable for use with SCRAP-V and SCRAP-V316 shut off valves

Top

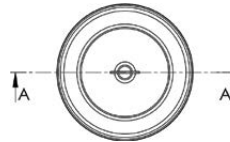

Bottom

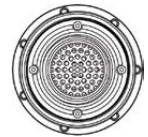

Side

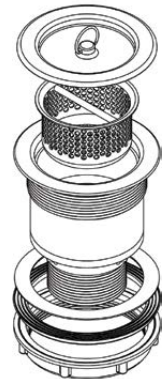
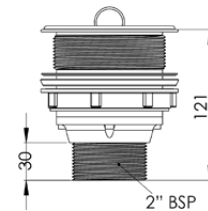

Cross Section

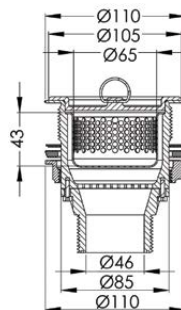

SCRAP-S-90-B-316

SCRAP-S-90-P-316

## Cast Stainless Steel Sink Waste Arrestor

(suits 127mm outlet)



**SCRAP-S (304 GRADE)**

**SCRAP-S316 (316 GRADE)**

**SCRAP-S-P-316 (PLUG ONLY)**

**SCRAP-S-B-316 (BASKET ONLY)**

- Available in 304 or 316 grade stainless steel
- Cast stainless construction
- 50mm MI BSP Connection
- Includes fixed strainer, removable basket and plug
- 4mm diameter strainer holes
- Suitable for use with SCRAP-V and SCRAP-V316 shut off valves

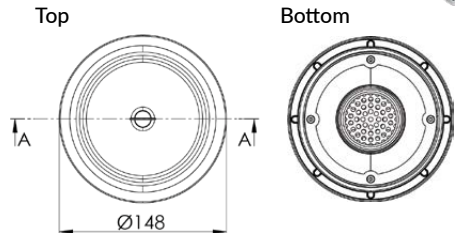

Side

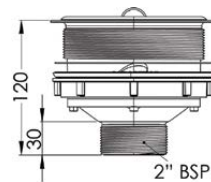

Cross Section

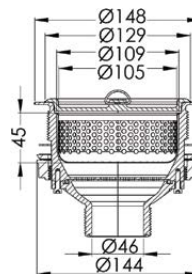

SCRAP-S-B-316



SCRAP-S-P-316

## Cast Stainless Steel Shut Off Valve



**SCRAP-V (304 GRADE)**

**SCRAP-V316 (316 GRADE)**

- Custom designed ergonomic handle
- Suitable for use with SCRAP-S-50, SCRAP-S-50-316, SCRAP-S-90, SCRAP-S-90-316, SCRAP-S and SCRAP-S316
- Available in 304 or 316 grade stainless steel
- Suits 50mm BSP thread/connection
- No plug required, drain water from the sink with a turn of the handle

Top

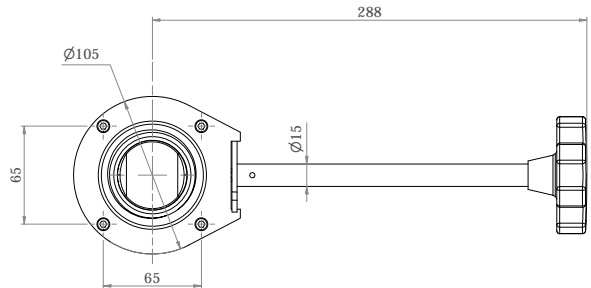

Bottom

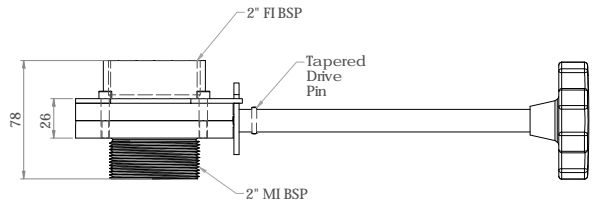

Side

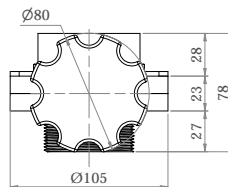

## Cast Stainless Steel Sink Waste Arrestor with Shut Off Valve (suits 50mm outlet)



- SCRAP-C-50 (304 GRADE)**
- SCRAP-C-50-316 (316 GRADE)**
- SCRAP-S-50-P-316 (PLUG ONLY)**
- SCRAP-S-50-B-316 (BASKET ONLY)**

- Available in 304 or 316 grade stainless steel
- Cast stainless construction
- 50mm MI BSP Connection
- Includes fixed strainer, removable basket and plug
- 4mm diameter strainer holes
- Custom designed ergonomic handle
- Suits 50mm outlet

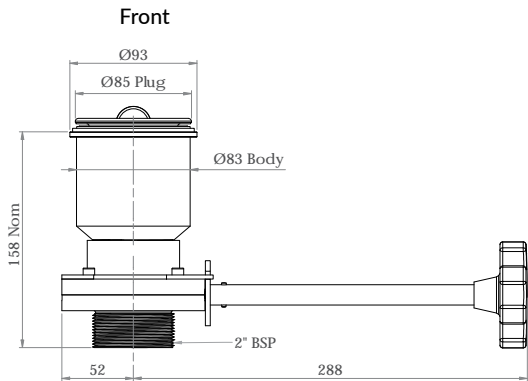
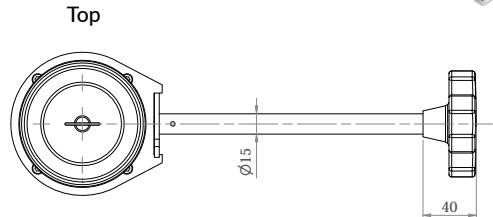

Side

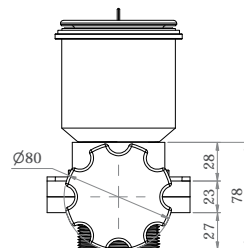

SCRAP-S-50-B-316

SCRAP-S-50-P-316

## Cast Stainless Steel Sink Waste Arrestor with Shut Off Valve (suits 90mm outlet)



**SCRAP-C-90 (304 GRADE)**

**SCRAP-C-90-316 (316 GRADE)**

**SCRAP-S-90-P-316 (PLUG ONLY)**

**SCRAP-S-90-B-316 (BASKET ONLY)**

- Available in 304 or 316 grade stainless steel
- Cast stainless construction
- 50mm MI BSP Connection
- Includes fixed strainer, removable basket and plug
- 4mm diameter strainer holes
- Custom designed ergonomic handle
- Suits 90mm outlet

Top

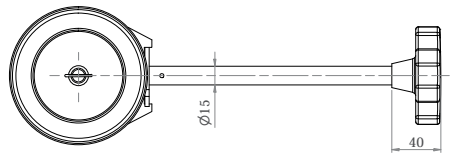

Front

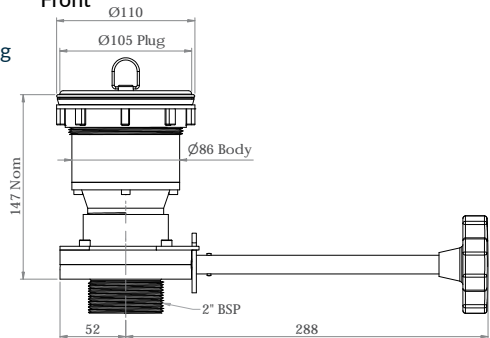

Side

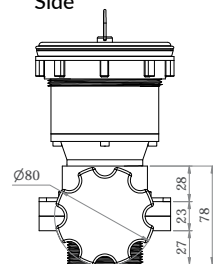

SCRAP-S-90-B-316

SCRAP-S-90-P-316

## Cast Stainless Steel Sink Waste Arrestor with Shut Off Valve (suits 127mm outlet)



**SCRAP-C (304 GRADE)**

**SCRAP-C316 (316 GRADE)**

**SCRAP-S-P-316 (PLUG ONLY)**

**SCRAP-S-B-316 (BASKET ONLY)**

- Available in 304 or 316 grade stainless steel
- Cast stainless construction
- 50mm MI BSP Connection
- Includes fixed strainer, removable basket and plug
- 4mm diameter strainer holes
- Custom designed ergonomic handle
- Suits 127mm outlet

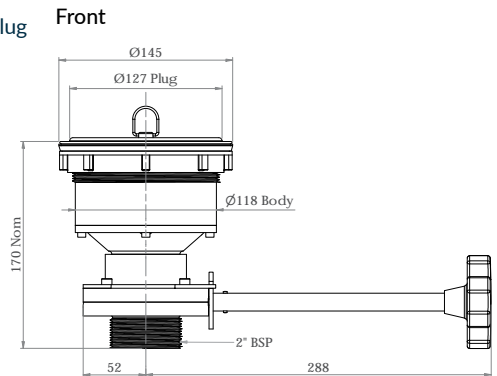
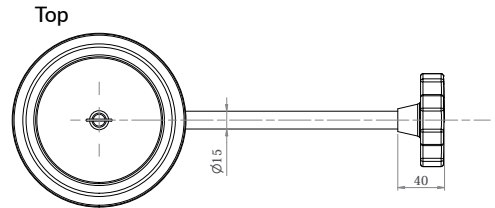

SCRAP-S-B-316



SCRAP-S-P-316

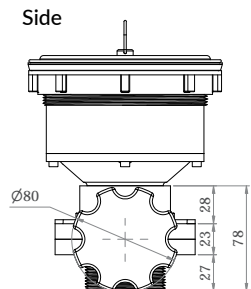





## Pre-Rinse Scrapbaskets

### SB1 (270MM X 415MM X 130MM)

Suitable for a variety of commercial pre wash sinks, two can be positioned side by side to suit a 600mm x 450mm sink space.

- Dishwasher friendly
- Easy lift handles
- Lightweight
- No sharp edges
- A unique Australian design
- Catch food waste and scraps before entering the drainage system



Top

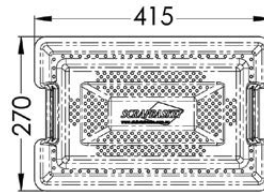

Front

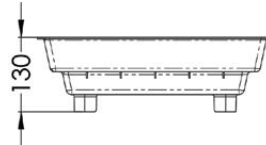

Side

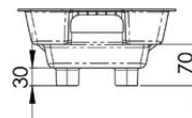



## Sink Wastes Standard & Designer

### PW40

- Suits 40mm outlet
- 40mm BSP connection
- Stainless steel rim

### PW50

- Suits 50mm outlet
- 50mm BSP connection
- Stainless steel rim

### PW40



Overall height - 69mm

### PW50



Overall height - 55mm

### PW50-SS316

- Suits 50mm outlet
- 50mm BSP connection
- 316 grade stainless steel construction
- Removable grate

### BW90S & BW90L

- Suits 90mm outlet
- 50mm BSP connection
- Stainless steel insert and basket
- 50mm bolt length

### BW90S



Overall height - 62mm

### BW90L



Overall height - 81mm

### PWRR-90-50

Reducing ring suit 90mm outlet to 50mm waste

- 316 grade stainless steel construction
- Supplied in a 2pack



### PW50-SS316



Overall height - 45mm

# Setting the right trap.



## Premium Quality

3monkeez are the specialists when it comes to in-sink basket arrestors, floor wastes and pre-rinse screening for trade waste applications in commercial kitchens, hotels, hospitals, laboratories, and anywhere where protection of your drainage system from trade waste by-products is a priority.

As the home of the original, approved and trademarked Scraptrap range, 3monkeez can offer the best solution for trade waste screening and can ensure your establishment complies with all the standards and plumbing code requirements.

Our Scraptrap range of products have been developed and tested in Australia and offer durability, simple and effective design and the support of a business that has been delivering trade waste solutions to the plumbing industry for well over 10 years.

If quality trade waste pre-screening is a priority, 3monkeez have it covered with our original and approved Scraptrap range of in sink basket arrestors and floor wastes.



### SMOOTH FINISH

Stainless steel provides an easy to clean surface and prevents the build-up of bacteria.



### HIGHLY DURABLE

Strong material reducing the occurrence of dents and bends.



### SMALL FOOTPRINT

Stainless steel is 100% recyclable.



### WATERMARK APPROVAL

Watermark Approval Number:  
23097



**Innovative and environmentally friendly  
trade waste solutions.**

## 100mm Round Drop in Floor Waste Arrestor



### FW-100BRL

### FW-100RL-BASKET (BASKET ONLY)

- Stainless steel grate
- Fixed secondary strainer
- Removable strainer basket
- Suits 100mm DWV, HDPE pipe



FW-100RL-BASKET

Top



Bottom

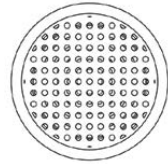

Side

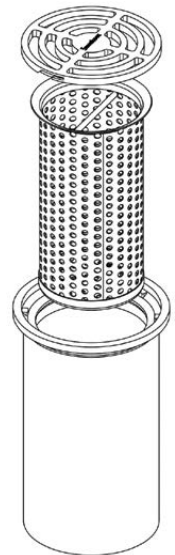
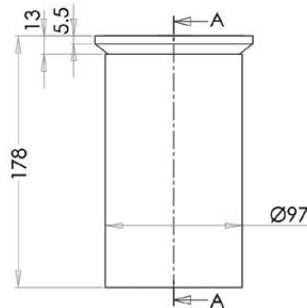

Cross Section

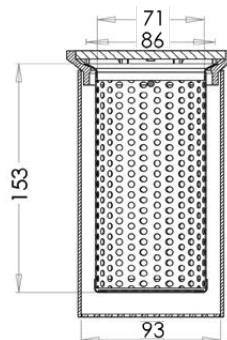

## 150mm Round Floor Waste Arrestor



**FW-150BR**

**FW-150R-BASKET (BASKET ONLY)**

- Stainless steel grate
- Fixed secondary strainer
- Removable strainer basket
- Suits 100mm DWV, HDPE pipe

Top

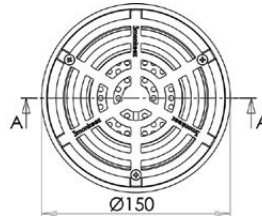

Bottom

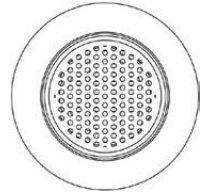

Side

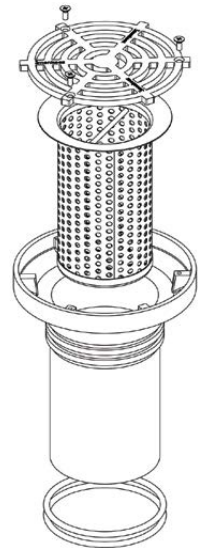
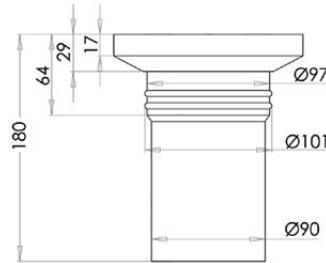

Cross Section

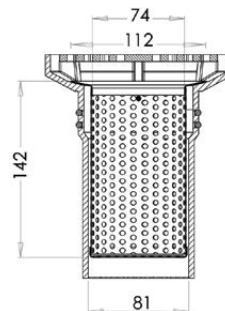

FW-150R-BASKET

## 150mm Square Floor Waste Arrestor



### FW-150BS

### FW-150S-BASKET (BASKET ONLY)

- Hinged stainless steel grate
- Fixed secondary strainer
- Removable strainer basket
- Suits 100mm DWV, HDPE pipe



FW-150S-BASKET

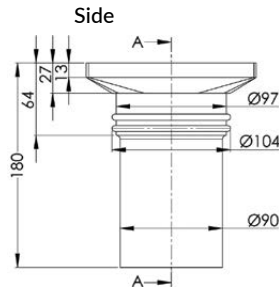
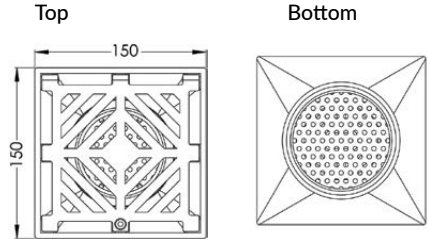

### Cross Section

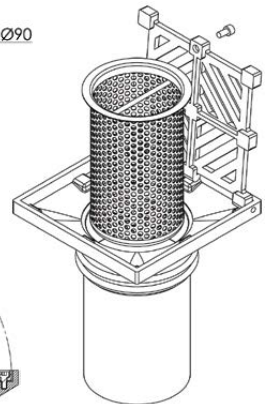
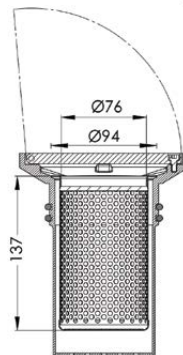

## 200mm Square Floor Waste Arrestor



FW-200BS-304

FW-200BS-316

FW-200S-BASKET-304 (BASKET ONLY)

FW-200S-BASKET-316 (BASKET ONLY)

- Hinged stainless steel grate
- Fixed secondary strainer
- Removable strainer basket
- Suits 100mm DWV, HDPE pipe



FW-200S-BASKET

Top

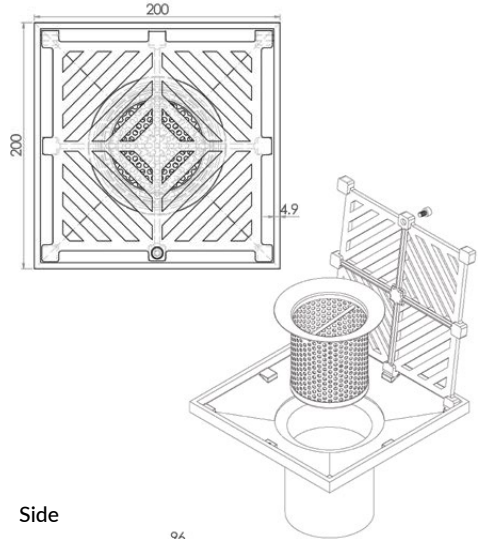

Side

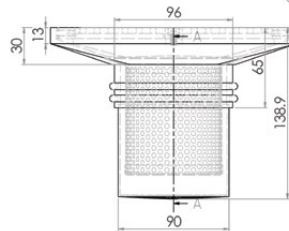

Cross Section

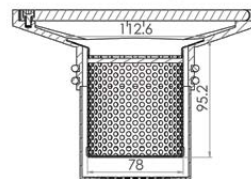

# Trade Waste Solutions



## 100mm Vinyl Floor Waste Arrestor



FW-100VRBT

FW-150S BASKET

- Vinyl clamp
- Stainless steel grate
- Fixed secondary strainer
- Removable strainer basket
- Suits 100mm DWV, HDPE pipe



FW-150S BASKET

Top

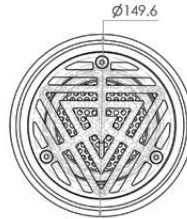

Bottom

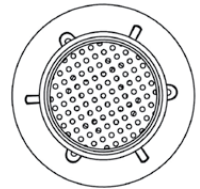

Side

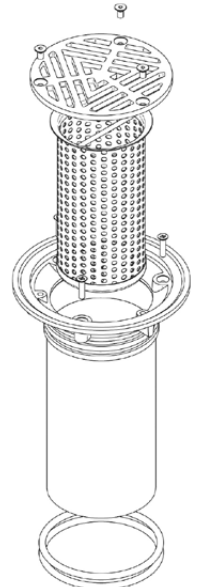
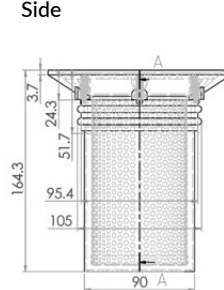

Cross Section

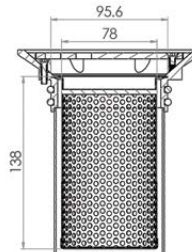



## 100mm Vinyl Floor Waste



### FW-100VR

- Solid brass body
- Chrome plated brass grate
- Suits 100mm DWV, HDPE pipe



Top

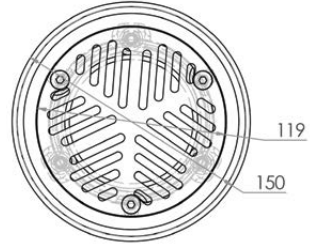

Bottom



Side

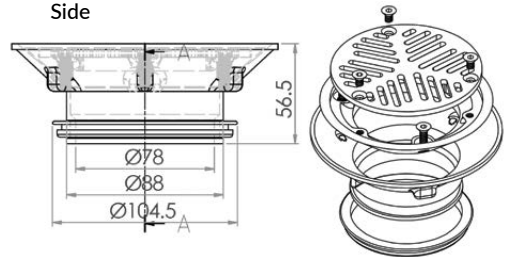

Cross Section

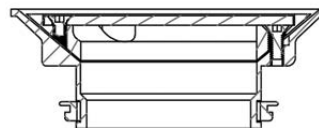

## Round Clear Out

**FW-130CO-304**

**FW-130CO-316**

- 3mm thick removable top
- Suit tiled floor application
- Push fit o-ring seal
- 304 or 316 grade stainless steel
- Suits 100mm DWV, HDPE pipe



Top

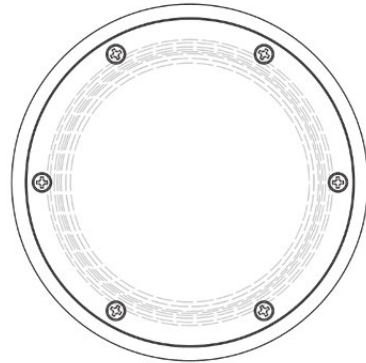

Front

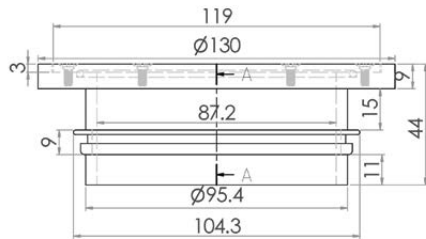

Cross Section



## 150mm Round Clear Out

FW-150CO-304

FW-150CO-316

- 3mm thick removable top
- Suit tiled floor application
- Push fit o-ring seal
- 304 or 316 grade stainless steel
- Suits 100mm DWV, HDPE pipe



Top

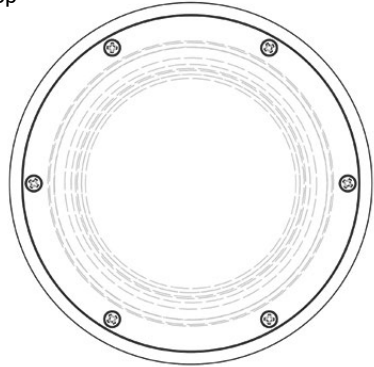

Front

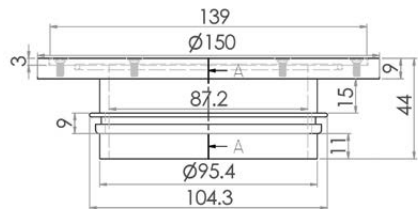

Cross Section

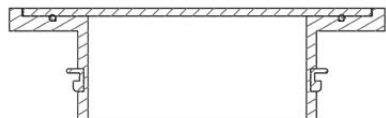

## 130mm Round Vinyl Floor Clear Out



FW-130VCO-304

FW-130VCO-316

- 2mm thick removable top
- Suit vinyl floor application
- Includes vinyl clamp
- Push fit o-ring seal
- 304 or 316 grade stainless steel
- Suits 100mm DWV, HDPE pipe



Top

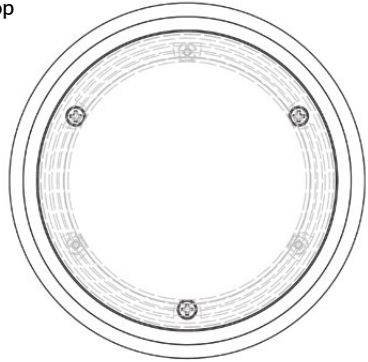

Front

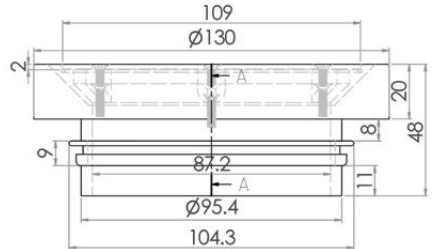

Cross Section

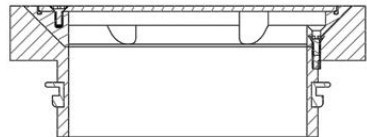

## 200mm Round Vinyl Floor Clear Out

FW-200VCO-150-304

FW-200VCO-150-316

- 2mm thick removable top
- Suit vinyl floor application
- Includes vinyl clamp
- Push fit o-ring seal
- 304 or 316 grade stainless steel
- Suits 150mm DWV, HDPE pipe



Top

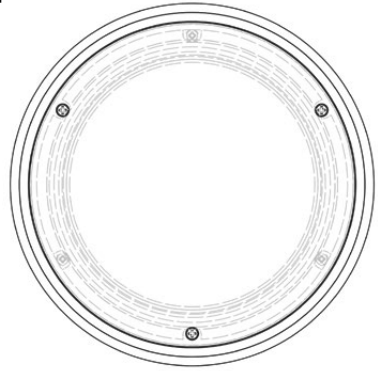

Front

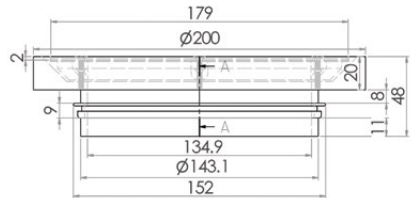

Cross Section



## 112mm Round Drop in Floor Waste

**FW-100RL-304**

**FW-100RL-316**

- 112mm round
- Heel proof
- 304 or 316 grade stainless steel
- Suits 100mm DWV, HDPE pipe

Top

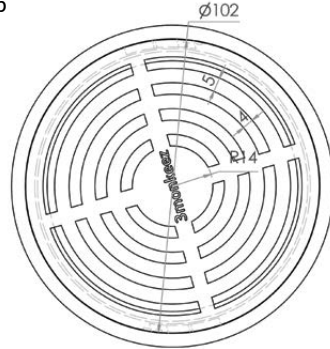

Front

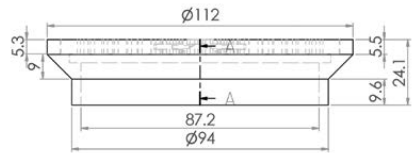

Cross Section

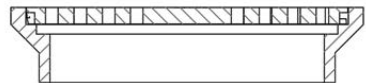

## 150mm Round Floor Waste



**FW-150R-304**

**FW-150R-316**

- Removable grate
- Heel proof
- 304 or 316 grade stainless steel
- Suits 100mm DWV, HDPE pipe

Top

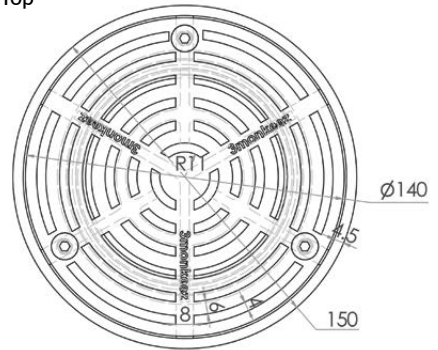

Front

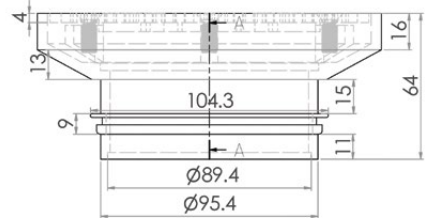

Cross Section

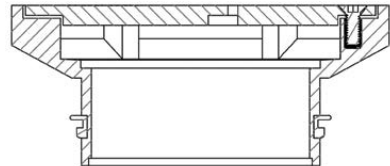

## 150mm Square Floor Waste



FW-150S-304

FW-150S-316

- Hinged grate
- Heel proof
- 304 or 316 grade stainless steel
- Suits 100mm DWV, HDPE pipe



Top

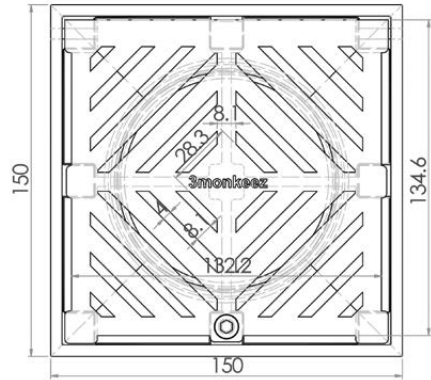

Front

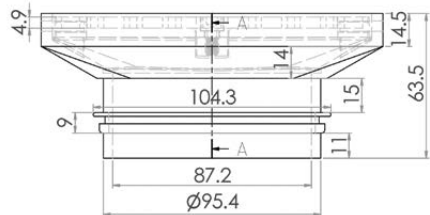

Cross Section

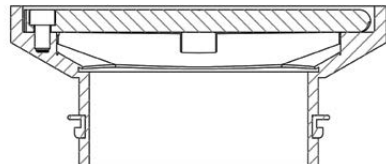



## 200mm Square Floor Waste (suits 100mm pipe)

**FW-200S-304**

**FW-200S-316**

- Hinged grate
- Heel proof
- 304 or 316 grade stainless steel
- Suits 100mm DWV, HDPE pipe



Top

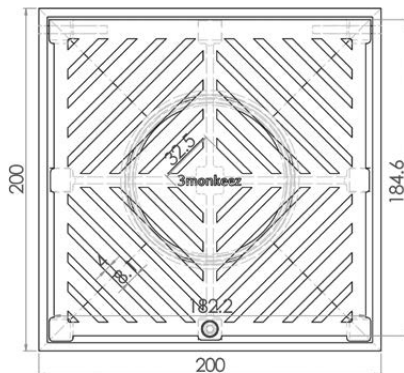

Front

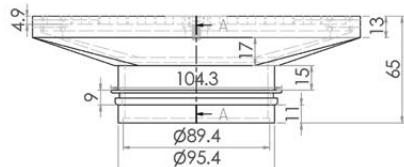

Cross Section

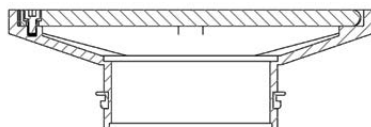

## 200mm Square Floor Waste (suits 150mm pipe)

**FW-200S-150-304**

**FW-200S-150-316**

- Hinged grate
- Heel proof
- 304 or 316 grade stainless steel
- Suits 150mm DWV, HDPE pipe



Top

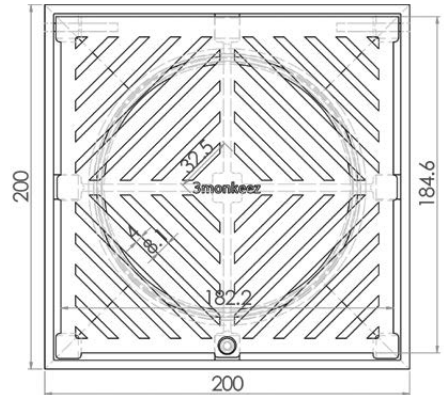

Front

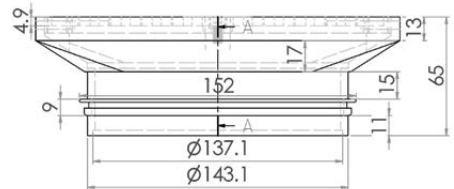

Cross Section

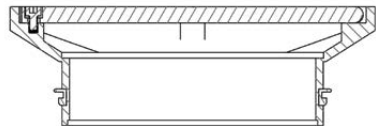

## 225mm Square Floor Waste (suits 100mm pipe)

**FW-225S-304**

**FW-225S-316**

- Hinged grate
- Heel proof
- 304 or 316 grade stainless steel
- Suits 100mm DWV, HDPE pipe



Top

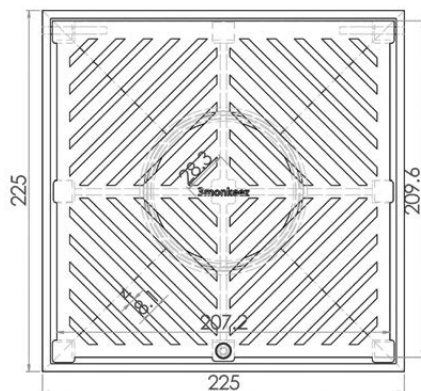

Front

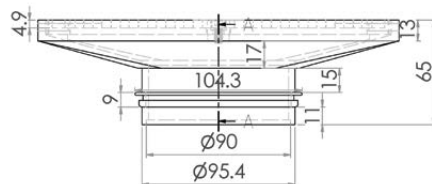

Cross Section

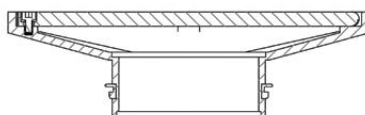

## 225mm Square Floor Waste (suits 150mm pipe)

FW-225S-150-304

FW-225S-150-316

- Hinged grate
- Heel proof
- 304 or 316 grade stainless steel
- Suits 150mm DWV, HDPE pipe



Top

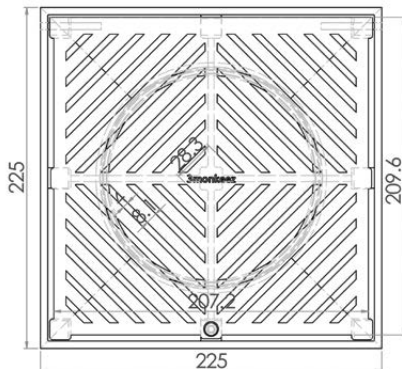

Front

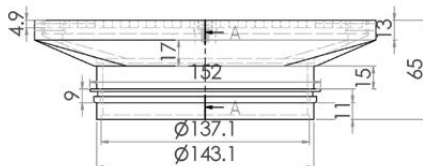

Cross Section

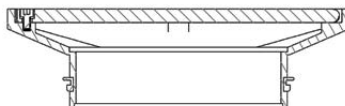

## 250mm Square Floor Waste (suits 100mm pipe)

**FW-250S-304**

**FW-250S-316**

- 250mm square, hinged grate
- Heel proof
- 304 or 316 grade stainless steel
- Suits 100mm DWV, HDPE pipe



Top

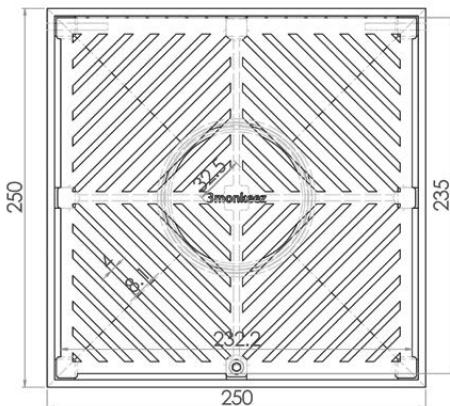

Front

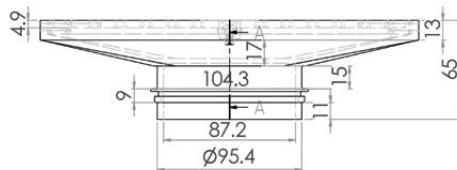

Cross Section

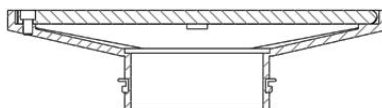

# Trade Waste Solutions



## 250mm Square Floor Waste (suits 150mm pipe)



FW-250S-150-304

FW-250S-150-316

- Hinged grate
- Heel proof
- 304 or 316 grade stainless steel
- Suits 150mm DWV, HDPE pipe



Top

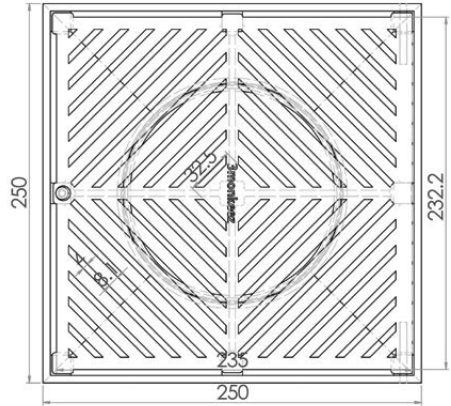

Front

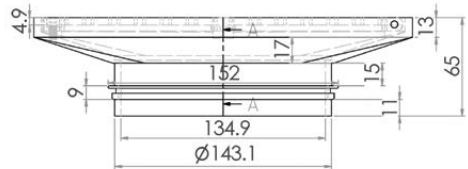

Cross Section

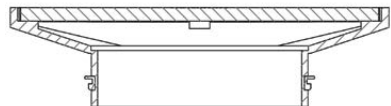

# Trade Waste Solutions



## 300mm Square Floor Waste (suits 100mm pipe)

**FW-300S-304**

**FW-300S-316**

- 300mm square, hinged grate
- Heel proof
- 304 or 316 grade stainless steel
- Suits 100mm DWV, HDPE pipe



Top

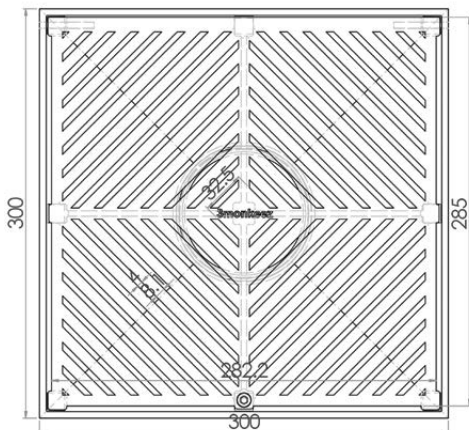

Front

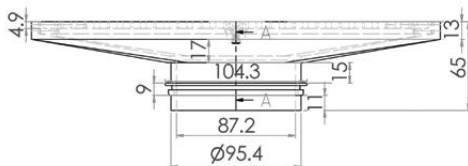

Cross Section



# Trade Waste Solutions



## 300mm Square Floor Waste (suits 150mm pipe)

**FW-300S-150-304**

**FW-300S-150-316**

- 300mm square, hinged grate
- Heel proof
- 304 or 316 grade stainless steel
- Suits 150mm DWV, HDPE pipe



Top

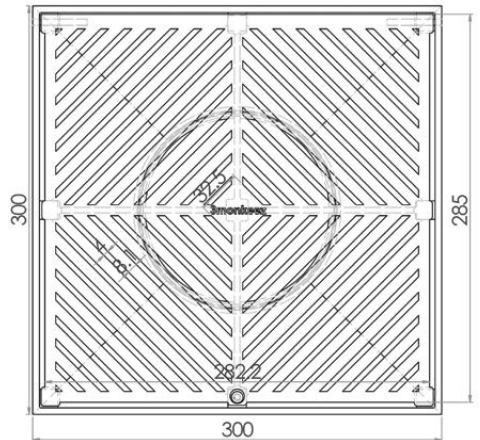

Front

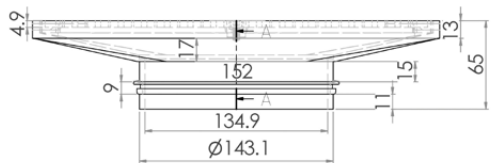

Cross Section

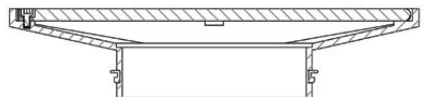



## 150mm Round Vinyl Floor Waste (suits 100mm pipe)

**FW-100VRT-304**

**FW-100VRT-316**

- Removable grate
- Heel proof
- Suit vinyl floor application
- Includes vinyl clamp
- 304 or 316 grade stainless steel
- Suits 100mm DWV, HDPE pipe



Top

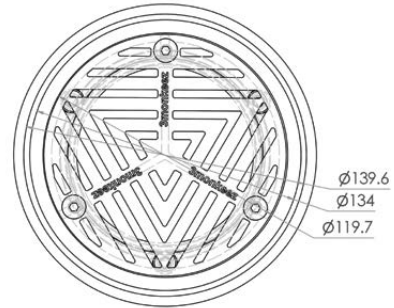

Front

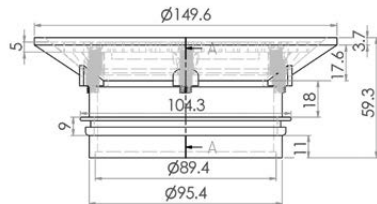

Cross Section

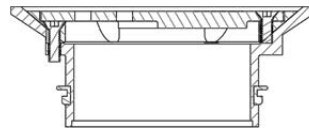

## 200mm Round Vinyl Floor Waste (suits 150mm pipe)



**FW-200VRT-150-304**

**FW-200VRT-150-316**

- Removable grate
- Heel proof
- Suit vinyl floor application
- Includes vinyl clamp
- 304 or 316 grade stainless steel
- Suits 150mm DWV, HDPE pipe

Top

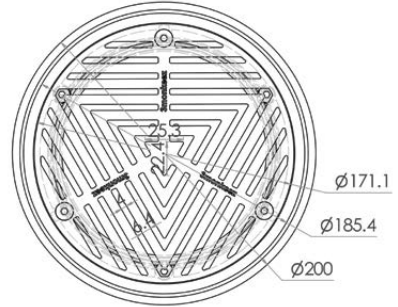

Front

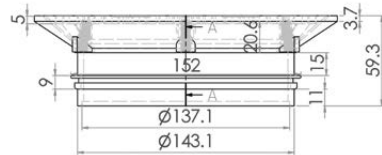

Cross Section



## 112mm Round Floor Waste Arrestor (suits 100mm pipe)



**FW-100BRL-304**

**FW-100BRL-316**

- Removable grate
- Heel proof
- Fixed strainer with 4mm holes
- Removable basket with 4mm holes
- 304 or 316 grade stainless steel
- Suits 100mm DWV, HDPE pipe



FW-BASKET-100

Top

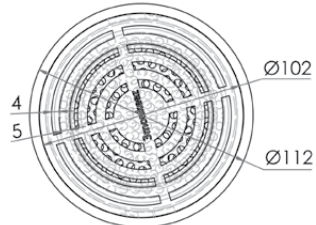

Front

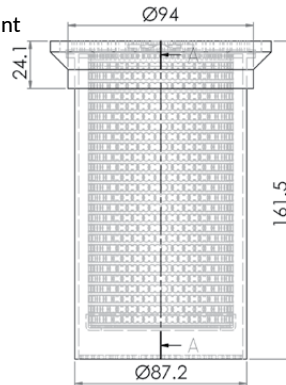

Cross Section

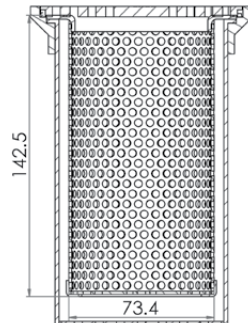

## 150mm Round Floor Waste Arrestor (suits 100mm pipe)



**FW-150BR-304**

**FW-150BR-316**

- Removable grate
- Heel proof
- Fixed strainer with 4mm holes
- Removable basket with 4mm holes
- 304 or 316 grade stainless steel
- Suits 100mm DWV, HDPE pipe



FW-BASKET-100

Top

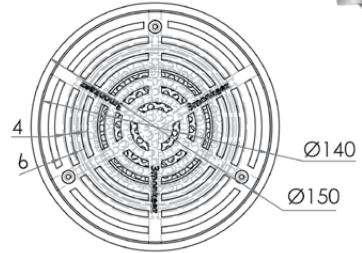

Front

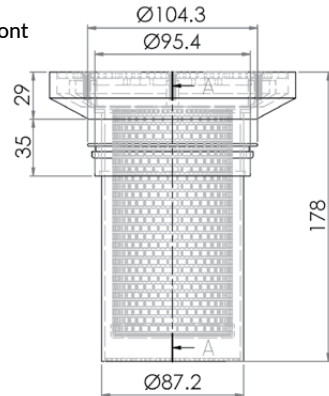

Cross Section

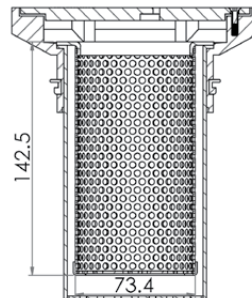

## 150mm Square Floor Waste Arrestor (suits 100mm pipe)



**FW-150BS-304**

**FW-150BS-316**

- Hinged grate
- Heel proof
- Fixed strainer with 4mm holes
- Removable basket with 4mm holes
- 304 or 316 grade stainless steel
- Suits 100mm DWV, HDPE pipe



FW-BASKET-100

Top

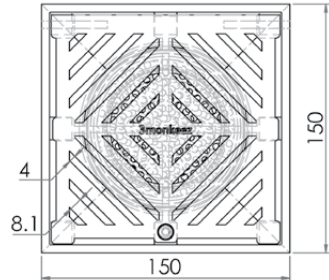

Front

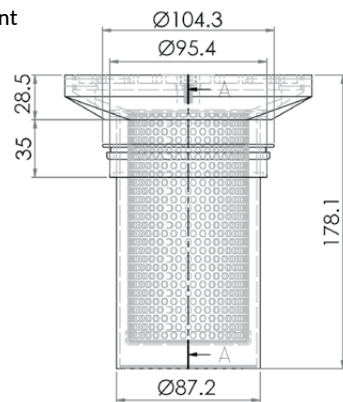

Cross Section

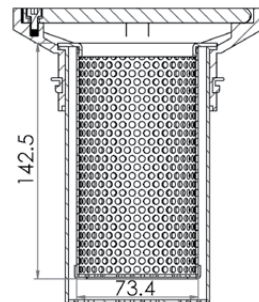

## 200mm Square Floor Waste Arrestor (suits 100mm pipe)



FW-200BSM-304

FW-200BSM-316

- Hinged grate
- Heel proof
- Fixed strainer with 4mm holes
- Removable basket with 4mm holes
- 304 or 316 grade stainless steel
- Suits 100mm DWV, HDPE pipe



FW-BASKET-100

Top

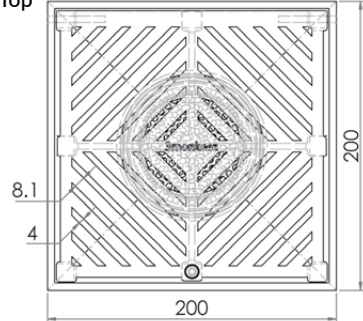

Front

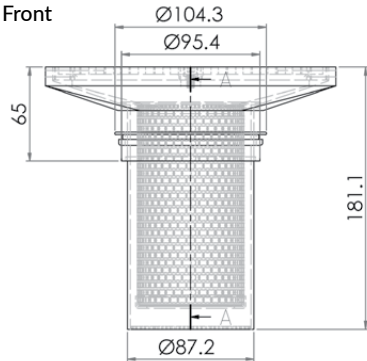

Cross Section

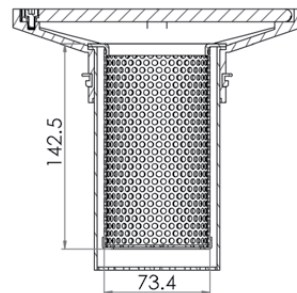

## 200mm Square Floor Waste Arrestor (suits 150mm pipe)

**FW-200BS-150-304**

**FW-200BS-150-316**

- Hinged grate
- Heel proof
- Fixed strainer with 4mm holes
- Removable basket with 4mm holes
- 304 or 316 grade stainless steel
- Suits 150mm DWV, HDPE pipe



FW-BASKET-150



Top

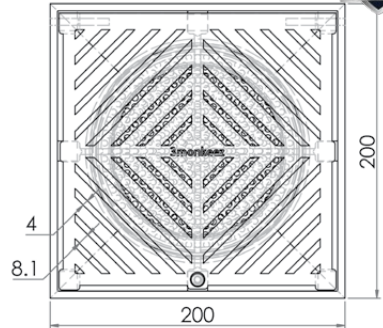

Front

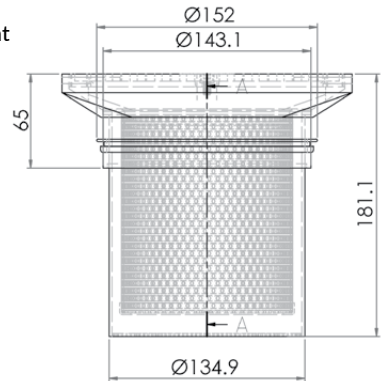

Cross Section

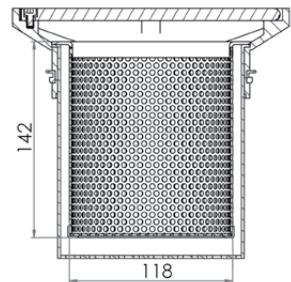

## 225mm Square Floor Waste Arrestor (suits 100mm pipe)



**FW-225BS-304**

**FW-225BS-316**

- Hinged grate
- Heel proof
- Fixed strainer with 4mm holes
- Removable basket with 4mm holes
- 304 or 316 grade stainless steel
- Suits 100mm DWV, HDPE pipe

Top

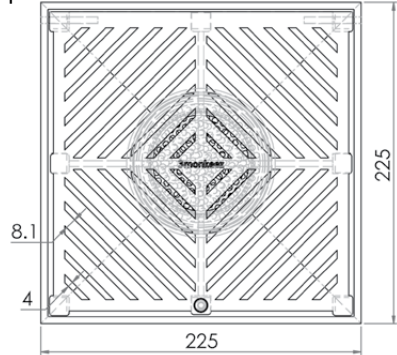

Front

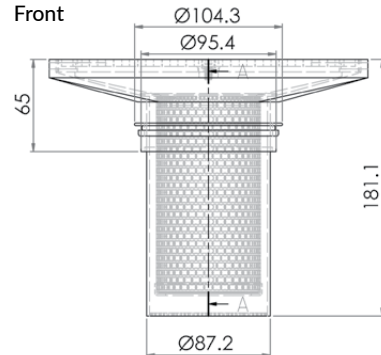

Cross Section

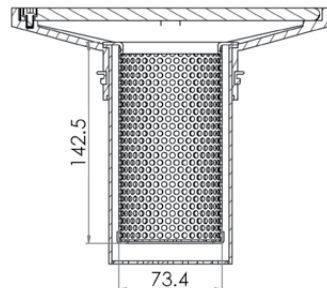

FW-BASKET-100



## 225mm Square Floor Waste Arrestor (suits 150mm pipe)



FW-225BS-150-304

FW-225BS-150-316

- Hinged grate
- Heel proof
- Fixed strainer with 4mm holes
- Removable basket with 4mm holes
- 304 or 316 grade stainless steel
- Suits 150mm DWV, HDPE pipe

Top

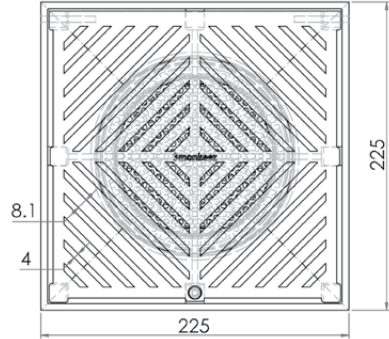

Front

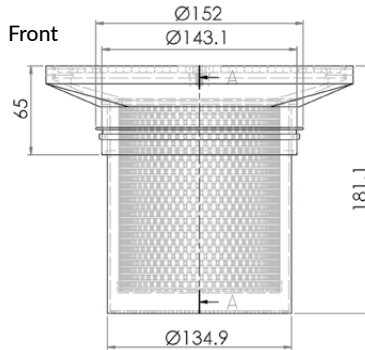

Cross Section

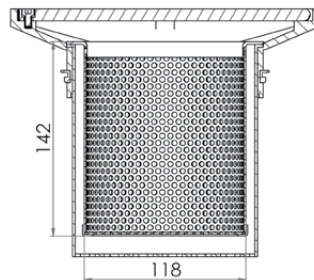

FW-BASKET-150

## 250mm Square Floor Waste Arrestor (suits 100mm pipe)



**FW-250BS-304**

**FW-250BS-316**

- Hinged grate
- Heel proof
- Fixed strainer with 4mm holes
- Removable basket with 4mm holes
- 304 or 316 grade stainless steel
- Suits 100mm DWV, HDPE pipe



FW-BASKET-100

Top

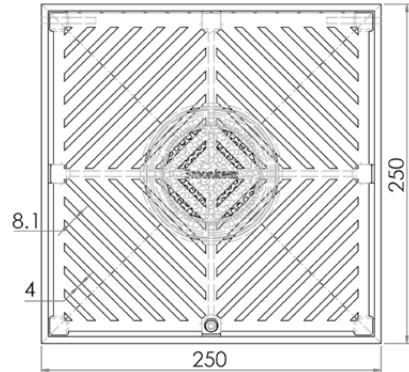

Front

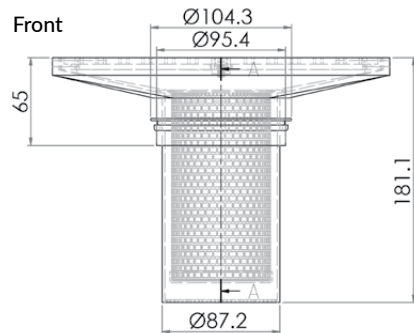

Cross Section

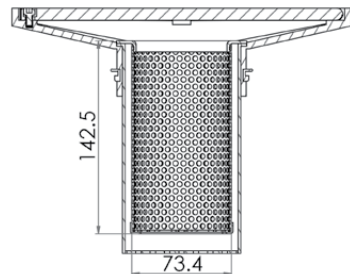

## 250mm Square Floor Waste Arrestor (suits 150mm pipe)



**FW-250BS-150-304**

**FW-250BS-150-316**

- Hinged grate
- Heel proof
- Fixed strainer with 4mm holes
- Removable basket with 4mm holes
- 304 or 316 grade stainless steel
- Suits 150mm DWV, HDPE pipe

Top

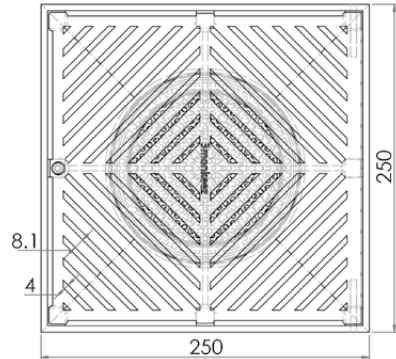

Front

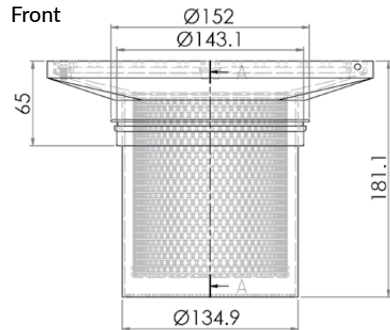

Cross Section

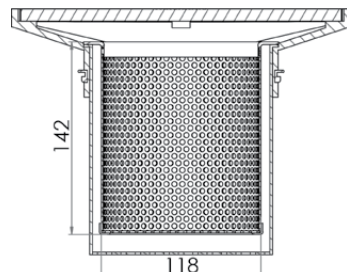

FW-BASKET-150

## 300mm Square Floor Waste Arrestor (suits 100mm pipe)



**FW-300BS-304**

**FW-300BS-316**

- Hinged grate
- Heel proof
- Fixed strainer with 4mm holes
- Removable basket with 4mm holes
- 304 or 316 grade stainless steel
- Suits 100mm DWV, HDPE pipe

Top

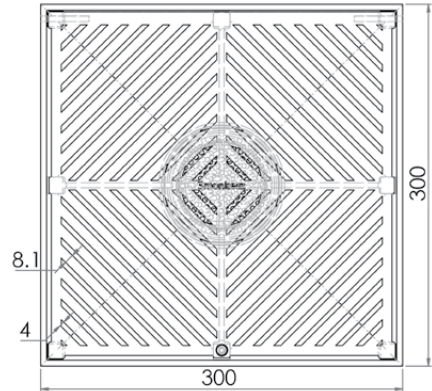

Front

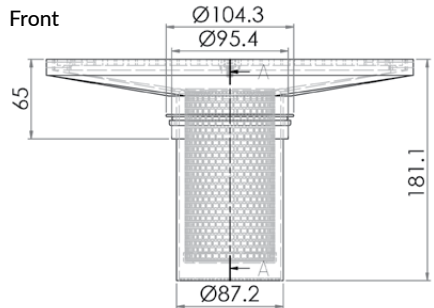

Cross Section

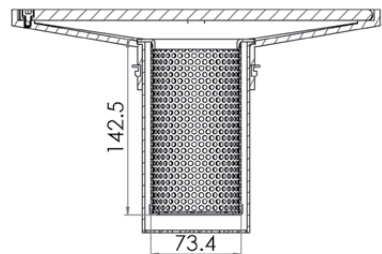

FW-BASKET-100

# Trade Waste Solutions



## 300mm Square Floor Waste Arrestor (suits 150mm pipe)



**FW-300BS-150-304**

**FW-300BS-150-316**

- Heel proof
- Hinged grate
- Fixed strainer with 4mm holes
- Removable basket with 4mm holes
- 304 or 316 grade stainless steel
- Suits 150mm DWV, HDPE pipe



FW-BASKET-150

Top

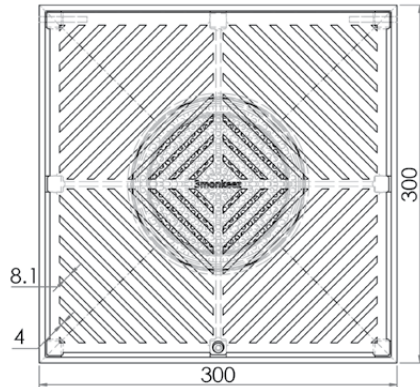

Front

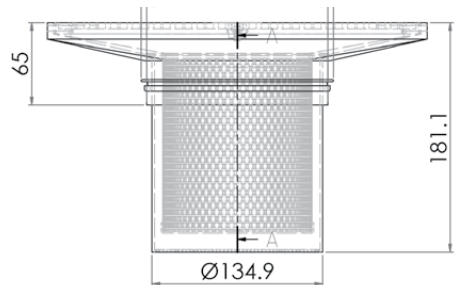

Cross Section

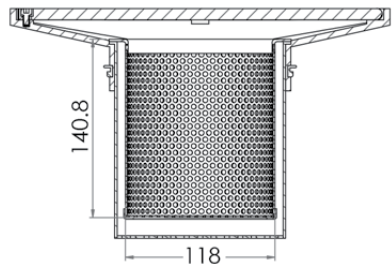

## 150mm Round Vinyl Floor Waste Arrestor (suits 100mm pipe)

**FW-100VRBT-304**

**FW-100VRBT-316**

- Removable grate
- Heel proof
- Suits vinyl application
- Includes vinyl clamp
- Fixed strainer with 4mm holes
- Removable basket with 4mm holes
- 304 or 316 grade stainless steel
- Suits 100mm DWV, HDPE pipe

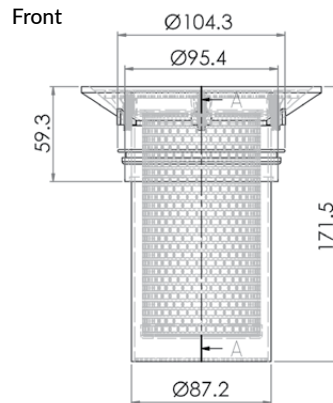
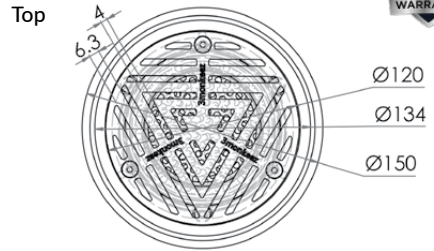

### Cross Section

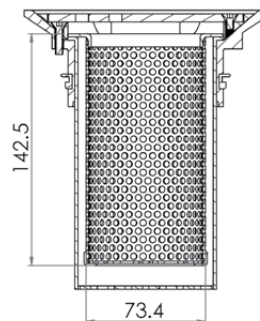

FW-BASKET-100

## 200mm Round Vinyl Floor Waste Arrestor (suits 150mm pipe)



**FW-200VRBT-150-304**

**FW-200VRBT-150-316**

- Removable grate
- Heel proof
- Suits vinyl application
- Includes vinyl clamp
- Fixed strainer with 4mm holes
- Removable basket with 4mm holes
- 304 or 316 grade stainless steel
- Suits 150mm DWV, HDPE pipe

Top

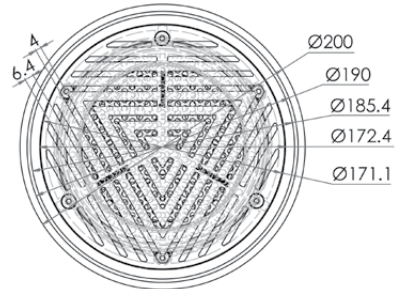

Front

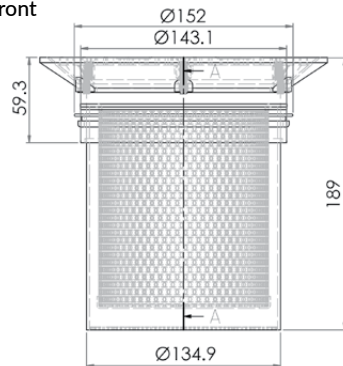

Cross Section

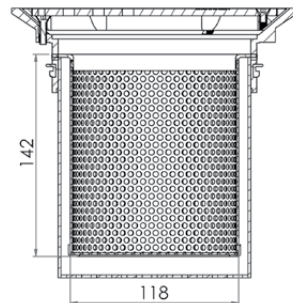

FW-BASKET-150

# Trade Waste Solutions

## Vertical Variable Height Main Body (suits 100mm pipe)



### FW-100VL

- Cast iron body
- Suits 100mm DWV, HDPE pipe



- Compatible with the below list of Floor wastes that suits a 100mm pipe

FW-100RL-304
FW-150R-304
FW-150S-304
FW-200S-304
FW-225S-304
FW-250S-304
FW-300S-304
FW-100VRT-304

\*Above codes also available in 316 grade

Top

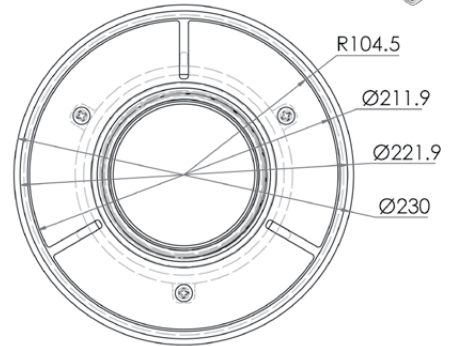

Front

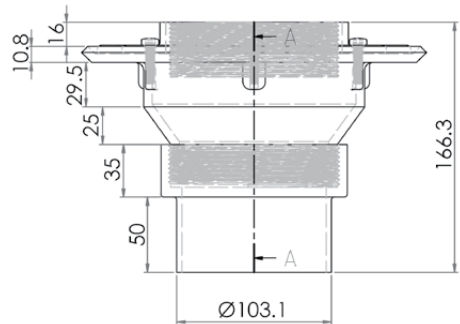

Cross Section

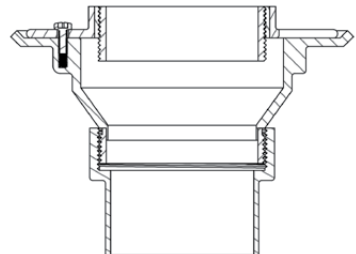



# Trade Waste Solutions

## Vertical Variable Height Main Body (suits 150mm pipe)



### FW-150VL

- Cast iron body
- Suits 150mm DWV, HDPE pipe



- Compatible with the below list of Floor wastes that suits a 100mm pipe

FW-200S-150-304
FW-225S-150-304
FW-250S-150-304
FW-300S-150-304
FW-200VRT-150-304

\*Above codes also available in 316 grade

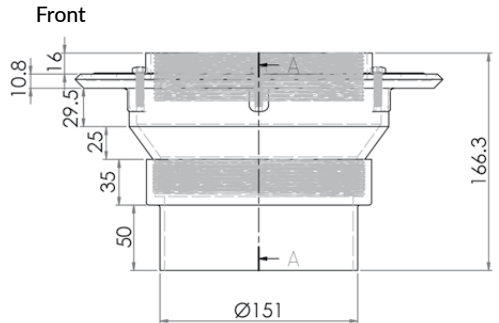
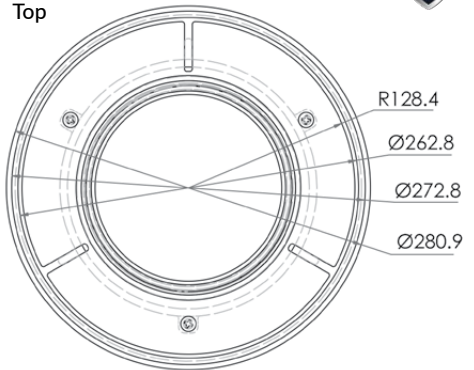

### Cross Section

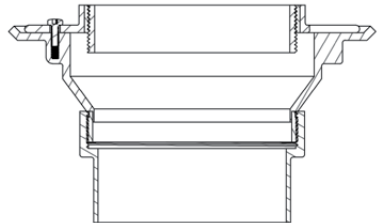

# Trade Waste Solutions



## Clay / Plaster Arrestors



- Manufactured from high quality 1.2mm 304 or 316 grade stainless steel
- Typically used in schools, art studios, medical and educational facilities
- Removable filter baskets and lids
- Off the shelf and custom made available



Dental/Medical

Art Studios

Education



[3monkeez.com.au](http://3monkeez.com.au)

# Trade Waste Solutions



## Clay / Plaster Arrestor

### AB-CA-3

- Manufactured with 1.2mm 304 grade stainless steel
- 50mm BSP inlet and outlet
- Typically used in schools, art studios, medical and education facilities
- 58.5L capacity
- Removable filter baskets
- Removable lid
- Off the shelf available for immediate delivery



Top

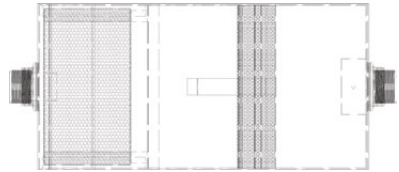

Front

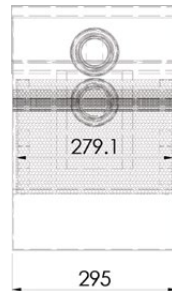

Side

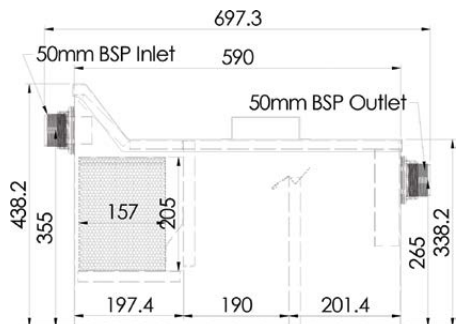

# Trade Waste Solutions



## Clay Arrestor

### M-CA-3

- Manufactured from high quality 1.2mm 304 or 316 grade stainless steel
- 50mm BSP inlet and outlet
- Typically used in schools, art studios, medical and educational facilities
- 67L capacity
- Removable filter baskets
- Removable lid
- Custom made products incur a lead time



Top

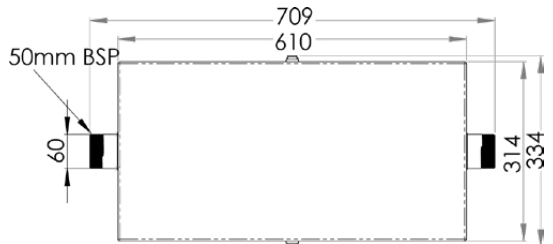

Front

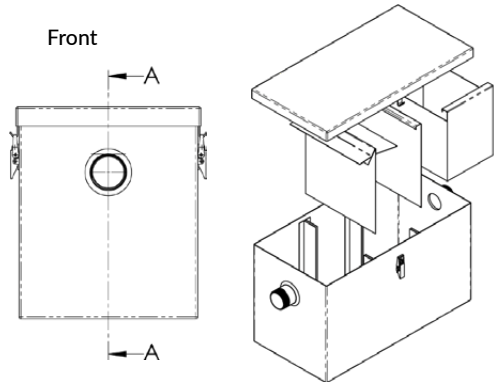

Cross Section

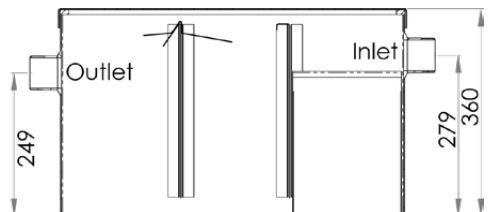

# Trade Waste Solutions



## Plaster Arrestor



### M-PL-3

- Manufactured from high quality 1.2mm 304 or 316 grade stainless steel
- 50mm BSP inlet and outlet
- Typically used in schools, art studios, medical and educational facilities
- 53L capacity
- Removable baffles
- Removable lid
- Custom made products incur a lead time

Top

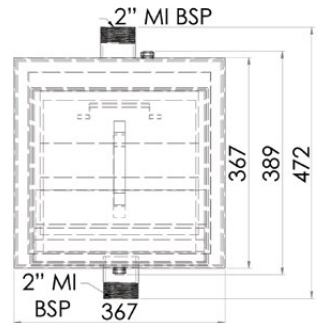

Front

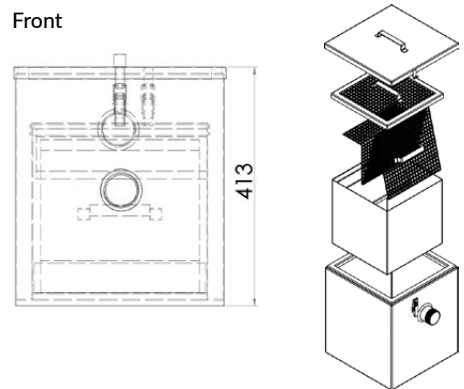

Side

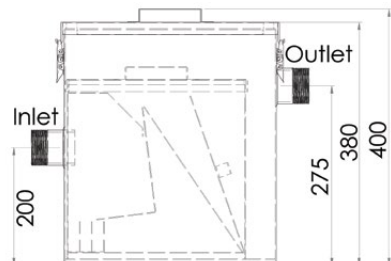

# Trade Waste Solutions



## Tundish

### CS-TUND

- 304 grade stainless steel
- Clear perspex front for easy inspection
- Easily removed face plate
- Pre-drilled fixing wings
- Available off the shelf
- Other sizes and styles available on request



CS-TFP - Replacement Front plate available

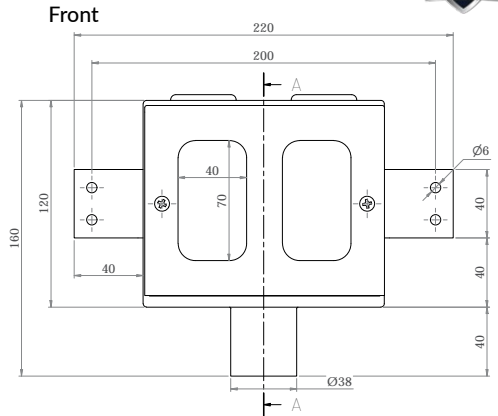

### Top

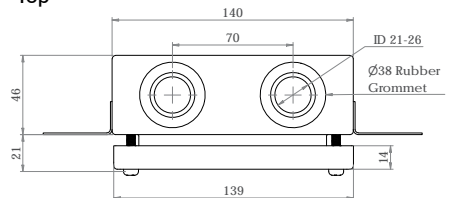

### Cross Section

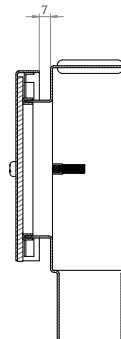

# Trade Waste Solutions



## Tundish with Extended Front Sleeve

### CS-TUND-M

- 304 grade stainless steel
- Clear perspex front for easy inspection
- Easily removed face plate
- Extended sleeve allows face plate to extend outward up to 40mm
- Pre-drilled fixing wings
- Custom made products incur a lead time



CS-TFP - Replacement Front plate available

Front

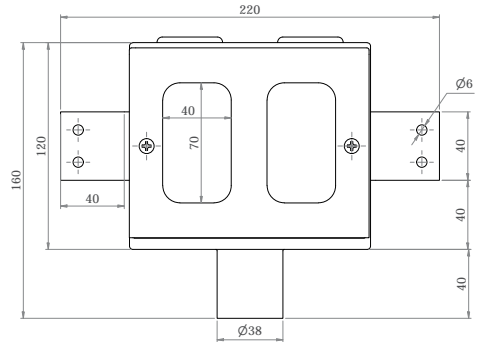

Top

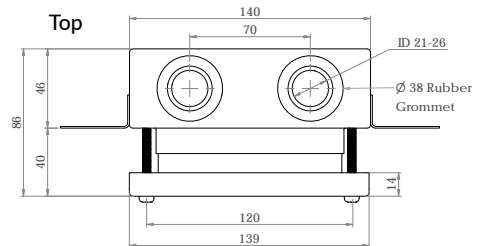

Cross Section

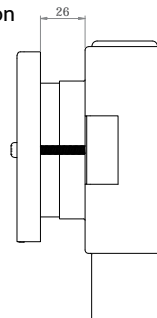

# Stainless steel floor waste solutions

Looks good now, looks good for life!



## Setting the right trap.



- Floor Waste Arrestors Square and Round
- Floor Wastes Square and Round
- Vinyl Floor Wastes
- Clear Outs



### Outdoors



### Bars/Restaurants



### Commercial Kitchens







NSW 02 9627 6111

VIC 03 9357 6562

QLD 07 3881 0322

WA 08 6305 0681

SA 0408 299 443

ACT 0408 446 961

TAS 03 6344 7060

NT 0447 382 658

FNQ 07 4775 6956

**3monkeez**

[www.3monkeez.com.au](http://www.3monkeez.com.au)

[sales@3monkeez.com.au](mailto:sales@3monkeez.com.au)