

SWEDIA®

PROFESSIONAL STAINLESS STEEL KITCHENWARE



SWEDIA Stainless Steel

the hygienic choice

Sanitary

grade stainless steel is internally smooth to resist debris buildup, and is 100% lead (Pb) free

Precision

engineered for enhanced reliability

Technology

delivers flow and temperature control from the latest ceramic cartridges

Perfection

from hand-finished surfaces and intense quality checks

Quality

components such as Swiss Neoperl aerator to ensure consistent water flow

Eco-friendly

by avoiding the harsh chroming process typical for brass tapware

Stainless Steel is demanded in premium and commercial kitchens for its aesthetic appeal, superior hygienic and sanitary properties, and high resistance to corrosion.

Family health: Unlike brass taps, stainless steel contains no lead (Pb).

Hygienic Water: Stainless Steel is non-porous so a highly sanitary metal - no debris buildup inside.

Temperature Tolerance: Stainless steel can tolerate much higher temperatures than other metals.

Outdoors proof: Premium stainless steels boast natural anti-corrosion and anti-oxidation properties.

Long-life Finish: No coating that can peel or scratch off - and it can be brushed or polished.

Eco-friendly: The harsh chroming process is avoided - a big positive for the environment.

Not all stainless steel kitchenware is high quality. Swedia balances the brightness, hardness and anti-corrosiveness qualities of stainless steel and spectrometer tests all raw materials for purity. Swedia only partners with the World's best manufacturers of materials and components.

SWEDIA
specialises in
professional grade
stainless steel
kitchen tapware
and sinks.



stainless steel tapware



*architectural designer tapware
to perfect your kitchen*

*solid stainless steel for durability
and outdoor installation*

*highly sanitary surfaces -
lead (Pb) and chrome free*



SWEDIA

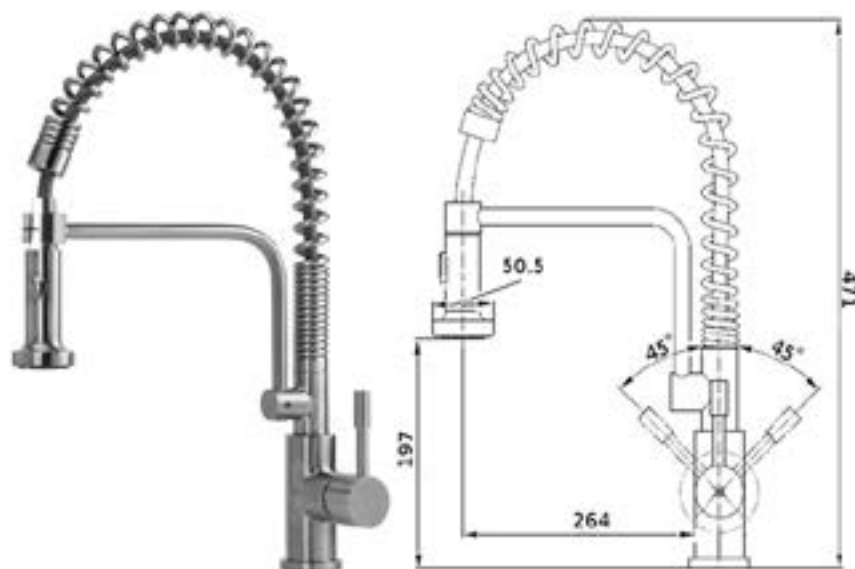

SIGNATÜR

Spring goose neck with pull-out hose and dual spray

Finish: Brushed Satin or Polished
Spout: 360° swivel spring goose neck
Flow: Fitted with 4 star Wels rated flow restrictor (7.5 lpm)
Nozzle: Pull-out retractable hose. Dual spray switch for aerator and shower

KLAAS

Traditional goose neck with optional pull-out hose

Finish: Brushed Satin or Polished
Spout: 360° swivel goose neck
Flow: Fitted with 4 star Wels rated flow restrictor (7.5 lpm)
Nozzle: Optional discrete pull-out retractable hose. Neoperl aerator.

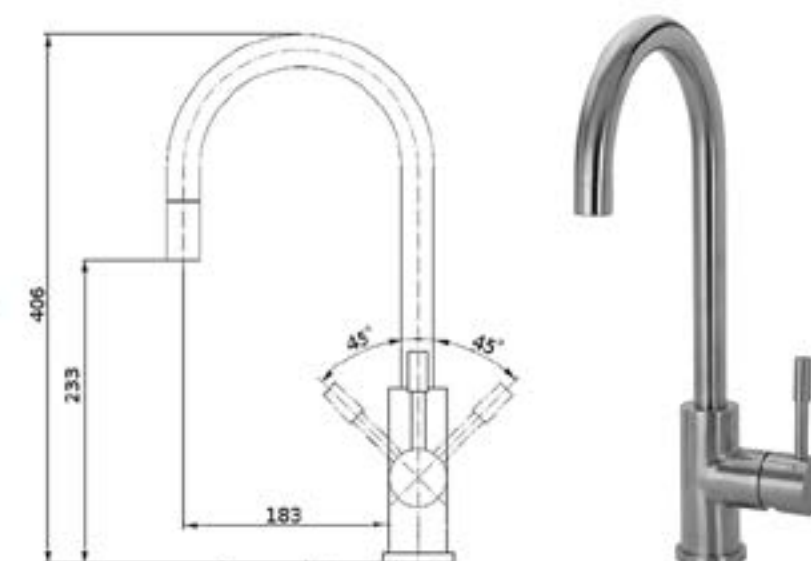

PRIMA

Spring goose neck with flexi-hose and dual spray

Finish: Brushed Satin or Polished
Spout: 360° swivel spring goose neck
Flow: Fitted with 4 star Wels rated flow restrictor (7.5 lpm)
Nozzle: Flexi-hose. Dual spray switch for aerator and shower

OTTO

Traditional goose neck with filtered water outlet

Finish: Brushed Satin or Polished
Spout: 360° swivel goose neck
Flow: Fitted with 4 star Wels rated flow restrictor (7.5 lpm)
Nozzle: Neoperl aerator. Separate discrete outlet for drinking water
Filter: Separate input for filtered water with independent flow control

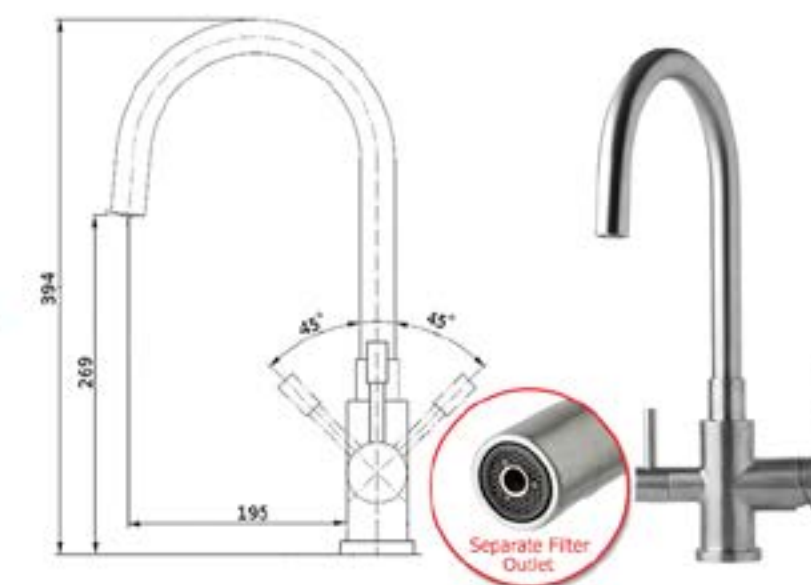

OPTIMUS

Spring goose neck with flexi-hose, dual spray & pot filler

Finish: Brushed Satin or Polished
Spout: 360° swivel spring goose neck
Flow: Fitted with 4 star Wels rated flow restrictor (7.5 lpm)
Nozzle: Flexi-hose. Dual spray switch for aerator and shower
Filler: Independent swivel arm with flow control

OSKAR

Low height spout with optional pull-out hose

Finish: Brushed Satin & Polished
Swivel: 360° swivel low height spout
Flow: Fitted with 4 star Wels rated flow restrictor (7.5 lpm)
Nozzle: Optional discrete pull-out retractable hose. Neoperl aerator.

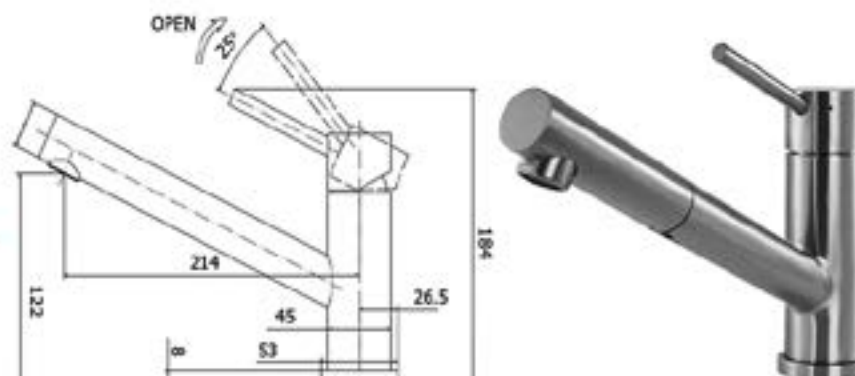

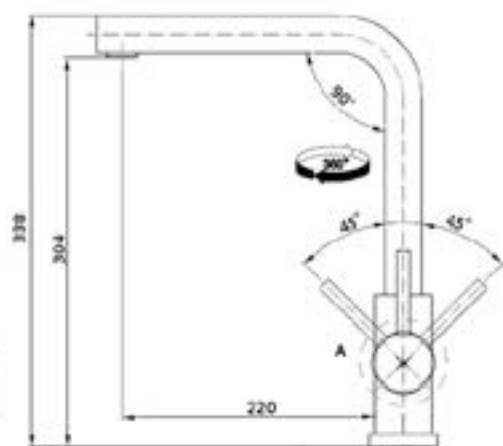

KLARA

Contemporary mixer
Rounded right angle neck

Finish: Brushed Satin or Polished
Spout: 360° swivel
Flow: Fitted with 4 star Wels rated
flow restrictor (7.5 lpm)
Nozzle: Neoperl aerator

ISAK

Contemporary mixer
Rounded double square neck

Finish: Brushed Satin or Polished
Swivel: 360° swivel
Flow: Fitted with 4 star Wels rated
flow restrictor (7.5 lpm)
Nozzle: Neoperl aerator

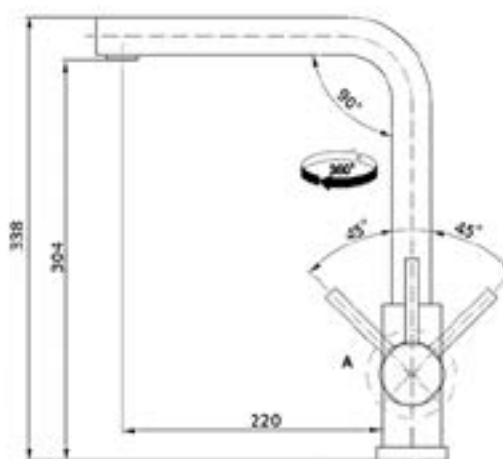
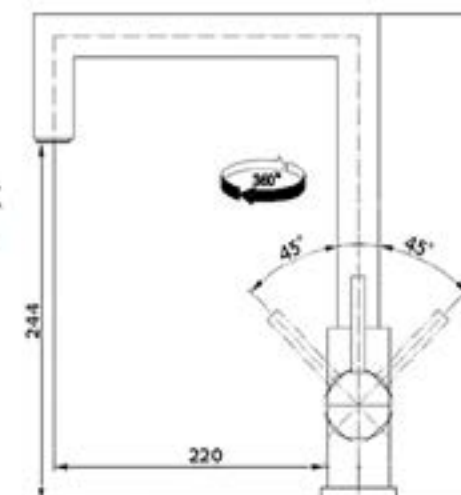

CUBEX

Contemporary mixer
Chisel edge right angle neck

Finish: Brushed Satin or Polished
Spout: 360° swivel
Flow: Fitted with 4 star Wels rated
flow restrictor (7.5 lpm)
Nozzle: Neoperl aerator

GRETAL

Traditional goose neck
with tapered base

Finish: Brushed Satin or Polished
Swivel: 360° swivel
Flow: Fitted with 4 star Wels rated
flow restrictor (7.5 lpm)
Nozzle: Neoperl aerator

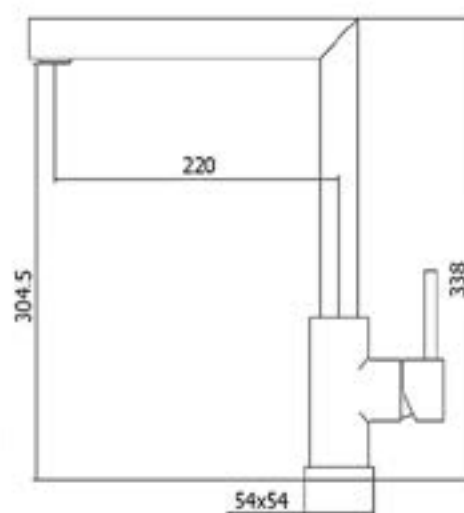
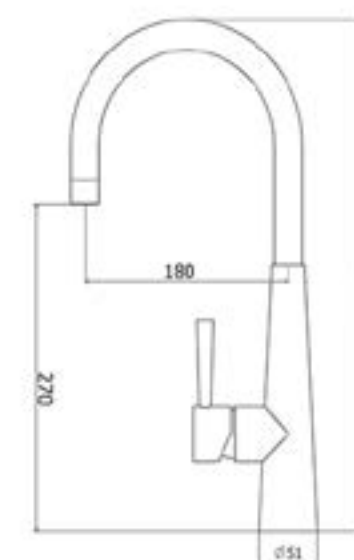

ISAR

Contemporary mixer
Rounded square neck

Finish: Brushed Satin or Polished
Spout: 360° swivel
Flow: Fitted with 4 star Wels rated
flow restrictor (7.5 lpm)
Nozzle: Neoperl aerator

GOSTA

Spring goose neck with
detachable flexi hose

Finish: Brushed Satin or Polished
Swivel: 360° swivel with detachable flexi-hose
Flow: Fitted with 4 star Wels rated
flow restrictor (7.5 lpm)
Nozzle: Neoperl aerator

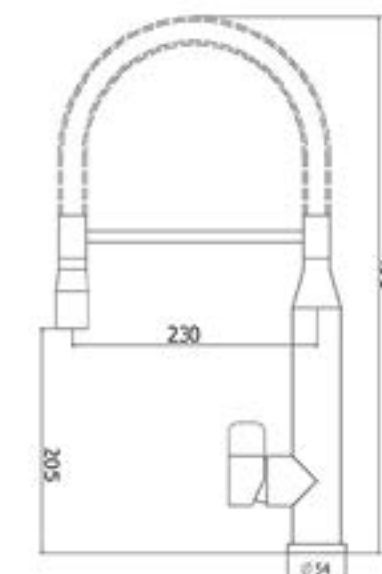



stainless steel sinkware



Durable

heaviest grade available
1.5mm (16 gauge)
304 stainless steel

Precision
hand-fabricated
for true 90° corners

Practical

soft square
internal corners
for easy
cleaning

Protected

under-side
anti-condensation
coating to
protect cabinetry

1.5MM THICK
304 SS



Quiet

under-side premium baffle
pads to deaden sounds





DANTE | Single Bowl - 450mm wide

Material: 1.5mm (16 gauge) 304 Grade Stainless Steel
 Finish: Brushed Satin
 Capacity: 33 litres
 Dimensions: 450mm x 450mm x 205mm (W x L x D)
 Installation: Topmount or Undermount

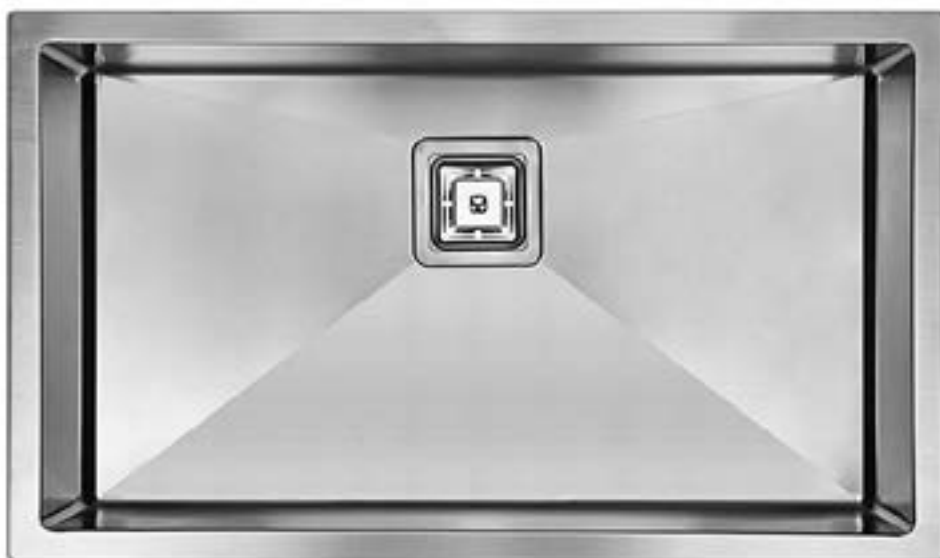

DANTE | Large Single Bowl - 760mm wide

Material: 1.5mm (16 gauge) 304 Grade Stainless Steel
 Finish: Brushed Satin
 Capacity: 58 litres
 Dimensions: 450mm x 760mm x 205mm (W x L x D)
 Installation: Topmount or Undermount

ACCESSORIES AVAILABLE



COLANDER



CHOPPING BOARD

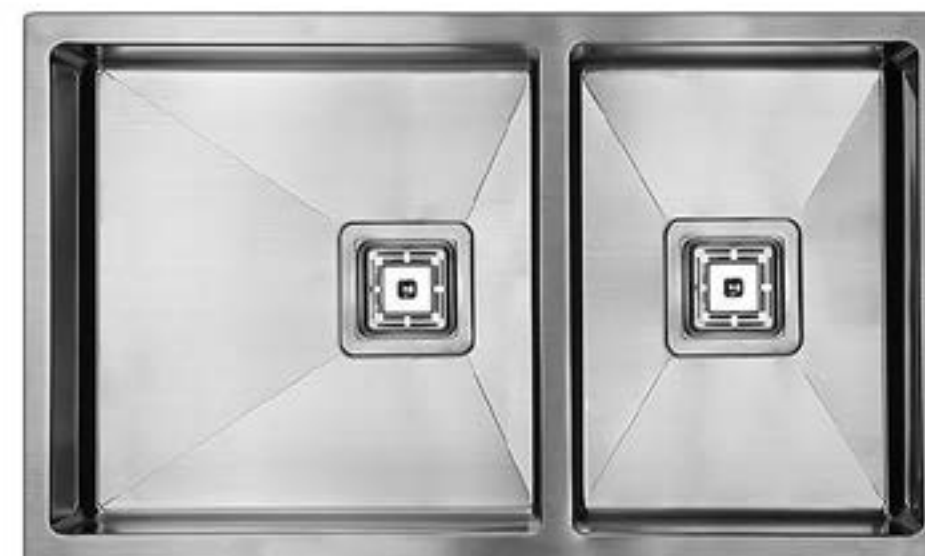

DANTE | 1 + 3/4 Bowl - 760mm wide

Material: 1.5mm (16 gauge) 304 Grade Stainless Steel
 Finish: Brushed Satin
 Capacity: 33 litres and 23 litres
 Dimensions: 450mm x 760mm x 205mm (W x L x D)
 Installation: Topmount or Undermount



DANTE | Double Bowl - 800mm wide

Material: 1.5mm (16 gauge) 304 Grade Stainless Steel
 Finish: Brushed Satin
 Capacity: 2 x 30 litres
 Dimensions: 450mm x 800mm x 205mm (W x L x D)
 Installation: Topmount or Undermount

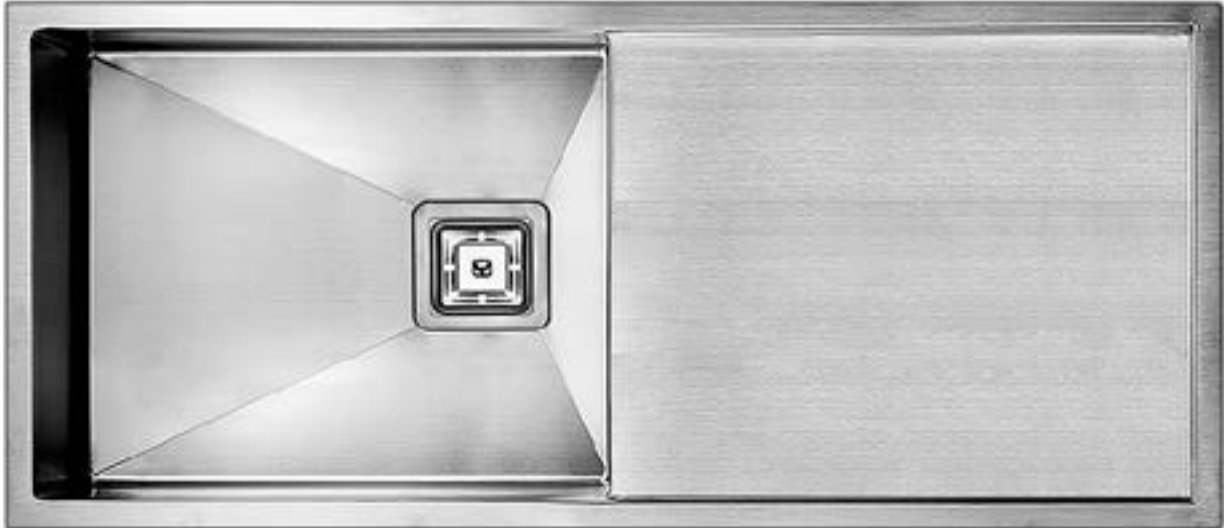

DROMMA | Single Bowl with Drainer - 1000mm wide

Material: 1.5mm (16 gauge) 304 Grade Stainless Steel
Finish: Brushed Satin
Capacity: 42 litres
Dimensions: 450mm x 1000mm x 205mm (W x L x D)
Installation: Undermount recommended

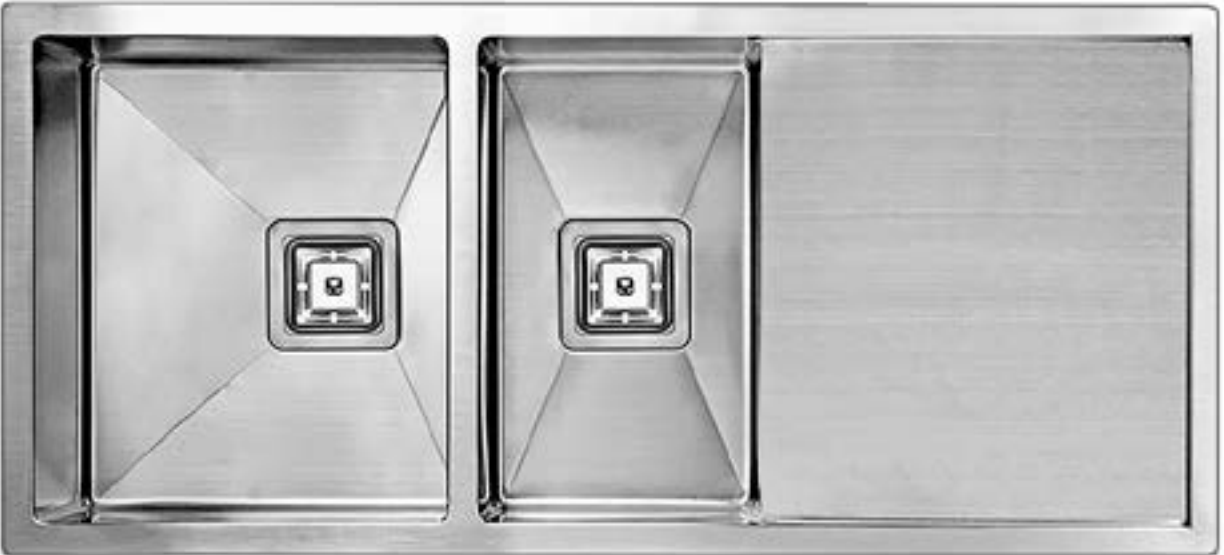

DROMMA | 60:40 Bowl with Drainer - 1000mm wide

Material: 1.5mm (16 gauge) 304 Grade Stainless Steel
Finish: Brushed Satin
Capacity: 30 litres and 21 litres
Dimensions: 450mm x 1000mm x 220mm (W x L x D)
Installation: Undermount recommended

ACCESSORIES AVAILABLE



COLANDER



CHOPPING BOARD



INCLUDES ACCESSORIES



Integrated knife block



Integrated soap dispenser

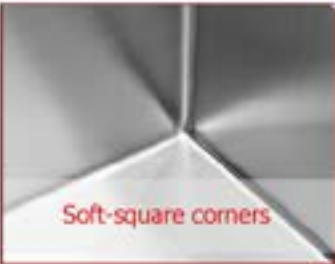

Soft-square corners

KIKKI | 60:40 Bowl with Tap hole, Knife Block & Soap Dispenser

Material: 1.5mm (16 gauge) 304 Grade Stainless Steel
Finish: Brushed Satin
Capacity: 35 litres and 23 litres
Dimensions: 480mm x 820mm x 220mm (W x L x D)
Installation: Undermount recommended
Tap hole: Standard Ø 35mm
Integrations: Knife block (self draining), Soap dispenser
Accessories: Stainless Steel Colander and Cutting Board included



Integrates with
Dante and
Dromma ranges

ACCESSORIES | Dante / Dromma Sink

CHOPPING BOARD

Timber: Sapele
Preparation: Oiled
Length: 425mm
Width: 250mm

COLANDER

Material: 304 Stainless Steel
Dimensions: 432mm (L) x 188mm (W) x 147mm (D)



FELIX Stainless Steel Soap Dispenser

Sanitary Grade 304 Stainless Steel
Canister Size: 250ml
Spout Length: 80mm
Above bench Height: 65mm
Below Bench Height: 210mm
Diameter of Cut-Out: 25mm



NEO Stainless Steel Soap Dispenser

Sanitary Grade 304 Stainless Steel
Canister Size: 250ml
Spout Length: 78mm
Above bench Height: 65mm
Below Bench Height: 210mm
Diameter of Cut-Out: 25mm



Professional
Stainless Steel
Taps and Sinks



BOLD.

architectural designs
that impress

Swedia® is a 100% Australian group specialising in architectural stainless steel kitchenware. Created with select European design houses and manufactured specifically to meet the strict Australian and New Zealand requirements and standards.

Swedia® provides the Australian and New Zealand markets with a new premium choice in kitchen tapware and sinks. Bold designs that combine clean simplicity, beauty and functionality.

Swedia has partnered with a combination of specialist European manufacturers and premium quality rated factories and component suppliers to produce their professional tapware and sinks:

- Swiss stainless steel tapware engineers and designers
- Leading ceramic cartridges for precision water control
- Spanish input hoses made for Australia's Watermark requirements
- German specialist anti-fray hoses designed to last
- Swiss aerators and nozzles for perfect water flow
- Master steel finishers and welders to hand finish all surfaces

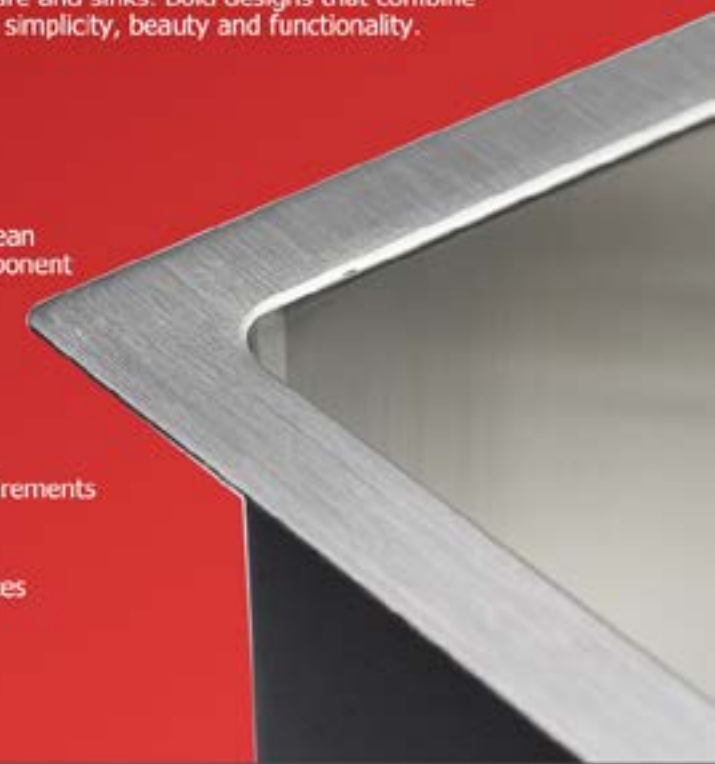

World Leading
Stainless Steel
Kitchenware

made specifically for

Australia and
New Zealand



Professional
Stainless Steel
Taps and Sinks

SWEDIA.com.au
service@swedia.com.au
(03) 88 444 899

